





# INSTALLATION INSTRUCTIONS

Exhaust Manifold

46-40174

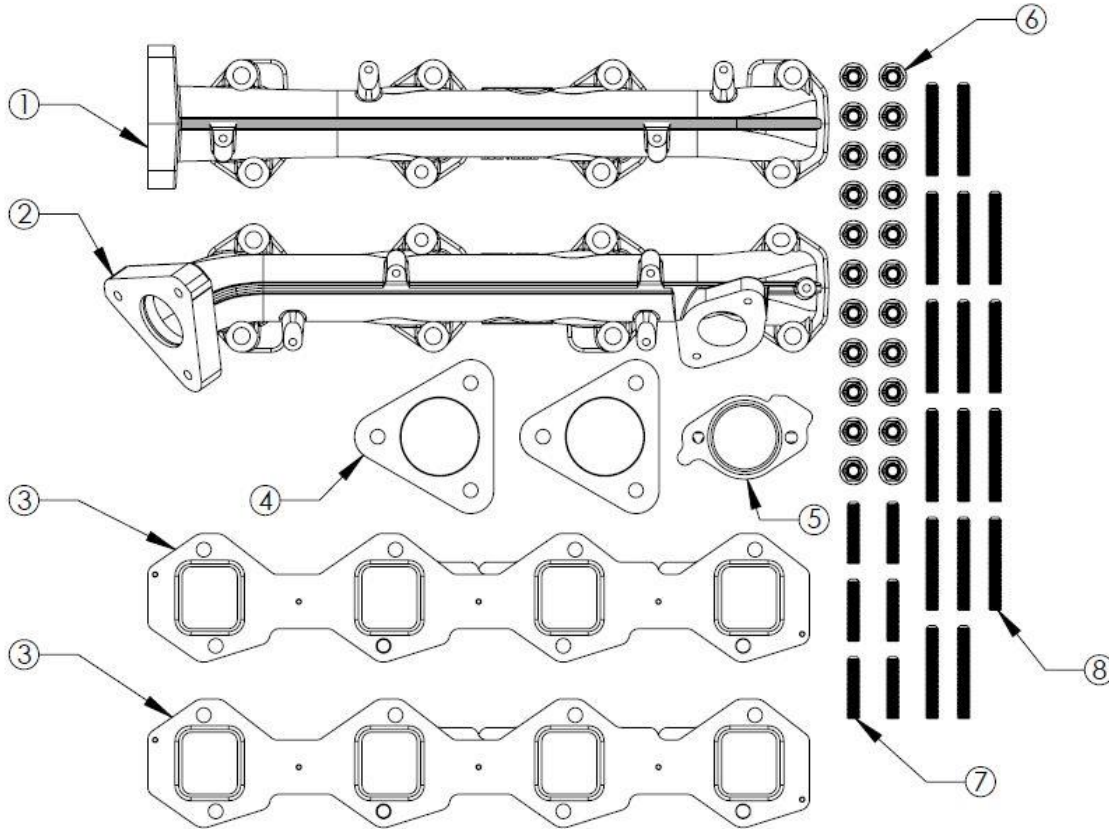
MAKE: Ford  
 MODEL: F250/F350  
 YEAR: 2011-2014  
 ENGINE: V8-6.7L(td)





**EMISSIONS DISCLAIMER**

This product is not currently CARB exempt and is not available for purchase in California or for use on any vehicle registered with the California Department of Motor Vehicles.

Item	Description	Part Number	Quantity
1	Manifold, Left	05-61576	1
2	Manifold, Right	05-61577	1
3	Gasket, Exh. Man Set	05-61752	1
4	Gasket, Exh. Man Outlet	05-61753	2
5	Gasket, Exh. to EGR	05-61754	1
6	Nut M8x1.25	03-50903	22
7	Stud: M8 x 1.25 x 40mm	03-50904	6
8	Stud: M8 x 1.25 x 60mm	03-50905	16

**aFe POWER recommends professional installation on this product.** Thoroughly inspect the aFe POWER exhaust system to make sure there is no damage from shipping (if damage is noted, immediately contact aFe POWER customer service). Allow time for your vehicle to cool down prior to installation. When working on your vehicle proceed with caution. Wear protective safety equipment; eye goggles and gloves to ensure a safe installation.



## INSTALLATION INSTRUCTIONS

Exhaust Manifold

**MAKE:** Ford  
**MODEL:** F250/F350  
**YEAR:** 2011-2014  
**ENGINE:** V8-6.7L(td)

46-40174

1. **(Read instructions prior to installation.)**
2. Remove all OEM studs and clean cylinder heads prior to installation.
3. Install the 40mm Studs onto the rear of the manifolds.
4. Install the 60mm studs onto the cylinder heads.
5. Install the supplied gaskets
6. Torque the manifolds in three stages, starting from the center and moving to the outside.
  - a. Stage 1: 13 Ft-lbs
  - b. Stage 2: 18 Ft-Lbs
  - c. Stage 3: Repeat, 18 Ft-Lbs
7. The factory heat shields can be installed on the aFe POWER manifolds
8. Install the Turbocharger – Refer to the OEM specs..
9. Install the up-pipes to the manifolds, with the supplied gaskets and torque to 15 Ft-Lbs
10. When installing the EGR Feed tube use the supplied gasket and torque to 90 in-lbs

