

***advanced FLOW engineering***

Cold Air Intake System

**Instruction Manual** P/N: 56-70071D / 56-70071R

Make: MAZDA

Model: CX-50

Year: 2023-2025

Engine: L4-2.5L (t)



- Please read the entire instruction manual before proceeding.
- Ensure all components listed are present.
- If you are missing any of the components, call customer support at 951-493-7185.
- Ensure you have all necessary tools before proceeding.
- Do not attempt to work on your vehicle when the engine is hot.
- Retain factory parts for future use.

Label	Qty.	Description	Part Number
A	1	Air Filter (Pro DRY S) For 56-70071D	21-91122
A	1	Air Filter (Pro 5R) For 56-70071R	24-91122
B	1	Tube	05-5670045B1
C	1	Housing	05-5670071B2
D	1	Clamp, 048 (2-9/16" – 3-1/2")	03-50007
E	1	Clamp, 044 (2-5/16" – 3-1/4")	03-50019
F	2	Screw, Torx: M4 x 8mm	03-50491
G	1	Plug, Housing	05-01527
H	1	Coupler, Silicone Reducer: (2.50" x 2.75")ID x 3"L	05-01710
J	1	Harness, Mazda MAF Extension: 6" 4-Wire	05-70049

**Installation will require the following tools:**

Socket Set, Torx Set, Extensions, Ratchet wrench, Pliers, Screwdriver Set, Trim Removal Tool

Warranty Information available at: <https://afepower.com/warranty>

**Emissions Disclaimer:** This product is not currently CARB exempt and is not available for purchase in California or for use on any vehicle registered with the California Department of Motor Vehicles. CARB exemption applications can take time to process, please contact us or visit our website for the latest updates on its status.

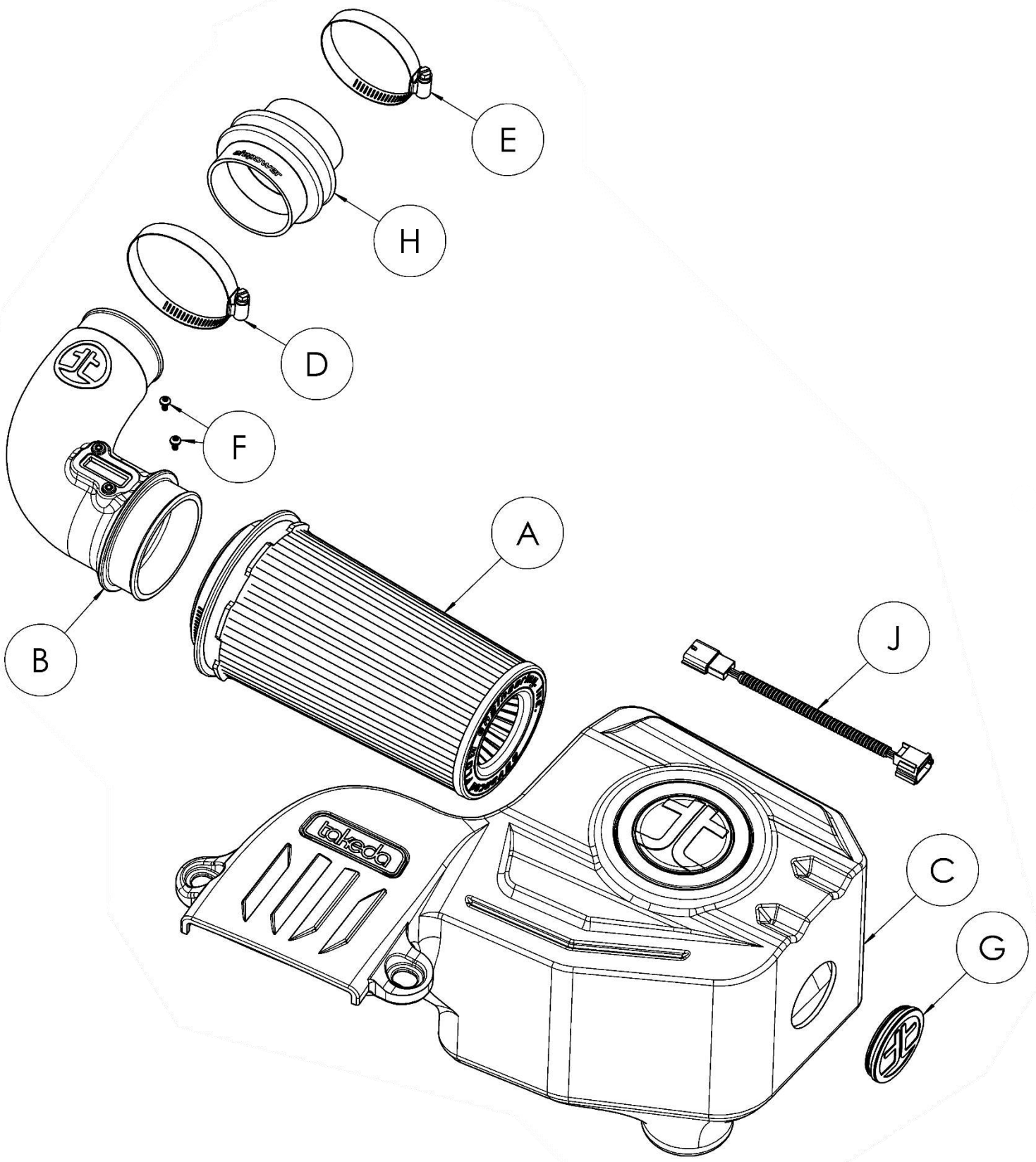



**Refer to Figure A for Steps 1-2**

Step 1: Use pliers to compress the bottom of the harness holder to unclip from mounting point.

Step 2: Press the release tab on the Mass Air Flow (MAF) sensor harness and disconnect it from the MAF sensor.

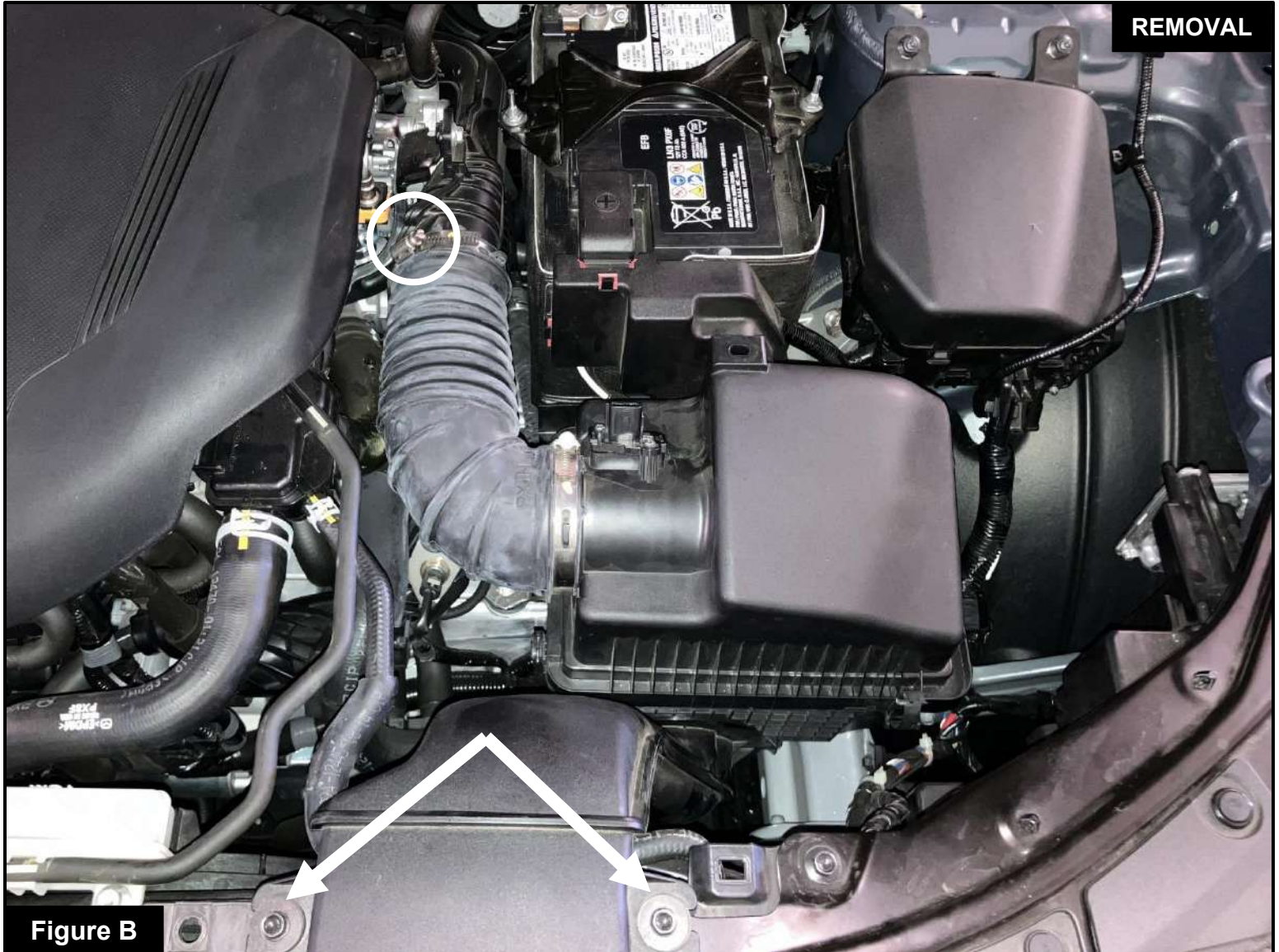

Figure B

**Refer to Figure B for Steps 3-4**

Step 3: Use a 7mm driver or ratchet wrench to loosen the hose clamp on the factory intake tube

Step 4: Use a 10mm driver or ratchet wrench to remove the (2) two screws that secure the factory housing.

Screws will be used later in the installation.



**Refer to Figure C for Step 5**

Step 5: Carefully remove the factory intake as one unit.



Figure D

**Refer to Figure D for Step 6**

Step 6: Use a Phillips screwdriver to remove the screws securing the Mass Air Flow (MAF) sensor to the factory housing.

Step 7: Transfer the Mass Air Flow (MAF) sensor to the **TAKEDA** tube and secure it using the two (2) supplied Torx M4 screws.

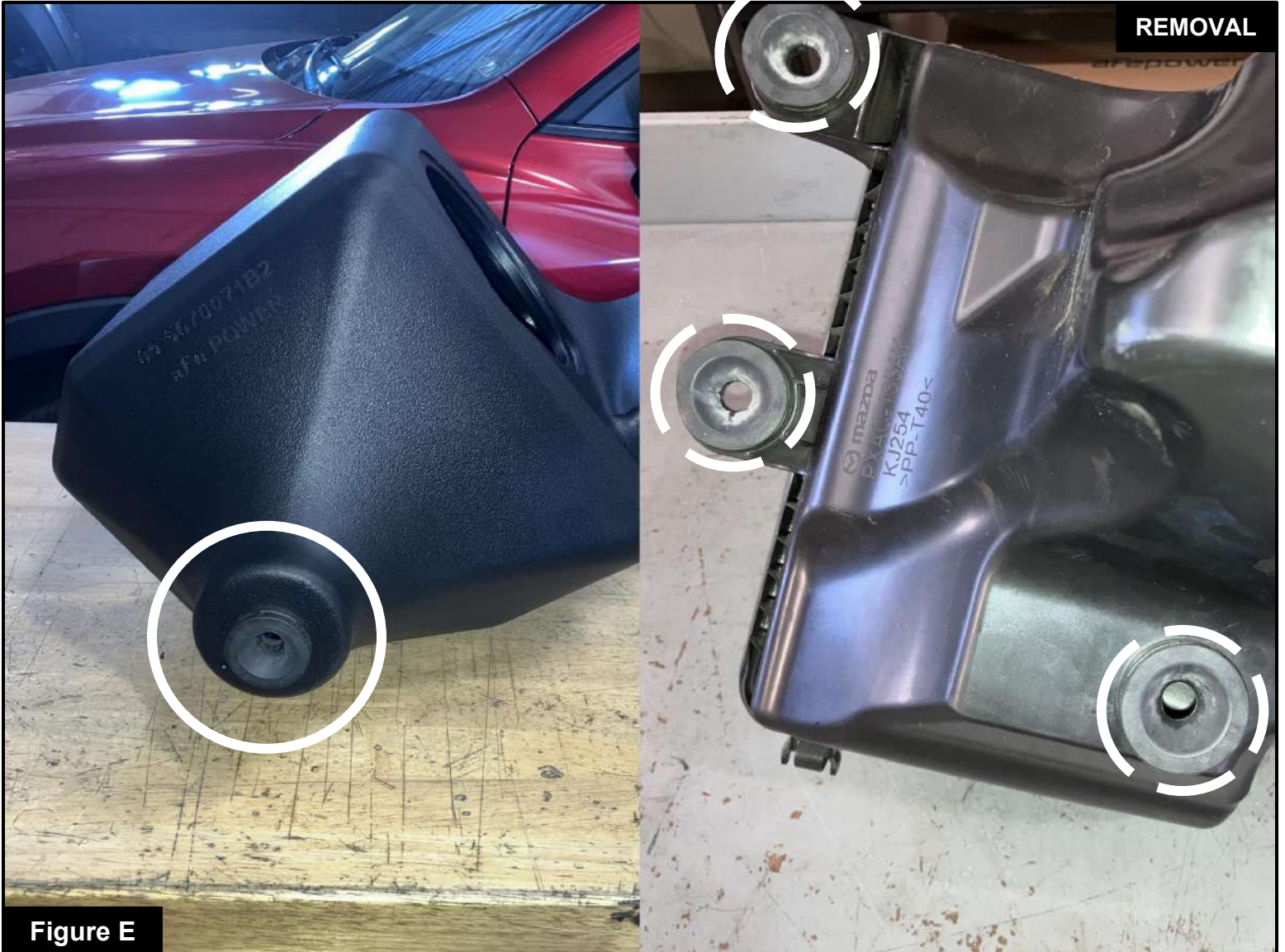

Figure E

**Refer to Figure E for Step 8**

Step 8: Transfer one (1) of the mounting grommets from the factory housing to the **TAKEDA** housing.



Figure F

**Refer to Figure F for Step 9**

Step 9: Transfer the two (2) factory grommets and steel inserts from the factory intake scoop to the **TAKEDA** housing.

**Figure G****Refer to Figure G for Step 10**

Step 10: Install the **aFe POWER** air filter into the **TAKEDA** housing by firmly pushing until the filter tabs lock it into place. Do not tighten hose clamp at this time.



Figure H

### Refer to Figure H for Steps 12-15

Step 12: Install the **TAKEDA** housing into the vehicle ensuring the bottom mounting stud snaps securely into the rubber grommet.

Step 13: Use a 10mm driver or ratchet wrench to install the (2) two screws removed in **STEP 4** in order to secure the **TAKEDA** housing.

Step 14: Install the **aFe POWER** coupler with the **#44** & **#48** hose clamps, ensure the small side and **#44** clamp is facing the turbo inlet.

Step 15: Use an 8mm driver or ratchet wrench to tighten the **#44** clamp. Do not tighten **#48** clamp at this time.

**Figure J****Refer to Figure J for Steps 16-17**

Step 16: Insert the **TAKEDA** tube into the filter first, then insert it to the **aFe POWER** coupler. Ensure everything is properly aligned.

Step 17: Use an **8mm** driver or ratchet wrench to tighten all clamps.

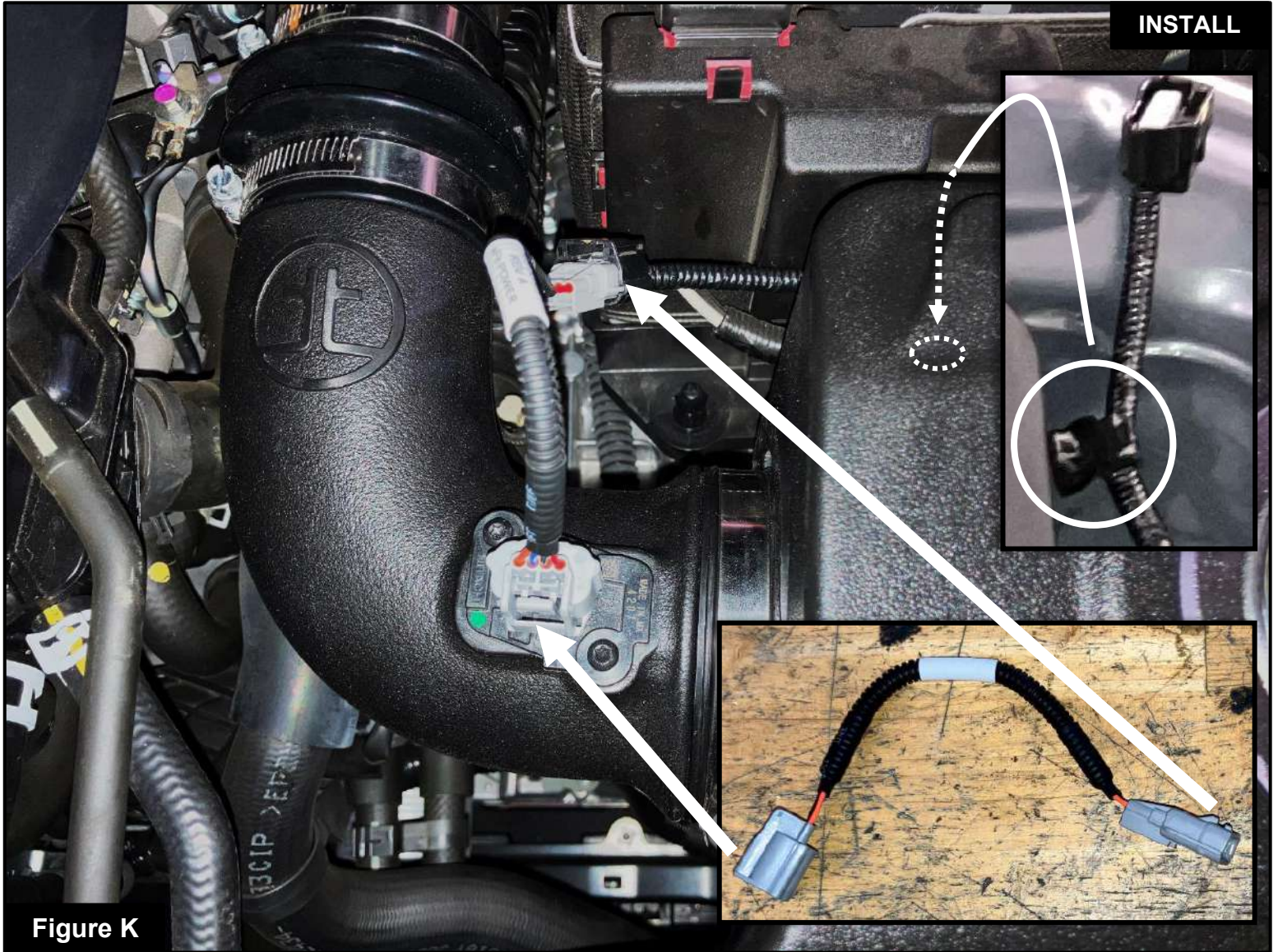

Figure K

**Refer to Figure K for Steps 18-19**

Step 18: Connect the Mass Air Flow (MAF) sensor **extension harness** to the factory harness and connect the other end to the Mass Air Flow (MAF) sensor.

Step 19: Clip the factory harness holder onto the back of the **TAKEDA** housing.



Figure L

### Refer to Figure L for Step 20

Step 20: Install the **TAKEDA** plug. The kit includes an optional plug to close off the auxiliary air inlet. •

- **Without the plug installed, the TAKEDA intake will capture the maximum amount of air available. More airflow can lead to increased power, but some of this air may come from inside the engine compartment and could be warmer, potentially affecting vehicle performance.**
- **Installing the plug on the housing will block out hot engine air, ensuring that only the coolest air is directed into the engine. This will also help reduce intake noise.**



**Your installation is now complete. Thank you for choosing TAKEDA USA!**

**NOTE: Check to ensure that all screws, clamps, and connectors are secure after 100-200 miles.**



***advanced FLOW engineering, inc.***

Corona, CA 92879

<https://afepower.com/contact-us>