

**advanced FLOW engineering** Cold Air Intake System

**Instruction Manual** P/N: 50-70132D / 50-70132R

Make: Ford

Model: Super Duty F-250/F350

Year: 2023-2025

Engine: V8-6.8L



- Please read the entire instruction manual before proceeding.
- Ensure all components listed are present.
- For technical support please call 951-493-7185.
- Ensure you have all necessary tools before proceeding.
- Do not attempt to work on your vehicle when the engine is hot.
- Retain factory parts for future use.

Label	Qty.	Description	Part Number
A1	1	Air Filter (Pro 5R)	24-91061
A2	1	Air Filter (Pro DRY S)	21-91061
B	1	Tube	05-5070129B1
C	1	Housing	05-5070058B2
D	1	Coupler, Silicone Bellows	05-01802
E	2	Clamp, 060 (3-5/16" - 4-1/4")	03-50002
F	1	Seal, Trim	05-01553
G	1	Clamp, T-bolt (8-5/16" - 8-5/8")	03-50267
H	1	Plug, Silicone	05-01429
J	2	Screw, Torx: M4x10mm	03-50490
K	4	Retainer Clip	05-01554

**Installation will require the following tools:**

Panel clip remover, T20 Torx driver, 7mm & 8mm nut driver, 11mm deep socket, extension and driver

Warranty Information available at <https://afepower.com/contact#warranty>

**Emissions Disclaimer:** This product is not currently CARB exempt and is not available for purchase in California or for use on any vehicle registered with the California Department of Motor Vehicles.

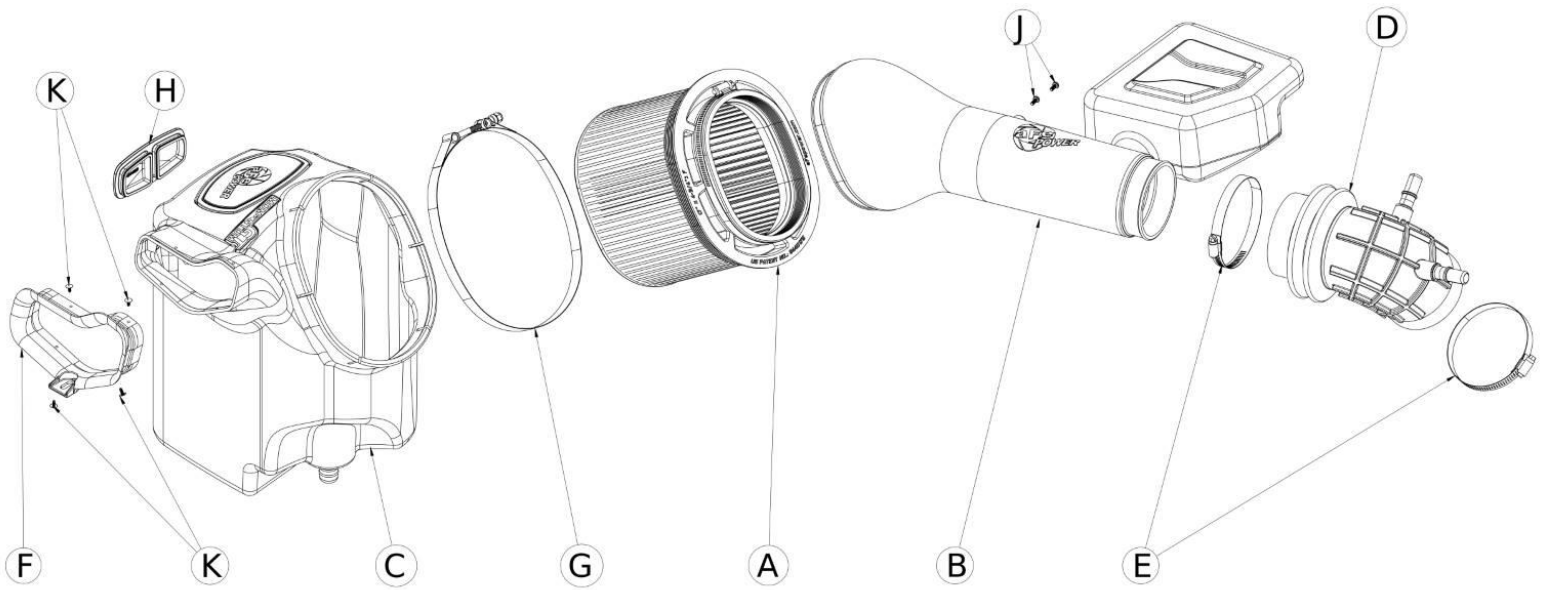

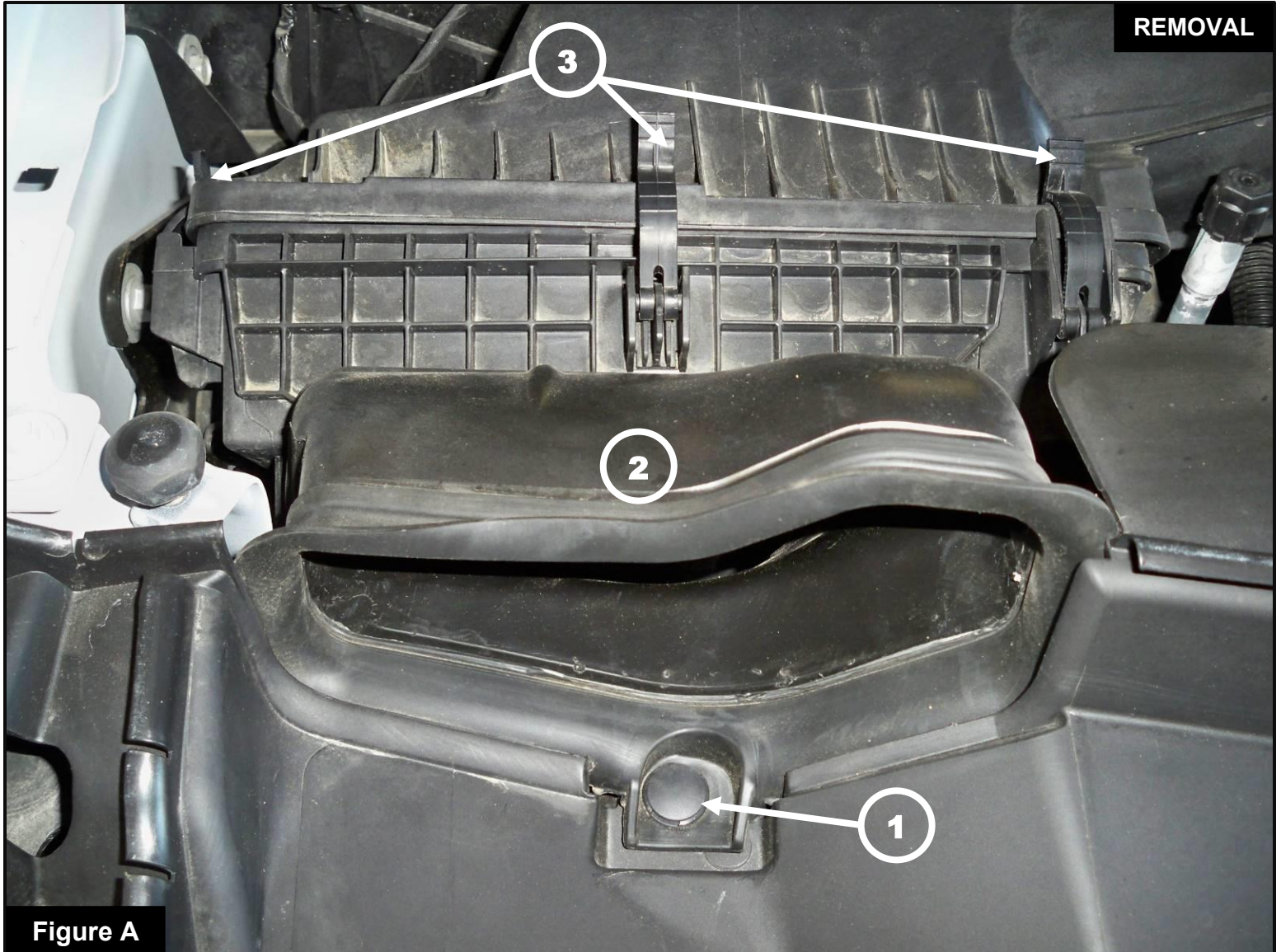

### **Refer to Figure A for Steps 1-3**

Step 1: Using a panel clip remover, remove the retaining plastic clip ① holding part of the scoop seal down and set aside for later use.

Step 2: Snap out the plastic scoop ② from the air filter housing

Step 3: Unclip the three taps ③ from the factory air filter cover.



**Figure B**

**Refer to Figure B for Steps 4-7**

Step 4: Disconnect the two quick disconnect fittings (4) from the factory intake tube.

Step 5: Using a 7mm nut driver, loosen the hose clamp (5) at the throttle body.

Step 6: Disconnect the MAF sensor (6) and the clip (7) holding the harness.

Step 7: Remove the factory air filter cover/intake tube assembly and put aside.



Figure C

**Refer to Figure C for Step 8**

Step 8: Remove the factory lower air filter housing by pulling it straight up from its mounting grommets.

**Figure D****Refer to Figure D for Steps 9-10**

Step 9: Place the scoop seal trim (8) on the scoop opening of the aFe POWER housing.

Step 10: Align the holes from the scoop seal trim and the aFe POWER housing. Insert all four retainer clips (9) fully into the cavities and make sure the seal trim is secure to the aFe POWER housing.

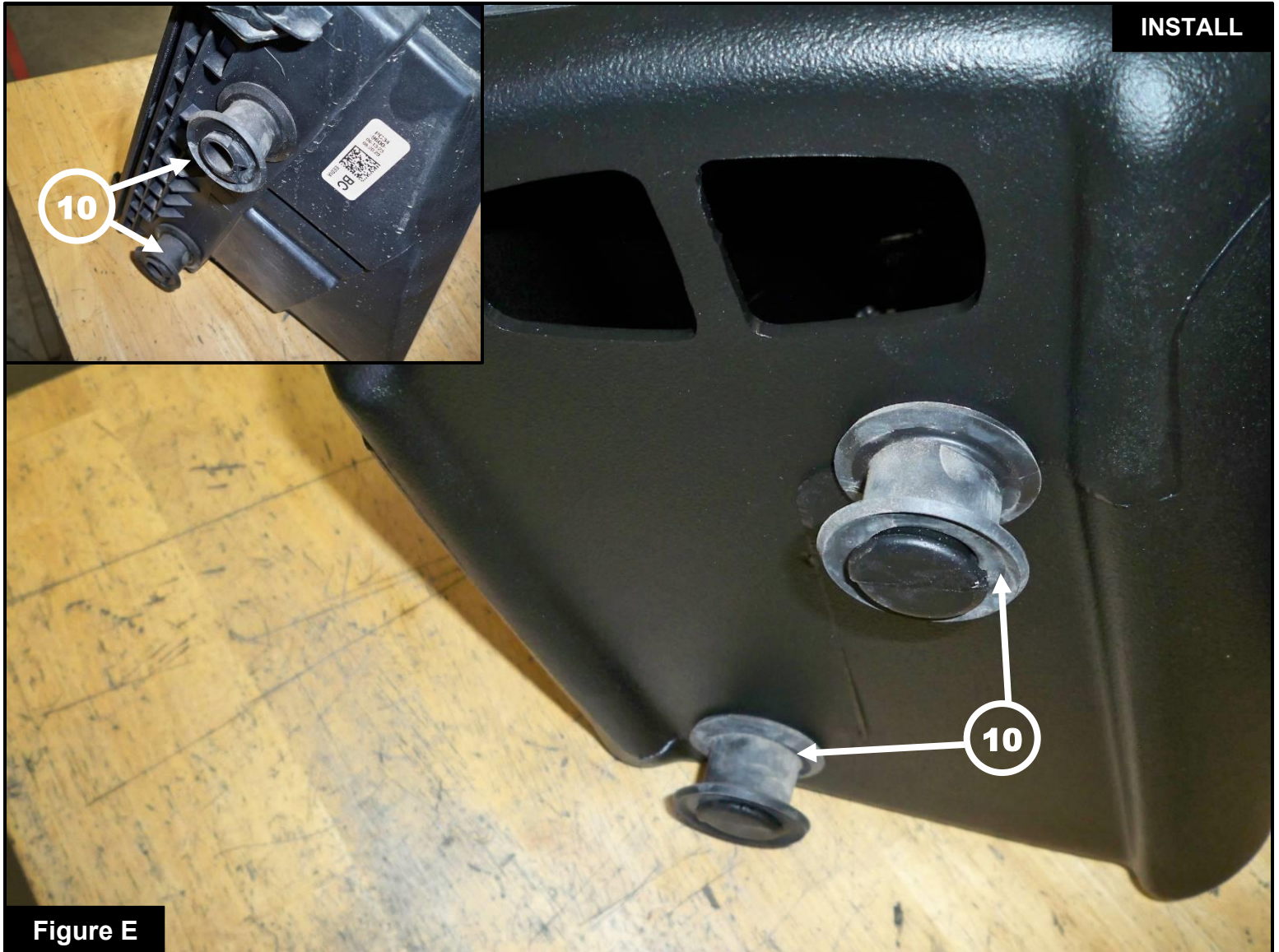

**Refer to Figure E for Step 11**

Step 11: Remove the two grommets (10) from the lower air filter housing and install them onto the aFe POWER housing. Make sure they are fully seated past the bead.

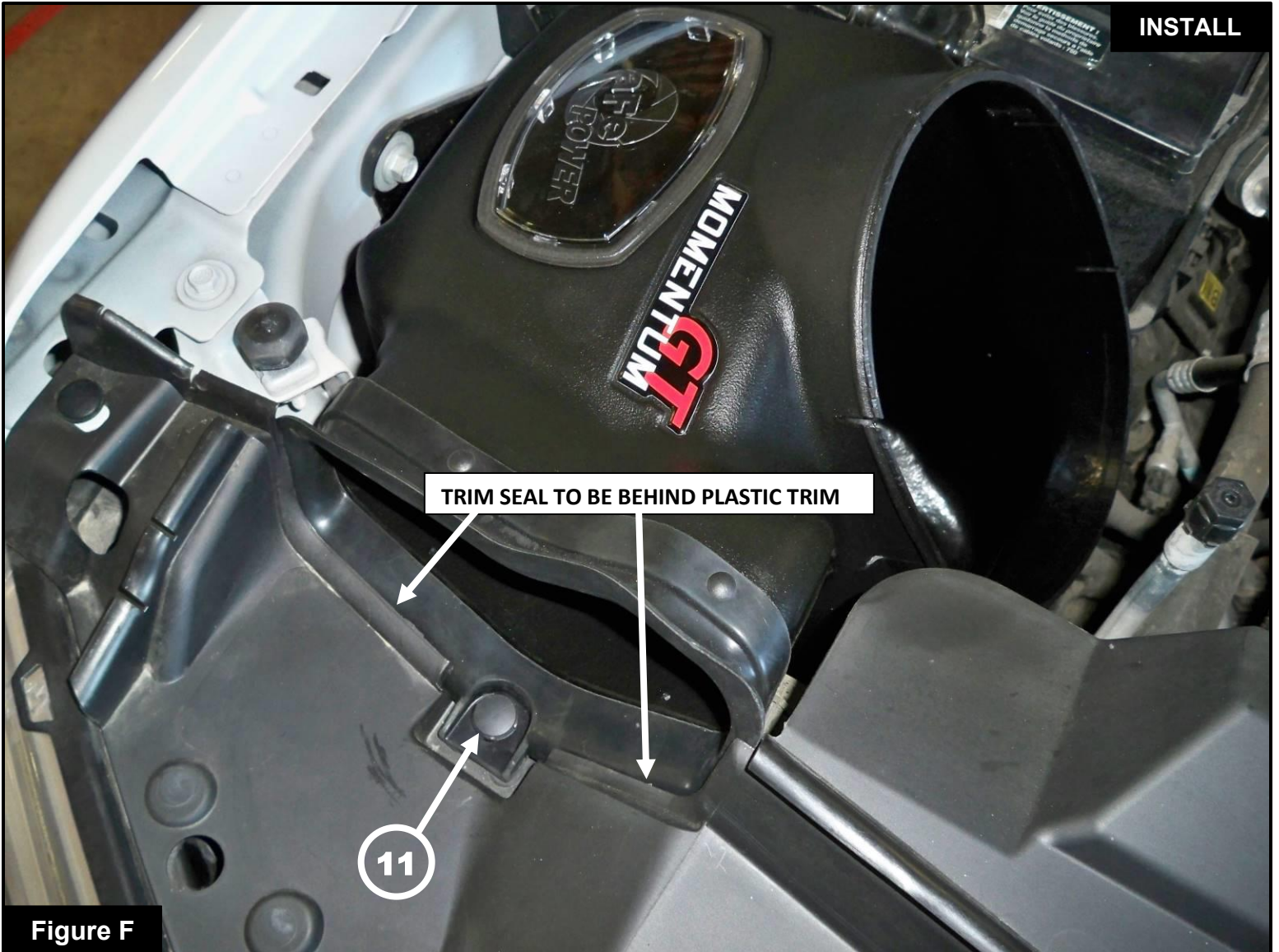
**Figure F****Refer to Figure F for Steps 12-13**

Step 12: Install the aFe POWER housing on to vehicle. Make sure the bottom mounting pin is fully seated in the mounting grommet and the two side mounting pins with grommets are fully engaged on the mounting bracket.

Step 13: Make sure the scoop seal trim seats behind the plastic trim cover (please see picture). Install the retaining plastic clip (11) removed on step 1 to secure the trim seal.

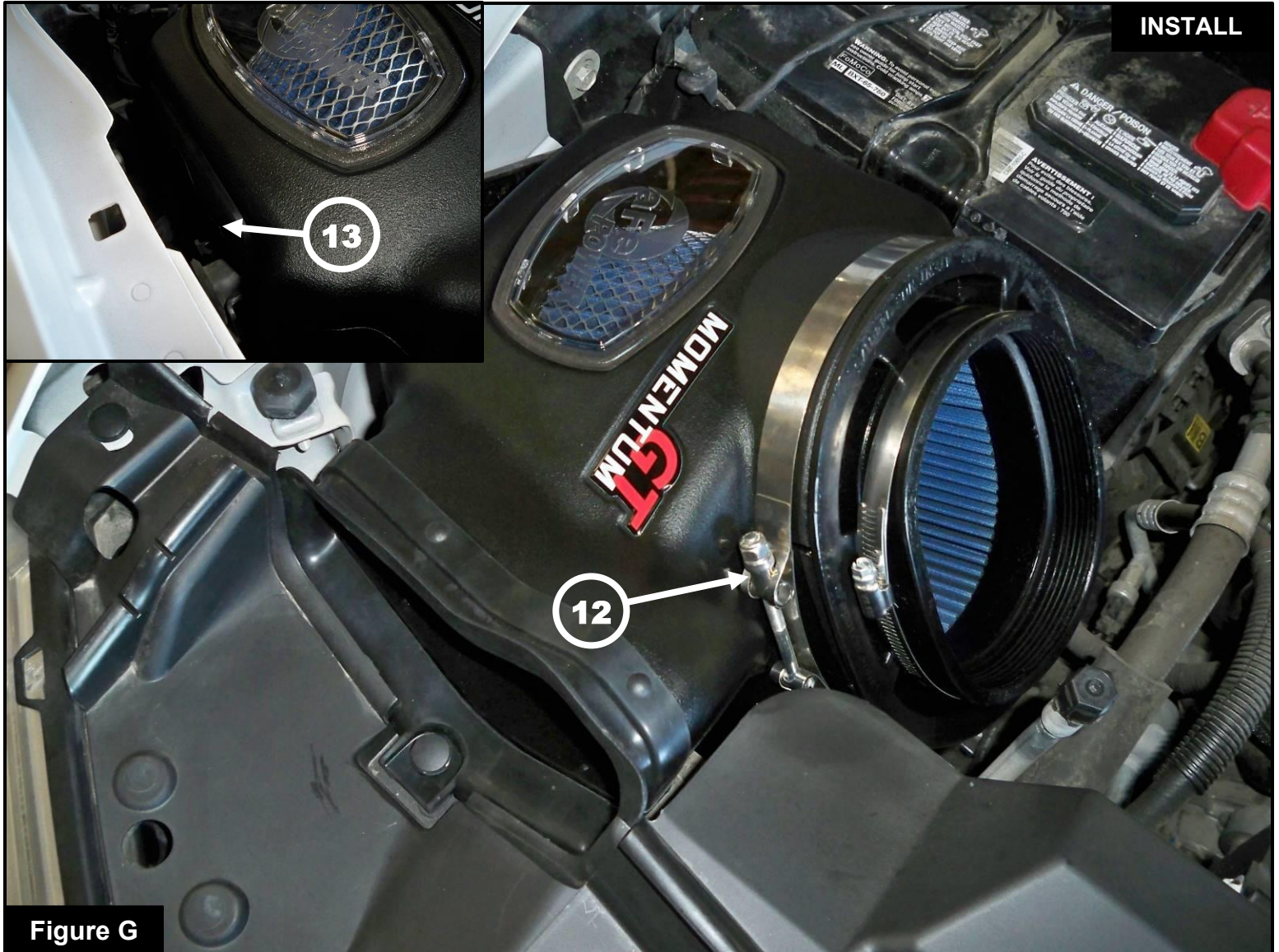

### Refer to Figure G for Steps 14-16

Step 14: Slide the large T-Bolt clamp (12) over the air filter opening on the aFe POWER housing.

Step 15: Slide the aFe POWER filter with clamp into the housing. Do not tighten the clamps.

Step 16: Use the provided plug (13) to close the additional air inlet if you want to completely seal the airbox.

Best performance gain is obtained by having more air flow (no plug).

**Figure H****Refer to Figure H for Steps 17-18**

Step 17: Place the supplied aFe POWER coupler (14) and a #60 clamp (15) over the throttle body. Do not tighten.

Step 18: Place the other supplied #60 clamp (16) on the installed coupler. Do not tighten.

**Figure I****Refer to Figure I for Step 19**

Step 19: Using a T20 Torx driver, remove the MAF sensor ①7 from the factory housing and install it on the aFe POWER intake tube using the supplied M4 screws.

**Figure J****Refer to Figure J for Steps 20-21**

Step 20: Install the aFe POWER intake tube into the vehicle. Slide the tube into the throttle body coupler first, then into the air filter.

Step 21: Align the coupler, intake tube and clamps correctly, then tighten all the clamps ⑮.



Figure K

**Refer to Figure K for Steps 22-24**

Step 22: Reconnect the two breather quick connectors (19).

Step 23: Reconnect the MAF sensor (20).

Step 24: Check all the components are tight and secure. Your installation is now complete. Thank you for choosing aFe POWER!

**NOTE: Check all bolts, clamps, and connectors after 100-200 miles.**



**Page left blank intentionally**

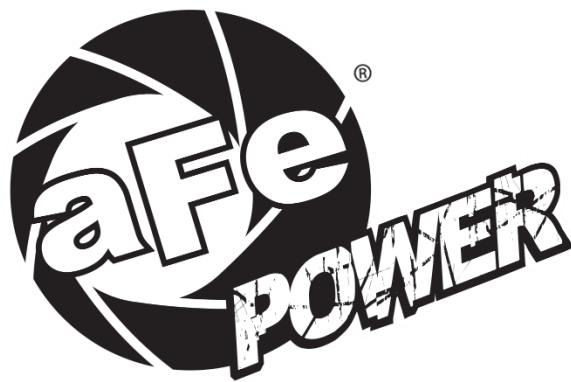

***advanced FLOW engineering, inc.***

Corona, CA 92879

<https://afepower.com/contact>