

# **GT** **MOMENTUM**

**advanced FLOW engineering** Cold Air Intake System

## **Instruction Manual** P/N: 50-70128D / 50-70128R

Make: Volkswagen

Model: Atlas

Year: 2024-2025

Engine: L4-2.0L (t)

Make: Volkswagen

Model: Atlas Cross Sport

Year: 2024-2025

Engine: L4-2.0L (t)



- Please read the entire instruction manual before proceeding.
- Ensure all components listed are present.
- For technical support please call 951-493-7185.
- Ensure you have all necessary tools before proceeding.
- Do not attempt to work on your vehicle when the engine is hot.
- Retain factory parts for future use.

Label	Qty.	Description	Part Number
A1	1	Air Filter (Pro 5R)	24-91108
A2	1	Air Filter (Pro DRY S)	21-91108
B	1	Intake Tube	05-5070128B1
C	1	Intake Housing	05-5070089B2
D	1	Nipple, Brs Hose: 1/4"ID x 1/8npt	03-50194
E	1	Inlet, Trim: 50-70089	05-01742
F	1	Plug, Silicone: 2.25" Dia	05-01482
G	1	Clamp, 044 (2-5/16" - 3-1/4")	03-50019
H	1	Clamp, 048 (2-9/16" - 3-1/2 ")	03-50007
J	1	Coupling, Silicone Bellow: (2.75" x 3")ID x 3"L	05-01528

**Installation will require the following tools:**

T-25 Torx driver, 7mm & 8mm nut drivers, adjustable wrench

Warranty Information available at <https://afepower.com/contact#warranty>

**Emissions Disclaimer:** This product is not currently CARB exempt and is not available for purchase in California or for use on any vehicle registered with the California Department of Motor Vehicles.

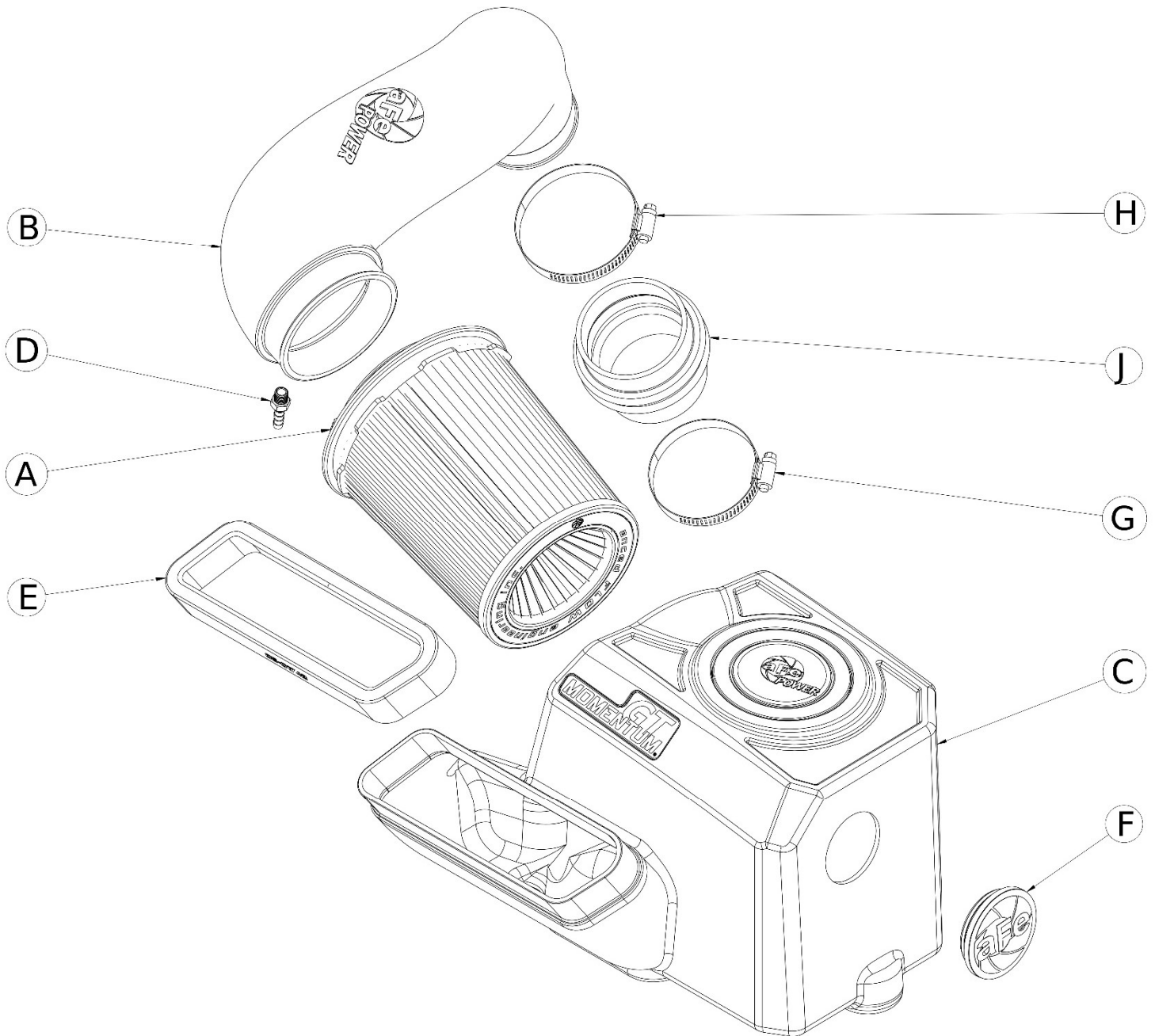

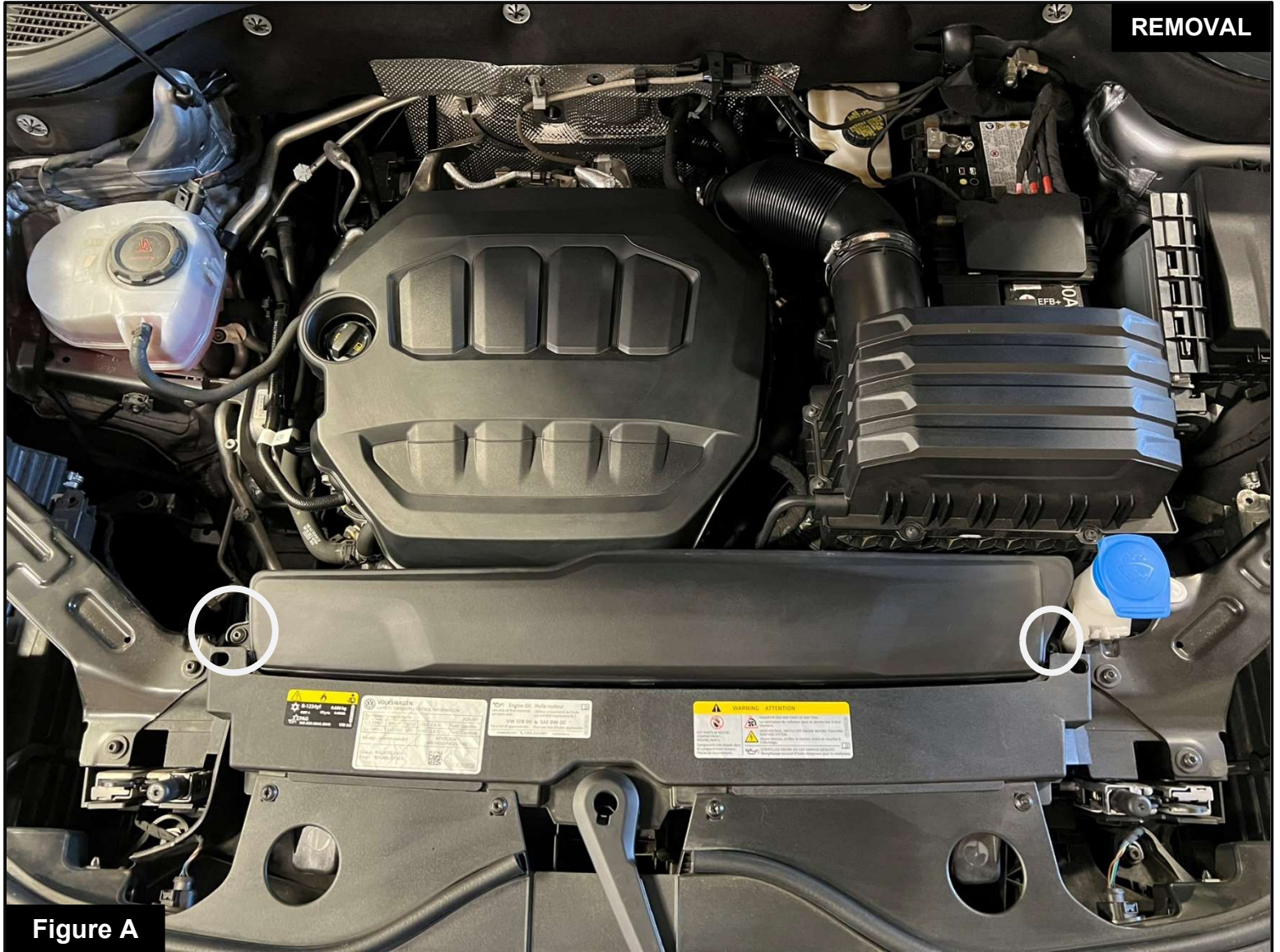

**Refer to Figure A for Steps 1-2**

Step 1: Using a T25 torx driver, remove the two screws that secure the air intake scoop. Screws will be used later in the installation.

Step 2: Remove the air intake scoop. Air intake scoop will be used later in the installation.

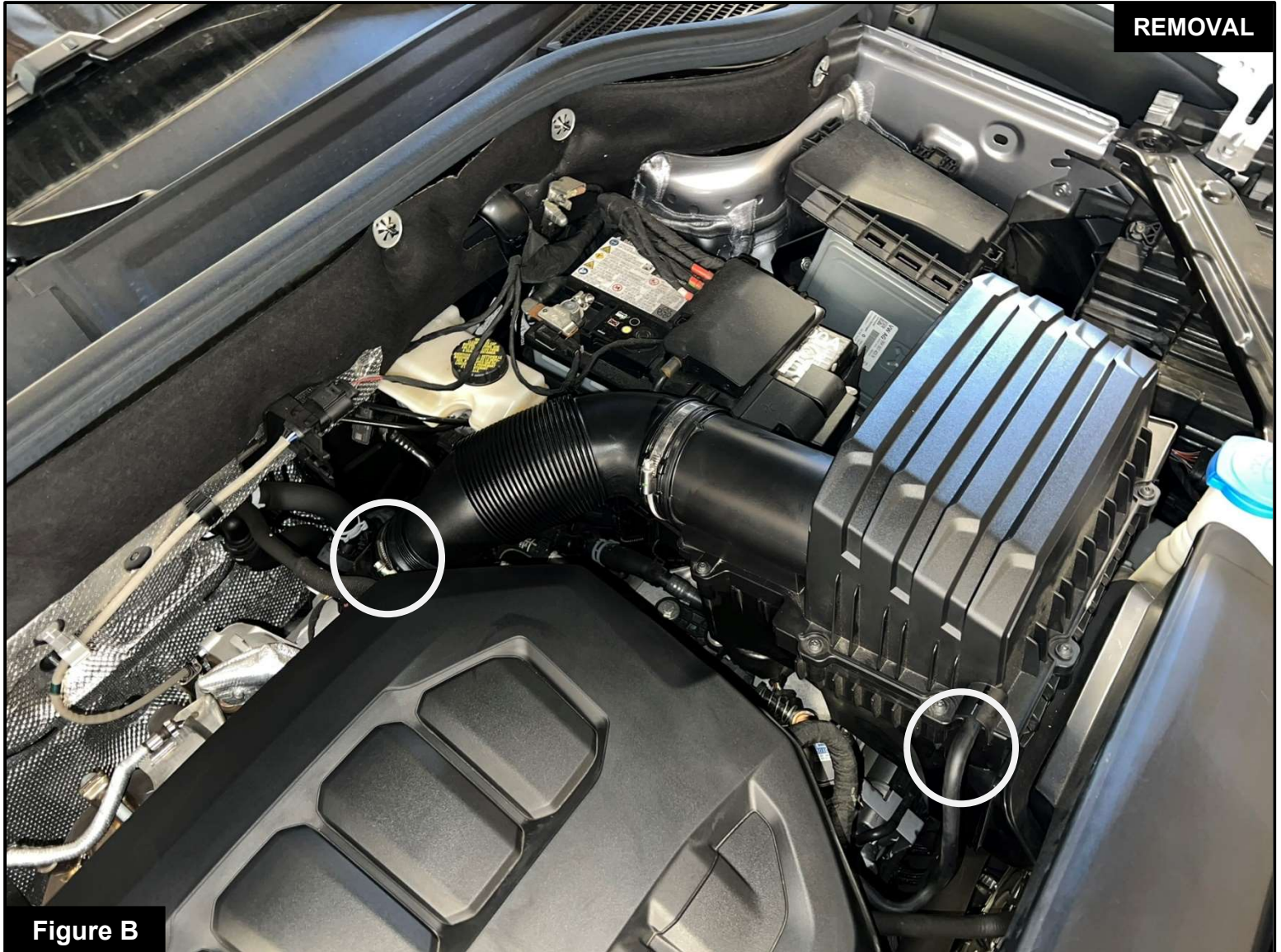

**Refer to Figure B for Steps 3-6**

Step 3: Disconnect the vacuum hose

Step 4: Using a 7mm nut driver, loosen the hose clamp at the turbo inlet.

Step 5: Disconnect the factory intake tube from the turbo inlet.

Step 6: Remove the factory airbox from the three mounting pins. Remove the airbox and intake tube assembly from the vehicle.



Figure C

**Refer to Figure C for Step 7**

Step 7: Transfer the factory airbox grommets to the **aFe POWER** housing as shown.

**Figure D****Refer to Figure D for Steps 8-10**

Step 8: Install the **aFe POWER** housing into the vehicle. Make sure the mounting pins snap into the rubber grommets.

Step 9: Slide the **aFe POWER** filter and clamp into the **aFe POWER** housing and push it in until it locks into place. Do not tighten the clamp at this time.

Step 10: Install the inlet seal trim onto the **aFe POWER** housing as shown.



**Refer to Figure E for Steps 11-12**

Step 11: Install the supplied coupler with the smaller diameter side on the turbo inlet with the supplied **#44** clamp and tighten the clamp using an 8mm nut driver.

Step 12: Place the supplied **#48** clamp onto the other end of the coupling but do not tighten at this time.

**Figure F****Refer to Figure F for Steps 13-15**

Step 13: Install the supplied barb fitting onto the **aFe POWER** intake tube. Do not overtighten, some threads will still be exposed.

Step 14: Install the **aFe POWER** intake tube into the coupling first and then into the air filter. Align the tube correctly and tighten the clamps using an 8mm nut driver.

Step 15: Connect the vacuum hose to the barb fitting.

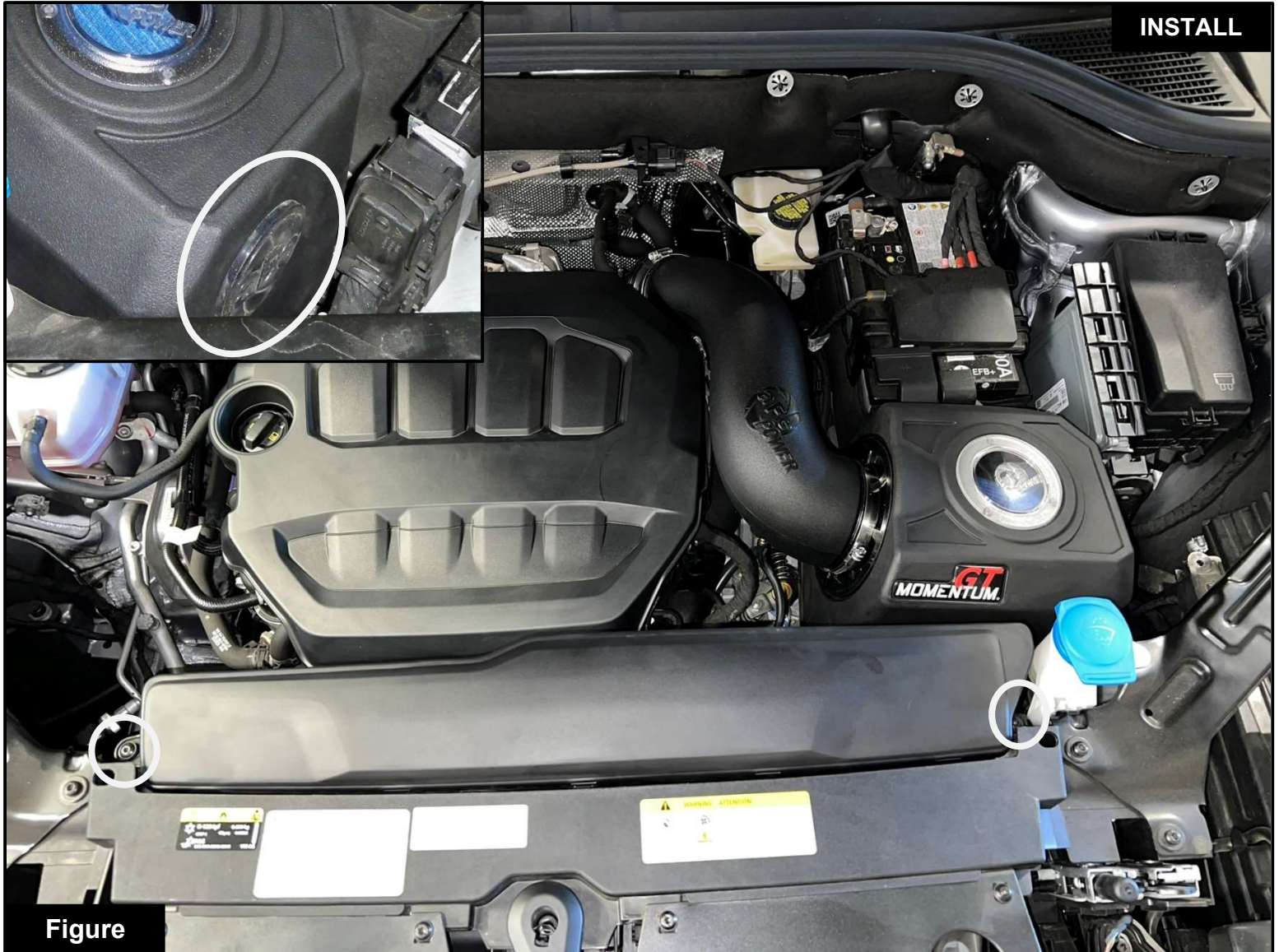

Figure

### **Refer to Figure G for Steps 16-18**

Step 16: Install the factory air intake scoop using the screws that were removed in Step 1.

Step 17: Check that all the components are tight and secure

Step 18: Install the aFe POWER plug. The kit includes an optional plug to close off the auxiliary air inlet.

- **Without the plug installed, the aFe POWER intake will capture the maximum amount of air available. More airflow can lead to increased power, but some of this air may come from inside the engine compartment and could be warmer, potentially affecting vehicle performance.**
- **Installing the plug on the housing will block out hot engine air, ensuring that only the coolest air is directed into the engine. This will also help reduce intake noise.**



**Your installation is now complete. Thank you for choosing aFe POWER!**

**NOTE: Check that all screws, clamps, and connectors are secure after 100–200 miles.**

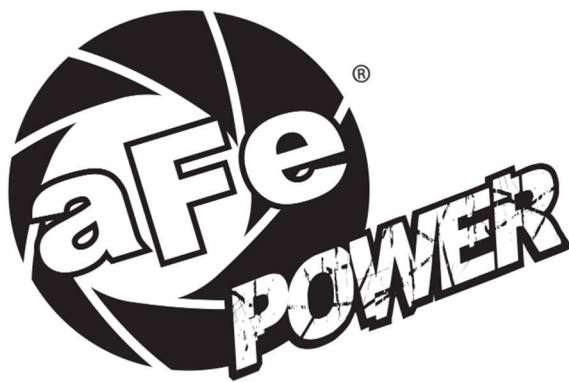

***advanced FLOW engineering, inc.***

Corona, CA 92879

<https://afepower.com/contact>