



INSTALLATION INSTRUCTIONS

Cat-Back Exhaust

MAKE: Honda
MODEL: Civic Sport (Hatchback)
YEAR: 2022-2026
ENGINE: L4-2.0L NA

49-36631-B
49-36631-P

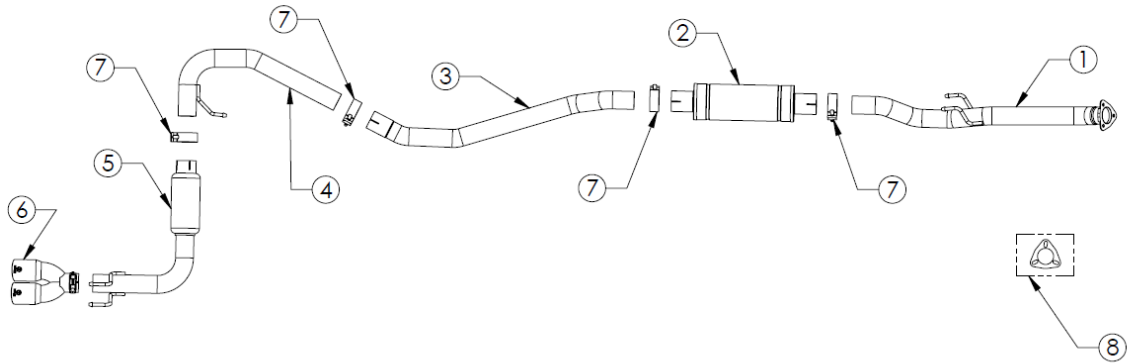

Item	Description	Part Number	Quantity
1	Front Pipe	05-245581	1
2	Resonator Assembly	49M30045	1
3	Mid-Pipe	05-245582	1
4	Over-Axle	05-245583	1
5	Tailpipe	05-245584	1
6	EXH Tip 2-1/2 In x 4-1/2 Out x 7L Bolt On Blk	49T25364-B10	1
6	EXH Tip 2-1/2 In x 4-1/2 Out x 7L Bolt On CF	49T25364-P10	1
7	Clamp, Band: 2-1/2"	05-41061	4
8	Gasket	05-46580	1

aFe POWER recommends professional installation on this product. Thoroughly inspect the aFe POWER exhaust system to make sure there is no damage from shipping (if damage is noted, immediately contact aFe POWER customer service). Allow time for your vehicle to cool down prior to installation. When working on your vehicle proceed with caution. Wear protective safety equipment; eye goggles and gloves to ensure a safe installation.

Install band clamps to proper torque specifications of 40-45 ft-lb.





INSTALLATION INSTRUCTIONS

Cat-Back Exhaust

MAKE: Honda
MODEL: Civic Sport (Hatchback)
YEAR: 2022-2026
ENGINE: L4-2.0L NA

49-36631-B
49-36631-P

1. **(Read instructions prior to installation.)** It is recommended not to fully tighten the exhaust until it has been fully installed. Leave loose for adjustability.
2. Secure vehicle on jack stands (refer to your manual for specified jack stand positions).
3. For faster installation, spread out the parts of the exhaust alongside your vehicle as shown in the diagram above.
4. Secure the stock exhaust with jack/stands.
5. Remove the (x3) nuts securing the O.E. Front Pipe to the O.E. Downpipe. Retain nuts, they will be reused.
6. Remove hangers from the Rubber Mount Isolators and remove the exhaust from the vehicle.
7. Install Takeda Front Pipe using O.E. nuts and supplied gasket. Slide Hangers into O.E. Rubber Mount Isolators.
8. Slide Takeda Front Pipe into Takeda Resonator and secure with provided 2 1/2" Band Clamp.
9. Slide Takeda Mid-Pipe into Takeda Resonator Assembly and secure with provided 2 1/2" Band Clamp.
10. Slide Takeda Over-Axle into Takeda Mid-Pipe and secure with provided 2 1/2" Band Clamp. Slide Hangers into O.E. Rubber Mount Isolators.
11. Slide Takeda Tailpipe into Takeda Over-Axle and secure with provided 2-1/2" Band Clamp. Slide Hangers into O.E. Rubber Mount Isolators.
12. Install Takeda Tip.
13. Ensure that all the components of the aFe POWER exhaust system are aligned and are at a safe clearance from all wires, hoses, brake lines, body parts, and tires.
14. Start from the front of the aFe exhaust system and evenly tighten all clamps and fasteners.
15. Start the vehicle and check for any leaks. If any leaks are found, determine cause and repair as necessary.
16. Remove vehicles from jacks stands.
17. It is recommended to re-tighten all clamps and hardware after 50-100 miles.