



# INSTALLATION INSTRUCTIONS

Cat-Back Exhaust

MAKE: BMW  
 MODEL: M2 (G87)  
 YEAR: 2023-2026  
 ENGINE: L6-3.0L (t)

49-36353-P  
 49-36353-B  
 49-36353-C

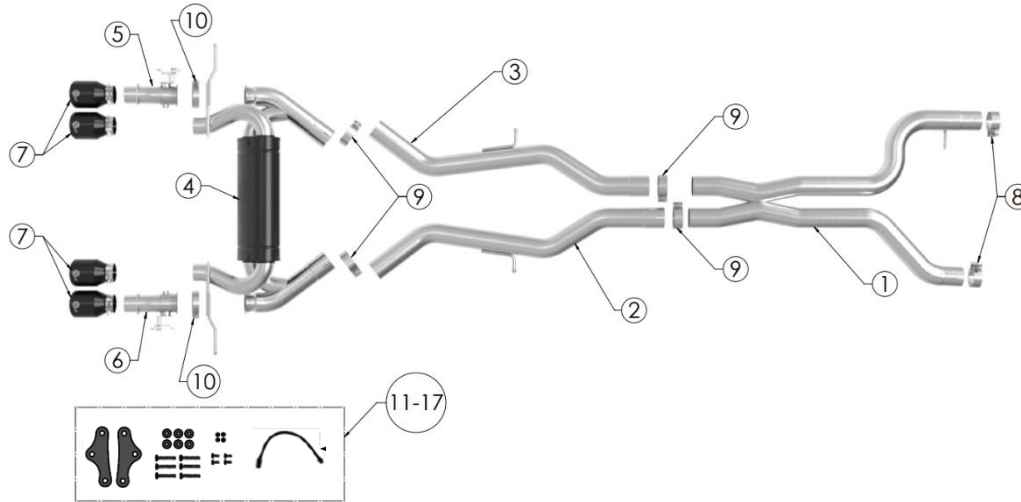

Item	Description	Part Number	Quantity
1	X-Pipe	05-245534	1
2	Passenger Side Mid-Pipe	05-245535	1
3	Drivers Side Mid-Pipe	05-245536	1
4	Muffler Assembly	05-245537	1
5	Drivers Side Tailpipe	05-245538	1
6	Passenger Side Tailpipe	05-245339	1
7	EXH Tip 2-1/2 In x 4 Out x 7L Bolt-On Pol	49T25404-P06	4
7	EXH Tip 2-1/2 In x 4 Out x 7L Bolt-On Blk	49T25404-B06	4
7	EXH Tip 2-1/2 In x 4 Out x 7L Bolt-On CF	49T25404-C07	4
8	Clamp, Band: 2-3/4"	05-41160	2
9	Clamp, Band: 3"	05-41055	4
10	Clamp, V-Band 2.5"	05-410196	2
11	Spacer, Crossmember	05-46572	2
12	Washer, Flat: 24mm ODxM8 ID	03-50065	6
13	Screw, Hex Flange M8-1.25x40	03-50375	6
14	Screw, Hex Hd: M6x1x16	03-50052	4
15	Nut, Hex: M6X1, Gr 8.8	03-50059	4
16	Fixing BOW: Exhaust Valve	05-46273	2
17	Extension, Exhaust Valve: 24"	05-70025	2

**aFe POWER recommends professional installation on this product.** Thoroughly inspect the aFe POWER exhaust system to make sure there is no damage from shipping (if damage is noted, immediately contact aFe POWER customer service). Allow time for your vehicle to cool down prior to installation. When working on your vehicle proceed with caution. Wear protective safety equipment; eye goggles and gloves to ensure a safe installation.

Install band clamps to proper torque specifications of 40-45 ft-lb.

Install V-band clamps with anti-seize lubricant and hand tighten only to torque specifications of 10-15 ft-lb.



## INSTALLATION INSTRUCTIONS

## Cat-Back Exhaust

**MAKE:** BMW  
**MODEL:** M2 (G87)  
**YEAR:** 2023-2026  
**ENGINE:** L6-3.0L (t)

49-36353-P  
49-36353-B  
49-36353-C

1. **(Read instructions prior to installation.)** It is recommended not to fully tighten the exhaust until it has been fully installed. Leave loose for adjustability.
2. Secure vehicle on jack stands (refer to your manual for specified jack stand positions).
3. For faster installation, spread out the parts of the exhaust alongside your vehicle as shown in the diagram above.
4. Secure the stock exhaust with jack/stands.
5. Remove the crossmember.
6. Unplug the connector at the exhaust valves.
7. Cut the O.E. Driver Side Front Pipe 3.5" from the weld after the Catalytic Converter and cut the O.E. Passenger Side Front Pipe 8" from the weld after the Catalytic Converter (See Images below).



8. Un-Bolt all Rubber Hanger Mounts for easier removal of O.E. exhaust (Keep note of hanger mount locations and placement). Retain Mounts and bolts. Remove the O.E. Exhaust from the Car.
9. Remove the exhaust valve motors from the O.E. exhaust and install on to the aFe Power Exhaust using the O.E. hardware and provided fixing bow.
10. Reinstall all Rubber hanger mounts back on to aFe Exhaust.
11. Install aFe Power X-Pipe using the provided 2 3/4" Band Clamps. Install the Rubber Mount Isolator to the chassis using O.E. Bolts.
12. Install Tail-pipe assemblies into muffler assembly with 2 1/2" V-band clamps and Hardware provided.
13. Assemble passenger/driver mid-pipes with muffler assembly using provided 3" band clamps, before installation on vehicle.
14. Using the provided 3" Band Clamps, install the aFe rear exhaust assembly to the aFe Power X-Pipe. Then, Install Rubber Mount Isolators to chassis using O.E. bolts.
15. Then, install tips, Line up exhaust tips so they are flat and square to each other.
16. Install the crossmember with the provided crossmember spacer using the Hardware provided (see image below).

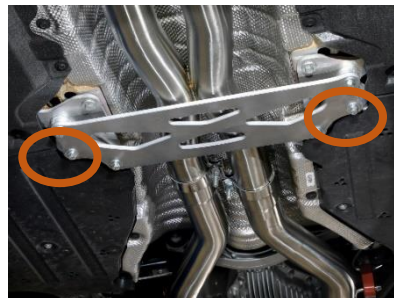

17. Install provide Valve wire extension into the exhaust valve, remove the 3 screws on the right and left heat shields. Route provided extension leads from the O.E. Harness to the aFe exhaust valve under the right and left heat shield, then re-install heat shield hardware (see image below).



## INSTALLATION INSTRUCTIONS

**MAKE:** BMW  
**MODEL:** M2 (G87)  
**YEAR:** 2023-2026  
**ENGINE:** L6-3.0L (t)

**Cat-Back Exhaust**

49-36353-P

49-36353-B

49-36353-C



18. Ensure that all the components of the aFe POWER exhaust system are aligned and are at a safe clearance from all wires, hoses, brake lines, body parts, and tires.
19. Start from the front of the aFe exhaust system and evenly tighten all clamps and fasteners.
20. Start the vehicle and check for any leaks. If any leaks are found, determine cause and repair as necessary.
21. Remove vehicle from jacks stands.
  
22. It is recommended to re-tighten all clamps and hardware after 50-100 miles.

