

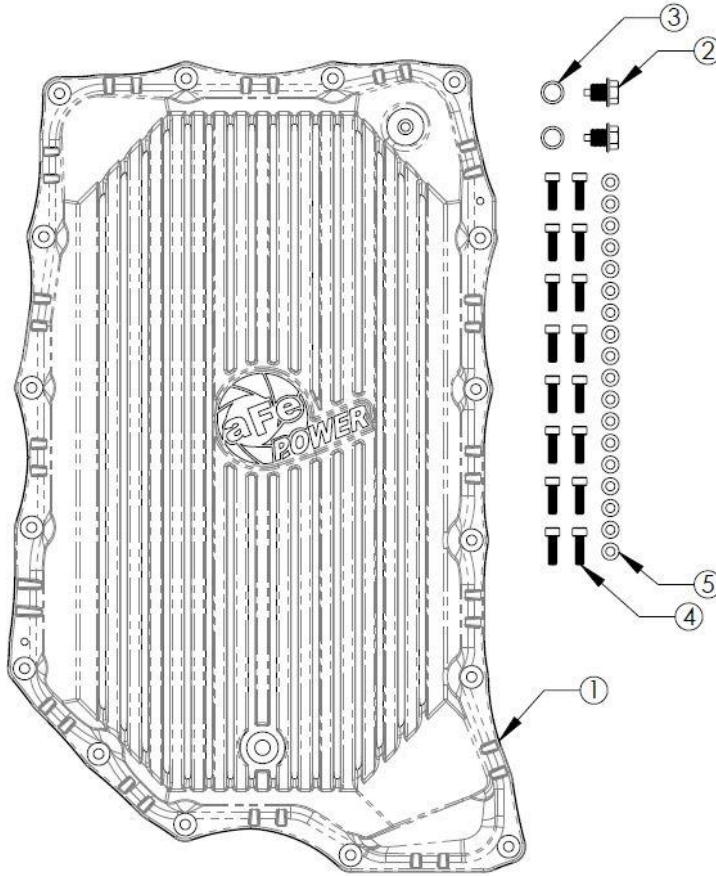

INSTALLATION INSTRUCTIONS

Transmission Pan
46-71380A/46-71380B

MAKE: GM
MODEL: L5P
YEAR: 2020-2025
ENGINE: V8-6.6L (td) with 10L1000 Transmission



| Item | Description | Part Number | Quantity |
|-------------|---|--------------------|-----------------|
| 1 | Transmission Pan, Machined Fins, Raw | 05-61465A | 1 |
| 1 | Transmission Pan, Machined Fins, Black | 05-61465B | 1 |
| 2 | Plug, M12 x 1.25 | 03-50385 | 2 |
| 3 | Washer, Aluminum: M12,15.85MM OD | 03-50384 | 2 |
| 4 | Screw, Socket Head: M6 x 1.00 x 25, S/S | 03-50556 | 16 |
| 5 | Washer, Flat: M6 | 03-50177 | 16 |

aFe POWER recommends professional installation on this product. Thoroughly inspect the aFe POWER exhaust system to make sure there is no damage from shipping (if damage is noted, immediately contact aFe POWER customer service). Allow time for your vehicle to cool down prior to installation. When working on your vehicle



INSTALLATION INSTRUCTIONS

Transmission Pan
46-71380A/46-71380B

MAKE: GM
MODEL: L5P
YEAR: 2020-2025
ENGINE: V8-6.6L (td) with 10L1000 Transmission

1. **(Read instructions prior to installation.)**
2. Secure vehicle on jack stands (refer to your manual for specified jack stand positions).
3. Drain transmission fluid.
4. Remove the OE Transmission pan. It will have oil in it, so have a suitable container to capture the oil.
5. Be careful to not damage the stock gasket, as it will be reused.
6. Thoroughly clean the gasket surface on the transmission and the OE gasket.
7. Install the OE gasket onto the aFe POWER transmission pan.
8. Install the aFe POWER transmission pan with the supplied M6 hardware, do not fully tighten.
9. Tighten transmission pan hardware to 8-10 lb-ft in a crisscross pattern.
10. Install the supplied M12x1.25 magnetic drain plugs and crush washers into the bottom drain hole and fill-level hole.

Note: To properly set the transmission fill level, the transmission fluid temp must be between 167-176°F (75-80°C). Engine must be running, and vehicle must be level when setting the transmission oil level.

11. Fill the transmission with the proper fluid – The aFe POWER transmission pan will hold approximately 5 quarts over the OE pan.
12. Start and idle the engine.
13. With the brakes on, move the shift lever through all the gear ranges, pausing 5 seconds between each shift, then move the shift lever back to park.
14. Allow the engine to idle.
15. Using the Driver Information Center, check the Transmission Fluid Temperature (TFT)
16. To raise the transmission temperature, follow the following procedure:
 - a. Apply the parking brake and the foot brake and lightly load the transmission in first gear to stall the torque converter.
 - b. Do not exceed 1500 RPM
 - c. Do not apply load for more than 10 seconds.
 - d. If desired temperature is not reached, wait ten seconds and repeat the converter stall procedure in ten seconds on- ten seconds off intervals until desired temperature is reached, 167-176°F (75-80°C).
 - e. When suitable temperature is reached, allow the vehicle to idle.
 - f. If the temperature is overshoot, continue to let the vehicle idle until the temperature is reached.
17. Place a container under the transmission fluid level plug and remove the transmission level plug in the corner of the pan.
18. If fluid drains from the fill level hole, allow it to drain until it is dripping then reinstall the fill level plug.
19. If the fluid is not draining, add additional transmission fluid until it comes out of the fill level hole at a steady stream. Allow the fluid to drain until it is dripping then reinstall the fill level plug.
20. Check for leaks, and address as necessary.
21. Congratulations, your aFe POWER Transmission pan is now installed.