

304 Stainless Steel Cat-Back Exhaust Kit

2014-2018 GM 1500 Trucks

(117040020, 117040030)

Installation Guide



HARDWARE PACK:

- 1 (2) 3.0" Stainless Band Clamp
- 2 (5) 2.5" Stainless Band Clamp
- 3 (1) 3/8" - 16 X 1-1/4" Bolt
- 4 (1) 3/8" Flat Washer
- 5 (1) 3/8" Lock Washer
- 6 (1) 3/8" - 16 Nut
- 7 (1) Left Frame Hanger
- 8 (2) Backing Plates
- 9 (1) Rubber Hanger (red)
- 10 (2) 7/16" Hanger Keeper
- 11 (5) 1/2" Hanger Keeper
- 12 (1) Cable Tie

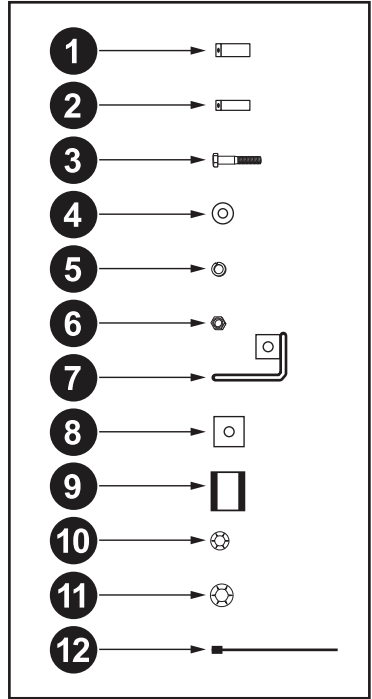

KIT CONTENTS:

- A** (1) Inlet Pipe
- B** (1) Extension
- C** (1) Muffler
- D** (1) Left Front Tailpipe
- E** (1) Right Tailpipe
- F** (1) Left Rear Tailpipe
- G** (2) Side Exit Pipe
- H** (2) Tip

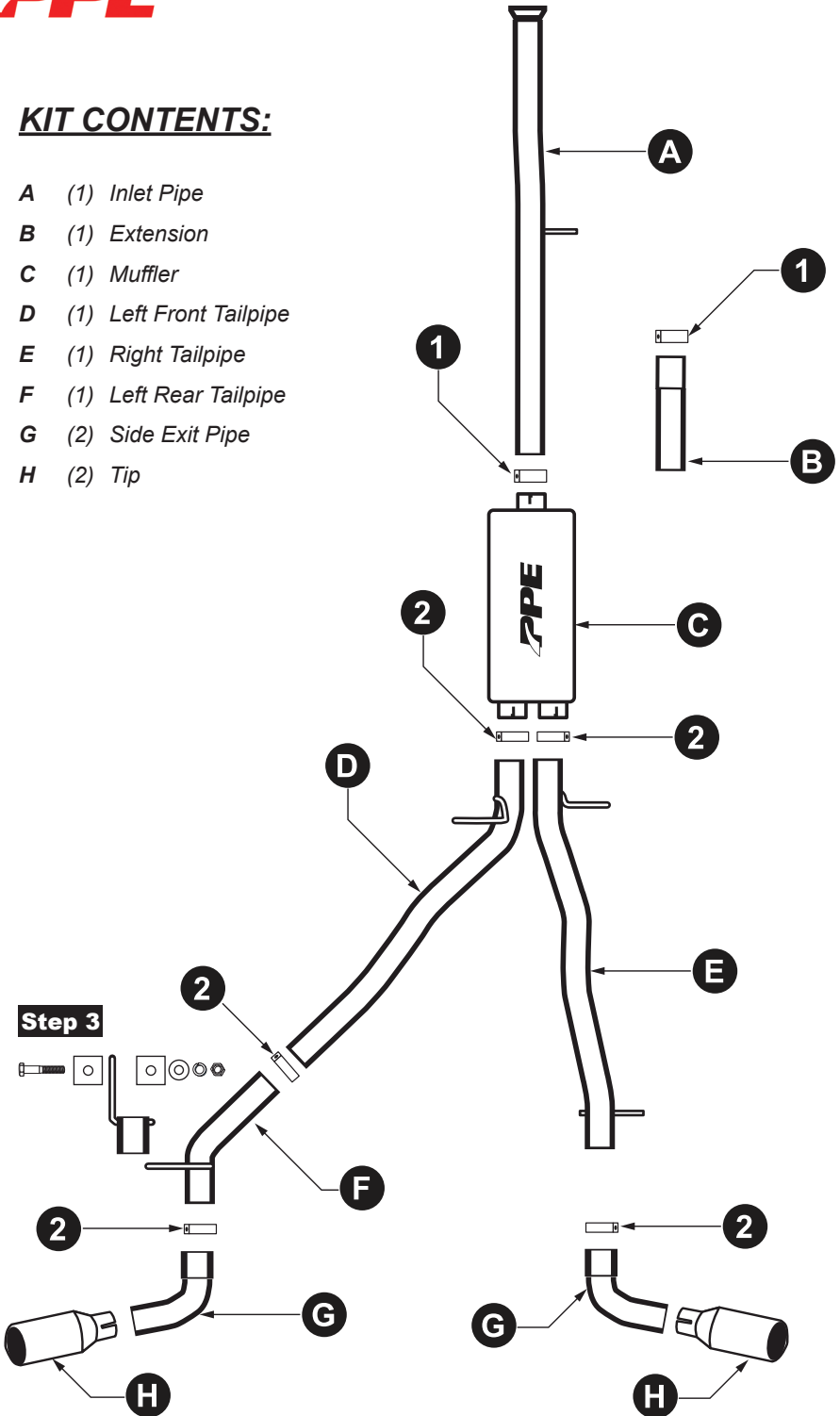

PREPARATION:

- Step 1. Read and understand these instructions before beginning.
- Step 2. Use penetrating lubricant on stock clamps, isolators, and hangers.
- Step 3. Vehicle off. Exhaust cool. Elevate and secure vehicle.

DISASSEMBLY:

- Step 1. Remove factory exhaust system by removing factory clamps and factory hangers from isolators. Cutting the factory exhaust pipe at the muffler to divide the assembly can help with removal.
- Step 2. Remove factory clamp from pipe inlet and retain for reuse.

ASSEMBLY:

PREP. Remove nuts from PPE Clamps **(1, 2)** and apply anti-seize to bolts and nuts.

NOTE. Properly seat Clamps fully on all junctions so your exhaust fits securely.

- Step 1. Place factory clamp retained from **Disassembly Step 2** onto Inlet Pipe **(A)**. Connect Inlet Pipe to catalytic converter. Install hanger to factory isolator.

NOTE. Complete this step only if your vehicle is a Crew Cab model with a 6'.5" bed. The Extension **(B)** will not be used on Double Cab or 5.5' Crew Cab models.

Place 3" Clamp **(1)** onto Extension **(B)** inlet then connect to Inlet Pipe **(A)**.

- Step 2. Place 3" Clamp **(1)** on to Muffler **(C)** inlet then connect Muffler to Inlet Pipe **(A)** or Extension **(B)** depending on your model. Tighten front Clamp **(1)** snug for now to allow for later adjustment. Place 2.5" Clamps **(2)** onto Muffler outlets.

- Step 4. Route Right Tailpipe **(E)** over rear axle then connect it to passenger side Muffler outlet **(C)**. Insert both hangers into the isolators to complete connection. Tighten front Clamp snug for now to allow for later adjustment.

- Step 5. Route Left Front Tailpipe **(D)** over rear axle then connect it to passenger side Muffler outlet **(C)**. Insert hanger into isolator to complete connection. Tighten front Clamp snug for now to allow for later adjustment.

- Step 3. Locate the following parts:
- (3)** (1) 3/8 - 16 X 1-1/4" Bolt
 - (4)** (1) 3/8" Flat Washer
 - (5)** (1) 3/8" Lock Washer
 - (6)** (1) 3/8" - 16 Nut
 - (7)** (1) Left Frame Hanger
 - (8)** (2) Backing Plates
 - (9)** (1) Rubber Isolator (red)

Assemble as shown (**Fig. 1**)
with driver side frame rail
(oblong hole located behind tire
between Backing Plates **(8)**)

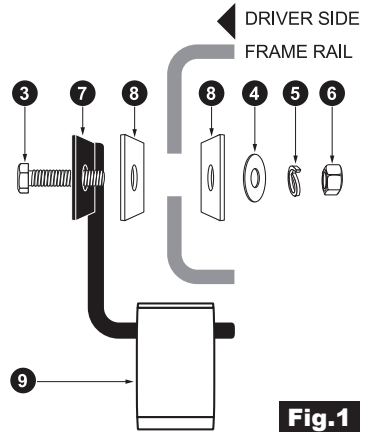

- Step 6. Place one 2.5" Clamp **(2)** onto Left Rear Tailpipe **(F)** then connect Rear Tailpipe to Left Front Tailpipe **(D)**. Tighten Clamp snug for now to allow for later adjustment. Use Cable Tie **(12)** to secure vent hose and brake lines away from exhaust components.
- Step 7. Place 2.5" Clamp **(2)** onto Side Exit Pipe **(G)** then connect it to the Left Rear Tailpipe **(F)**. Tighten front Clamp snug for now to allow for later adjustment.
- Step 8. Place 2.5" Clamp **(2)** onto Side Exit Pipe **(G)** then connect it to the Right Rear Tailpipe **(E)**. Tighten front Clamp snug for now to allow for later adjustment.
- Step 9. Place one Tip **(H)** onto each of the two Side Exit Pipes **(G)** Adjust to level Tips. Tighten snug for now to allow for later adjustment.
- Step 10. Beginning at the front of the Inlet Pipe **(A)** and working towards the Exit Pipes **(G)**, adjust each of the exhaust components to achieve a secure fit. Maintain a minimum 1/2" clearance around all components of the exhaust system for suspension travel and vibration.
- Step 11. Install the 7/16" **(10)** and 1/2" **(11)** Hanger Keepers onto the ends of each hanger to prevent components from slipping out of their mounts.
- Recheck to ensure the hangers and isolators are secure. Recheck that pipes and clamps are properly secure.

This completes the installation.

DISCLAIMER OF LIABILITY

Performance products can increase horsepower above and beyond factory specifications. Additional horsepower creates more stress on the drive-train components, which could result in drive-train failure.

Note regarding emissions-related, non-E.O.-legal products: THESE PRODUCTS ARE LEGAL IN CALIFORNIA ONLY FOR RACING VEHICLES THAT MAY NEVER BE USED, OR REGISTERED OR LICENSED FOR HIGHWAY OR OFF-ROAD USE.

This agreement sets forth the terms and conditions for the use of PPE products. The installation of this product indicates that the Buyer has read and understands this agreement and accepts the terms and conditions. PPE (Pacific Performance Engineering) Inc., its distributors, employees, and dealers (the "Seller") shall not be responsible for the product's proper use and service. The buyer hereby waives all liability claims. The Buyer hereby acknowledges no reliance on the Seller's skill or judgment to select or furnish goods suitable for any particular purpose and that there are no liabilities which extend beyond the description on the face hereof, and the Buyer hereby waives all remedies or liabilities expressed or implied, arising by law or otherwise (including without any obligation of the Seller with respect to fitness, merchantability and consequential damages), or whether or not occasioned by the Seller's negligence. The Seller disclaims any warranty and expressly disclaims any liability for personal injury or damages. The Buyer acknowledges and agrees that the disclaimer of any liability for personal injury is a material term for this agreement and the Buyer agrees to indemnify the Seller and to hold the Seller harmless from any claim related to the item of equipment purchased. Under no circumstances will the Seller be liable for any damages or expenses by reason of use or sale of any such equipment. The Seller assumes no liability regarding the improper installation or misapplication of its products. It is the installer's responsibility to check for proper installation and if in doubt, contact the manufacturer. The Buyer is solely responsible for all warranty issues from the manufacturer.

LIMITATION OF WARRANTY

The Seller gives Limited Warranty as to description, quality, merchantability, and fitness for a particular purpose, productiveness, or any other matter of Seller's product sold herewith. The Seller shall not be responsible for the products proper use and service and the Buyer hereby waives all rights other than those expressly written herein. This warranty shall not be extended, altered or varied except by a written instrument signed by Seller and Buyer. The Warranty on PPE Manifolds and Up-Pipes Kits, OEM-Length Up-Pipes is three (3) years, a limited lifetime warranty on PPE cast aluminum pans and covers, and a limited lifetime warranty on PPE Transmission Coolers and one (1) year limited warranty on all other PPE products from the date of sale to original buyer and limited solely to the parts contained within the products kit. All products that are in question of Warranty must be returned prepaid to the Seller and must be accompanied by a dated proof of purchase receipt. All Warranty claims are subject to approval by Seller. Under no circumstances will the Seller be liable for any labor charged or travel time incurred in diagnosis for defects, removal, or re-installation - of this product or any other contingent expenses. Under no circumstances will the Seller be liable for any damage or expenses incurred by reason of the use or sale of any such equipment. In the event that the buyer does not agree with this agreement: the buyer may promptly return this product, in a new and unused condition in its original packaging, with a dated proof of purchase to the place of purchase within ten (10) days from date of purchase for a full refund. The installation of this product indicates that the buyer has read and understands this agreement and accepts its terms and conditions.

⚠ CA WARNING: Handling passenger or off-highway motor vehicle parts can expose you to chemicals such as phalates and lead, which can cause cancer and reproductive harm. To minimize exposure, service the vehicle in a well-ventilated area, wear gloves, and wash your hands. For more information see www.P65Warnings.ca.gov/motor-vehicle-parts.

