



**WARNING:** This product contains a chemical known to the State of California to cause Cancer and Reproductive Harm. For more information, go to [www.P65Warnings.ca.gov](http://www.P65Warnings.ca.gov).

**2007-13 CHEVY SILVERADO 1500  
2007-10 CHEVY SILVERADO 2500 HD  
REAR WHEEL WELL LINER**

**PLEASE READ INSTRUCTIONS CAREFULLY BEFORE STARTING THE INSTALLATION.  
NOTE: FOR EASIER INSTALLATION, REMOVE THE TIRE.**

**INCLUDED IN HARDWARE KIT:**

1.



Driver Side & Passenger  
Side Liner  
1 pr

2.



Pinch Clip "A"  
2 pcs

3.



Pinch Clip "B"  
2 pcs

4.



"U" Clip  
4 pcs

5.



Truss Head Screw  
6 pcs

6.



Self-Tapping Screw  
4 pcs

**TOOLS NEEDED:**

Gloves  
Phillips Screwdriver  
Pliers (optional)

Pry Tool  
Drill with 7mm or 9/32 Socket

**PREPARATIONS:**

Please clean the interior panels of the rear wheel well prior to installation.

If vehicle comes equipped with factory wheel well liners, these will need to be removed, along with any fasteners involved.

If you have aftermarket flares installed, these will need to be removed prior to installation of wheel well liners. The fastening system may need to be modified to accommodate aftermarket flares.

## REAR WHEEL WELL LINER INSTALLATION



Install a supplied "U" Clip onto Wheel Well Liner in 2 places – flat side of clip faces into the wheel well.

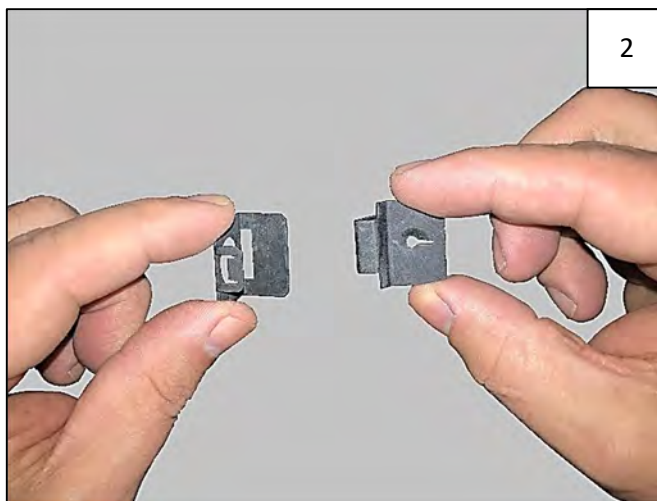

Assemble Pinch Clip "A" and Pinch Clip "B" as shown. Do NOT pinch down to engage clips at this time.

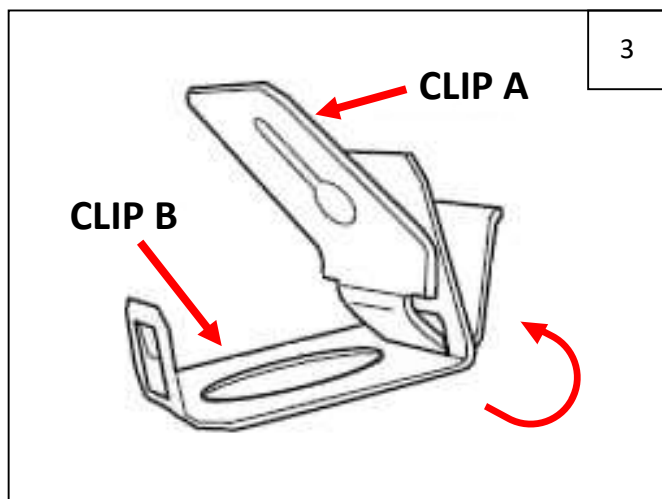

Pinch Clip assembly detail.



Carefully center Pinch Clip combo over the lower lip of the sheet metal structure inside center of wheel well, with body of clip below structure as shown. Squeeze the 2 Pinch Clip pieces shut on metal seam until they snap together. Use a pair of pliers to snap the clips if needed.



If needed, use a pair of pliers to squeeze Pinch Clip shut.



Slide the Rear Wheel Well Liner behind wheel. It is helpful to tilt the liner at a 45-degree angle at front of wheel and then straighten it out once it's behind the wheel.





Tuck Rear Wheel Well Liner under metal fender lip at all outward facing edges. Use a plastic pry tool to assist in tucking the wheel well liner in place if needed.



Install a supplied Truss Head Screw through hole at back of Wheel Well Liner and into Clip installed in Steps 4-5.



Using a Phillips Screwdriver, install 2 supplied Truss Head Screws through 2 holes located along upper lip of fender and into clips installed in Step 1.



Using a drill with a 7mm or a 9/32 socket, install a supplied Self-Tapping Screw through 2 holes, located at the front and rear end of wheel well.



Self-Tapping Screw locations.



Installation is complete. Repeat for other side.