

Heavy Duty Cast Aluminum Deep Transmission Pan

2019-2024 GM Silverado/Sierra 1500

2023-2024 GM Canyon/Colorado

8-Speed Transmission

(128051800, 128051810, 128051820)

Installation Guide

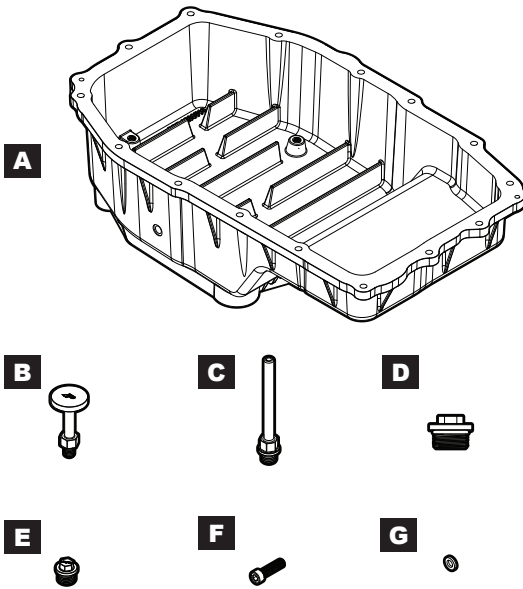

CONTENTS:

- A** (1) Cast Aluminum Transmission Pan
- B** (3) Filter Support
- C** (1) Level Check Standpipe
- D** (1) Magnetic Drain Plug
- E** (1) Magnetic Level Check Plug
- F** (15) M6 SHCS
- G** (15) M6 Flat Washers



INSTALLATION:

Step 1. Vehicle off and engine cool.

Step 2. Loosen heat shield bolt on the side of the transmission **(Fig. 1)**.

Step 3. Remove factory fluid level check plug bolt for initial drainage. Collect all drained fluid **(Fig. 2)**.

Step 4. Remove passenger side trans pan bolts for more drainage before removing the pan **(Fig. 3)**.

Step 5. Remove the rest of the bolts and the pan carefully, avoid spillage **(Fig. 4)**.

Step 6. Prepare the PPE Transmission Pan by installing the three filter supports (80 lb-in) and the fluid level check standpipe (108 lb-in). The threads have anti-seize on them, do not clean that off **(Fig. 5)**.

Step 7. Clean factory gasket and install to the PPE Pan.

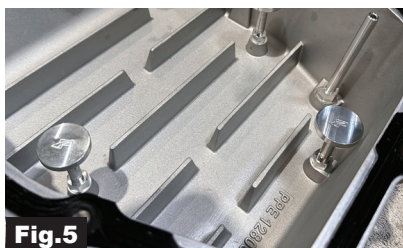

- Step 8. Change transmission filter if desired **(Fig. 6)**.
- Step 9. Install PPE Pan to the transmission case. Hand tighten all bolts first, then to 10-12 lb-ft in a crossing pattern.
- Step 10. Tighten drain plug to 18 lb-ft **(Fig. 7)**.



FLUID FILLING:

Follow GM Service Manual for exact steps.

The following steps were performed in our test fitment on a 2024 Silverado 2.7L Turbo with no bypass valve or fluid flush. Only the PPE Deep Pan and Filter were installed during our test fitment.

For Reference Only:

- Step 1. Lift the plunger and remove the transmission fluid fill tube plug on the side of the transmission
- Step 2. Roughly measure how much fluid drained out during installation.
- Step 3. Add 4 quarts to the amount of fluid measured in step 2 as an initial fill through the fill tube **(Fig. 8, Fig. 9)**.

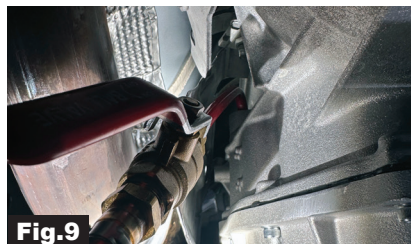

- Step 4. Start and idle the engine for 60 seconds.*
- Step 5. Shift through each shifter position (R, N, D, L). Stay in each position for at least 3 seconds. Shift back to P.*
- Step 6. Brake torque to bring the transmission fluid temperature to 95 F.*
- Step 7. Remove PPE Fluid Level Check Plug.*
- Step 8. A. If fluid starts flowing out from the level check port, wait until the fluid drips in a non-continuous manner*
- B. If no fluid comes out, add more fluid through the fill tube until it drips.*
- In our installation, we added 8 quarts as the initial fill and another 0.5 quart of fluid to achieve the conditions above.*
- Step 9. Re-install Fluid Level Check Plug to 12 lb-ft.*

Installation Complete

Page Left Intentionally Blank

DISCLAIMER OF LIABILITY

Performance products can increase horsepower above and beyond factory specifications. Additional horsepower creates more stress on the drive-train components, which could result in drive-train failure.

Note regarding emissions-related, non-E.O.-legal products: THESE PRODUCTS ARE LEGAL IN CALIFORNIA ONLY FOR RACING VEHICLES THAT MAY NEVER BE USED, OR REGISTERED OR LICENSED FOR HIGHWAY OR OFF-ROAD USE.

This agreement sets forth the terms and conditions for the use of PPE products. The installation of this product indicates that the Buyer has read and understands this agreement and accepts the terms and conditions. PPE (Pacific Performance Engineering) Inc., its distributors, employees, and dealers (the "Seller") shall not be responsible for the product's proper use and service. The buyer hereby waives all liability claims. The Buyer hereby acknowledges no reliance on the Seller's skill or judgment to select or furnish goods suitable for any particular purpose and that there are no liabilities which extend beyond the description on the face hereof, and the Buyer hereby waives all remedies or liabilities expressed or implied, arising by law or otherwise (including without any obligation of the Seller with respect to fitness, merchantability and consequential damages), or whether or not occasioned by the Seller's negligence. The Seller disclaims any warranty and expressly disclaims any liability for personal injury or damages. The Buyer acknowledges and agrees that the disclaimer of any liability for personal injury is a material term for this agreement and the Buyer agrees to indemnify the Seller and to hold the Seller harmless from any claim related to the item of equipment purchased. Under no circumstances will the Seller be liable for any damages or expenses by reason of use or sale of any such equipment. The Seller assumes no liability regarding the improper installation or misapplication of its products. It is the installer's responsibility to check for proper installation and if in doubt, contact the manufacturer. The Buyer is solely responsible for all warranty issues from the manufacturer.

LIMITATION OF WARRANTY

The Seller gives Limited Warranty as to description, quality, merchantability, and fitness for a particular purpose, productiveness, or any other matter of Seller's product sold herewith. The Seller shall not be responsible for the products proper use and service and the Buyer hereby waives all rights other than those expressly written herein. This warranty shall not be extended, altered or varied except by a written instrument signed by Seller and Buyer.

Limited lifetime warranty on all PPE cast aluminum products, and PPE Transmission Coolers. Three (3) year limited warranty on PPE Manifolds and Up-Pipes Kits, and OEM-Length Up-Pipes. One (1) year limited warranty on all other PPE products from the date of sale to original buyer and limited solely to the parts contained within the products kit. All products that are in question of Warranty must be returned prepaid to the Seller and must be accompanied by a dated proof of purchase receipt. All Warranty claims are subject to approval by Seller. Under no circumstances will the Seller be liable for any labor charged or travel time incurred in diagnosis for defects, removal, or re-installation - of this product or any other contingent expenses. Under no circumstances will the Seller be liable for any damage or expenses incurred by reason of the use or sale of any such equipment. In the event that the buyer does not agree with this agreement: the buyer may promptly return this product, in a new and unused condition in its original packaging, with a dated proof of purchase to the place of purchase within ten (10) days from date of purchase for a full refund. The installation of this product indicates that the buyer has read and understands this agreement and accepts its terms and conditions.



PPEpower.com