

## 20 -Up Jeep Gladiator JT Bed Cap

Thank you for choosing Rough Country.

Please read instructions before beginning installation. Check the kit hardware against the kit contents shown below. Be sure you have all needed parts and know where they go. If question exist, please call us @1-800-222-7023. We will be happy to answer any questions concerning this product. Check all fasteners for proper torque. Check to ensure for adequate clearance between all components. Periodically check all hardware for tightness.

### Care and Cleaning

- Mild soap may be used to clean the Product.
- Periodically check hardware for tightness.

### Components

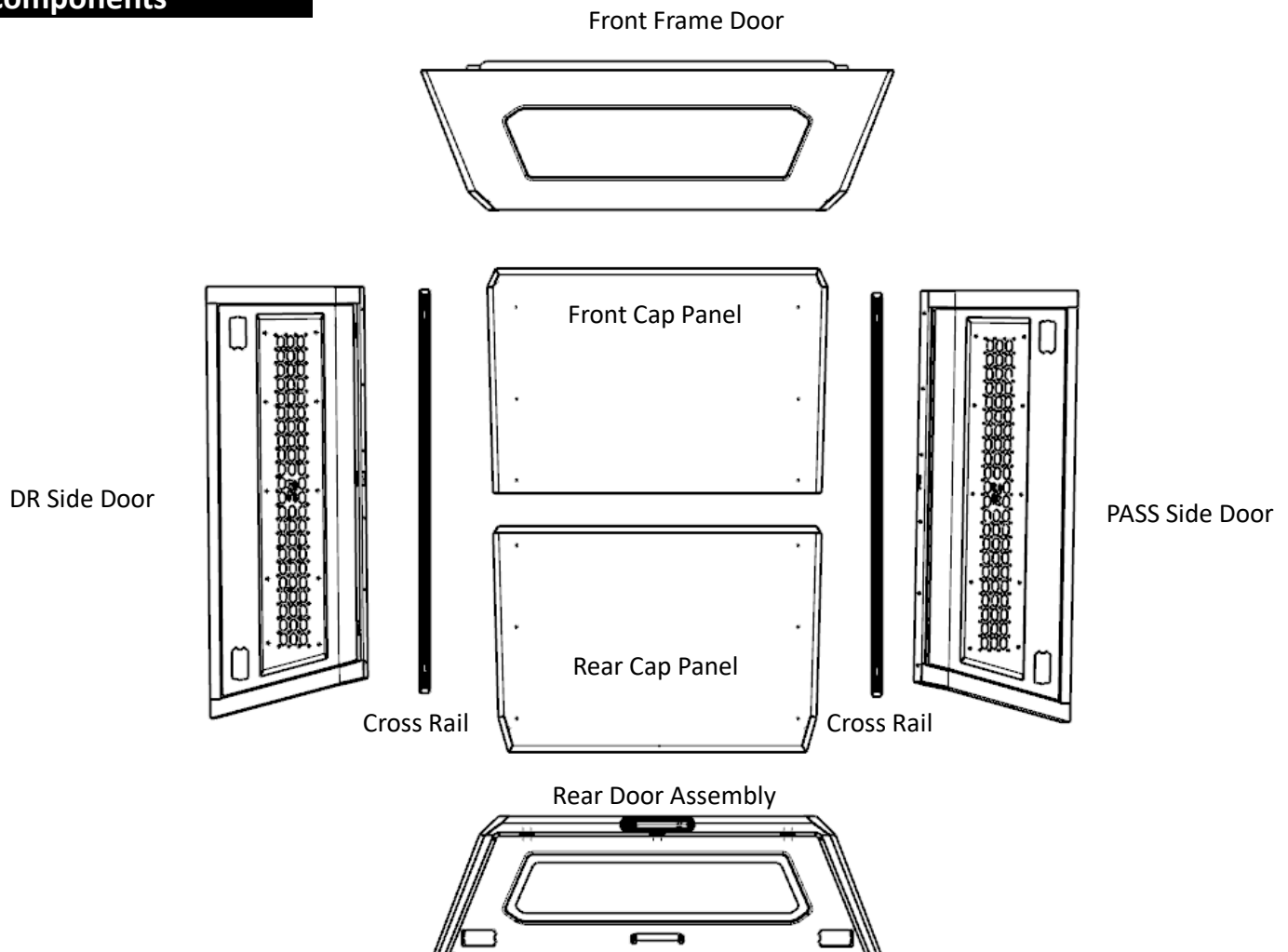

# INSTALLATION INSTRUCTIONS

- **Hardware kits for the bed cap**

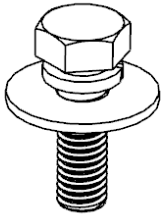

**8mmx25mm  
Combo Kits X40**



**Sealing Strip X1**

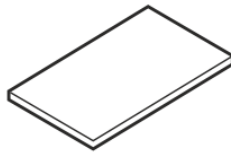

**Black Short Pads X8**

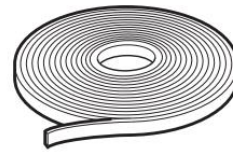

**Foam Seal Tape X1**



**Adhesion  
promoter x1**

- **Bottom Sealing Strip、Bottom Short Pads、  
Foam Seal Tape**

- **Hardware kits for the Front/Rear Roof Top**

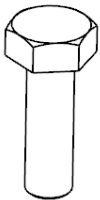

**8mmx25mm Hex Bolts X5**

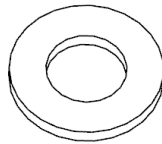

**8mm Flat Washers X5**

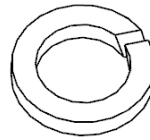

**8mm Lock Washers X5**

- **Hardware kits for the cross rail**

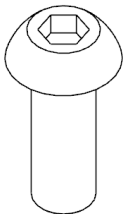

**6mmx16mm Allen Bolts X12**

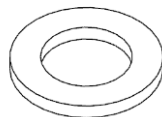

**Plastic 6mm Flat Washers X12**

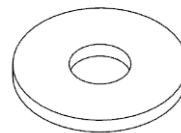

**6mm Flat Washers X12**

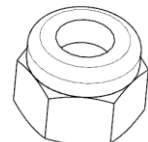

**6mm Lock Nuts X12**

- **Tools**



**Ratchet**



**Extensions**



**13mm Socket**



**10&13mm Wrench**



**S4**

## STEP 1

Install the front roof top bed cap panel and the rear roof top bed cap panel, align with each other and install hardware, do not tighten the hardware.



**8mmx25mm Hex Bolts X5**



**8mm Flat Washers X5**



**8mm Lock Washers X5**

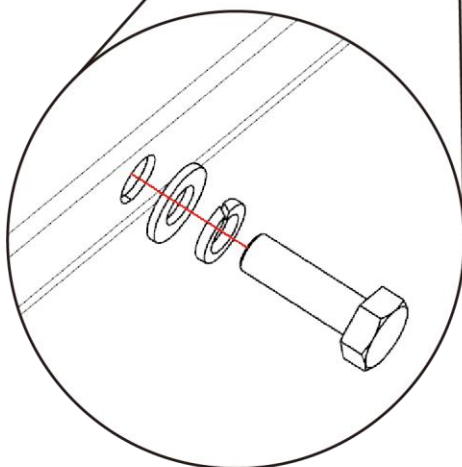
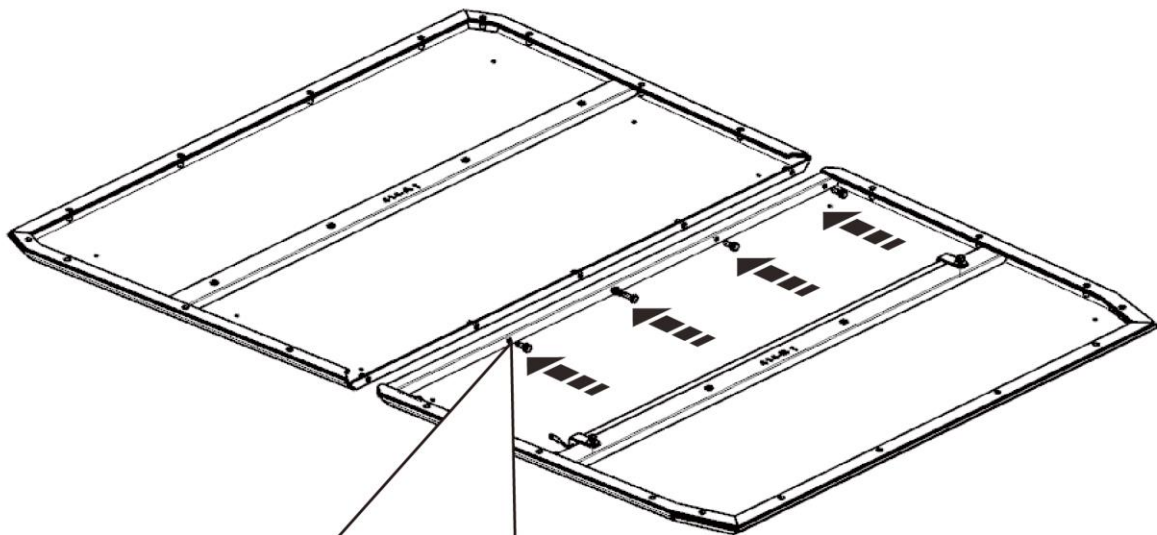

Align the mounting holes of the front bed cap panel and the rear bed cap panel

## STEP 2

Install the utility rail on the bed cap top panels by inserting the supplied 6 mm x 16 mm Bolts / 6 mm plastic washers in the rail from the top and secure the rail to the bed cap top panel with the 6 mm flat washers and 6 mm Flange lock nuts.



**6mmx16mm Allen  
Bolts X12**



**Plastic 6mm Flat  
Washers X12**

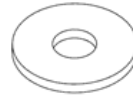

**6mm Flat  
Washers X12**

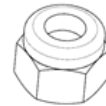

**6mm Lock Nuts  
X12**

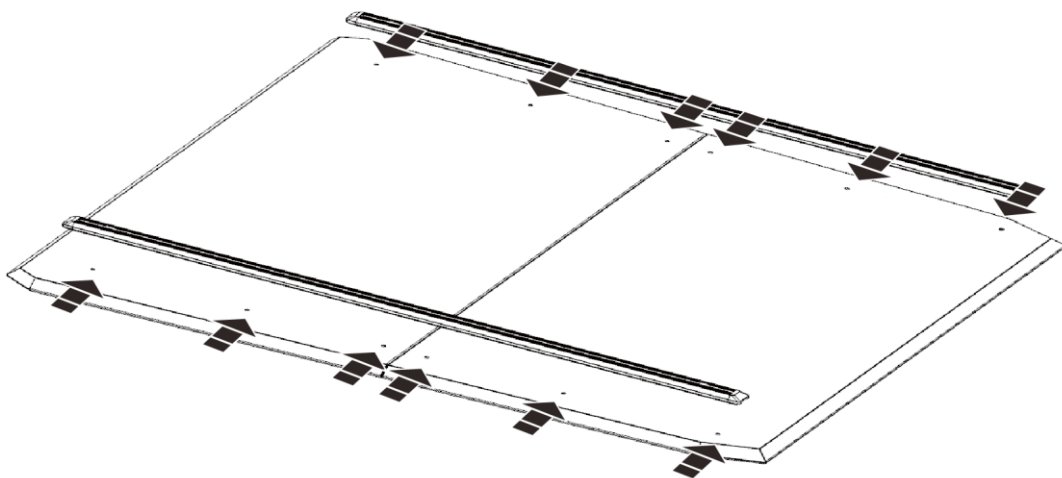

## STEP 3

Install the DR Side Door to the bed cap roof panel, do not tighten the hardware.

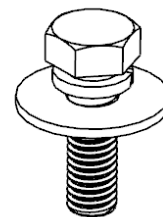
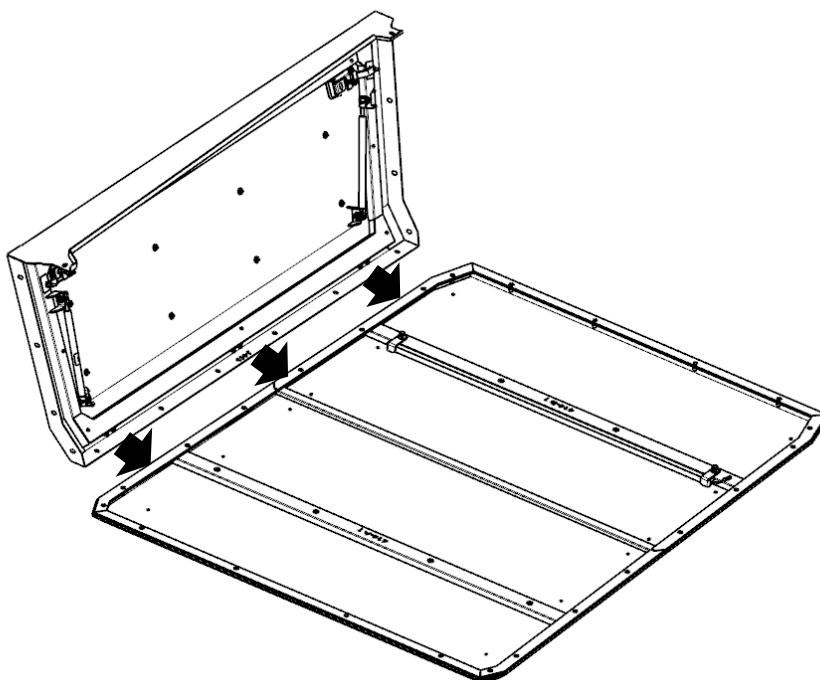

**X 6**

**8 mm x 25 mm Bolt, Lock  
washer and Flat Washer**

# INSTALLATION INSTRUCTIONS

## STEP 4

Install the PASS Side Door to the bed cap roof panel, do not tighten hardware.

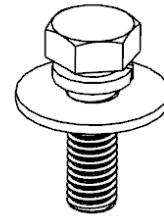
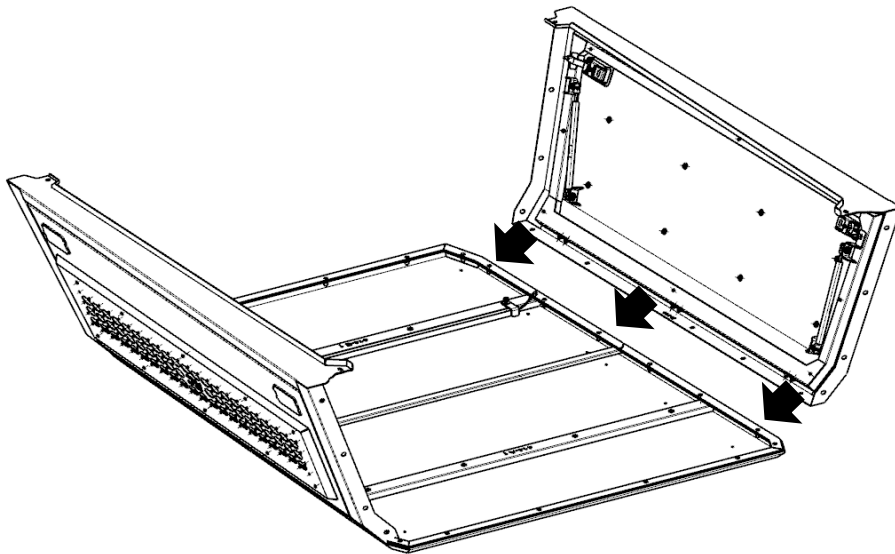

**X 6**

8 mm x 25 mm Bolt, Lock washer and Flat Washer

## STEP 5

Install the front frame to the bed cap assembly, do not tighten the hardware.

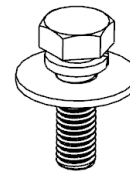
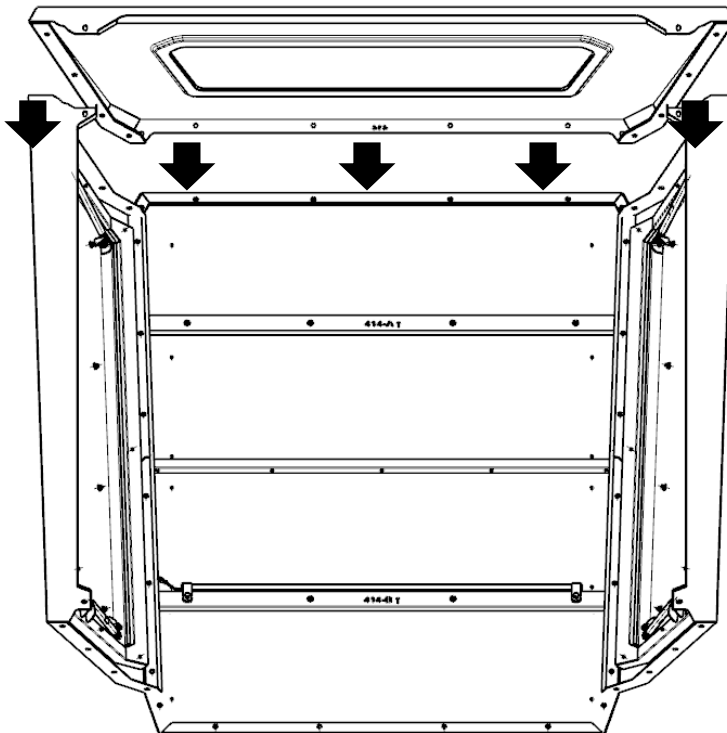

**X 14**

8 mm x 25 mm Bolt, Lock washer and Flat Washer

## STEP 6

Install the rear door assembly to the bed cap assembly, do not tighten the hardware.

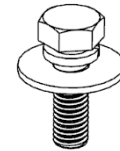

# X 14

8 mm x 25 mm Bolt, Lock washer and Flat Washer

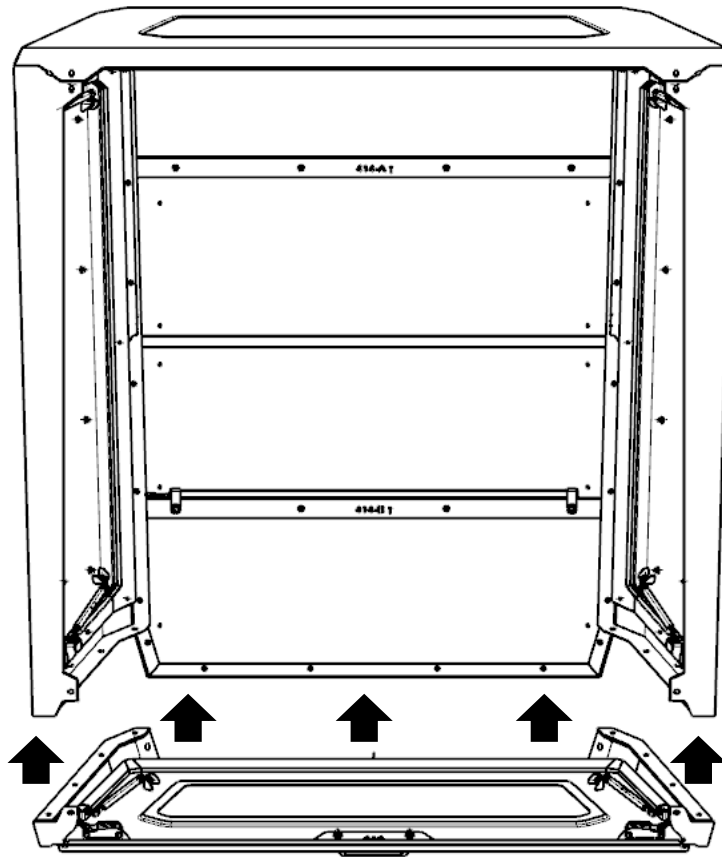

## STEP 7

Adjust the gap of each panel ensuring the bolt holes / panels are aligned. Tighten hardware. The same method will be used for the opposite side.

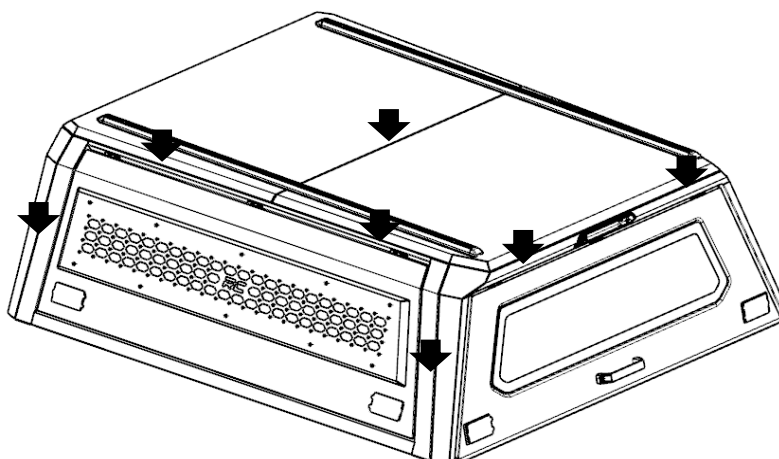

Align all panels

# INSTALLATION INSTRUCTIONS

➡ Tighten the (16) bolts of the bed cap then proceed to the top panel hardware.

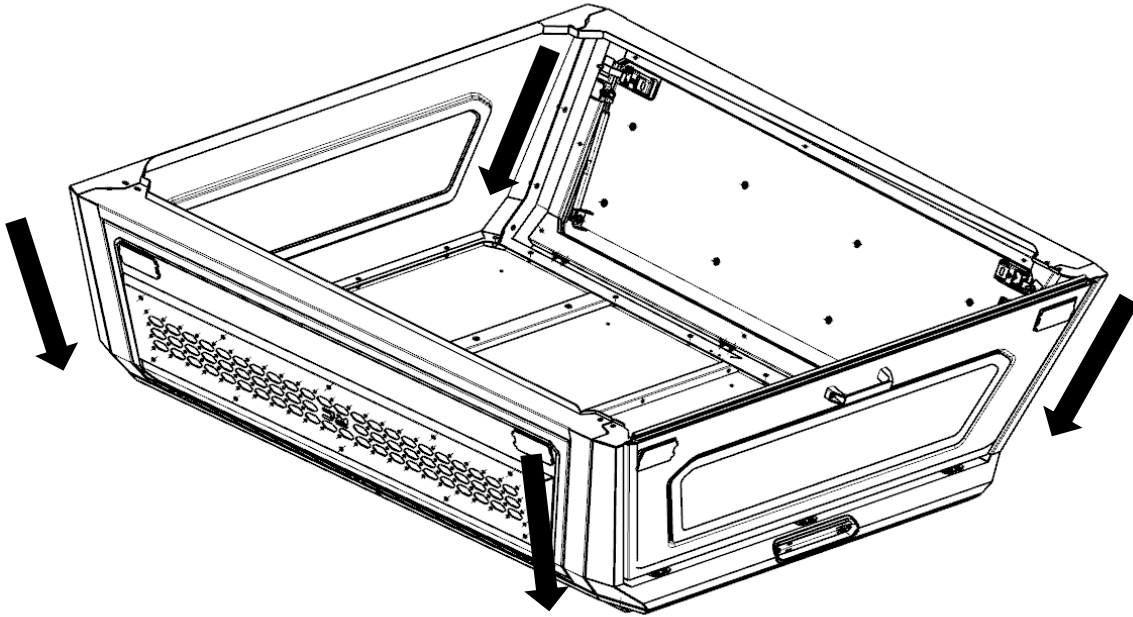

➡ Tighten (24) bolts of top panel as shown below.

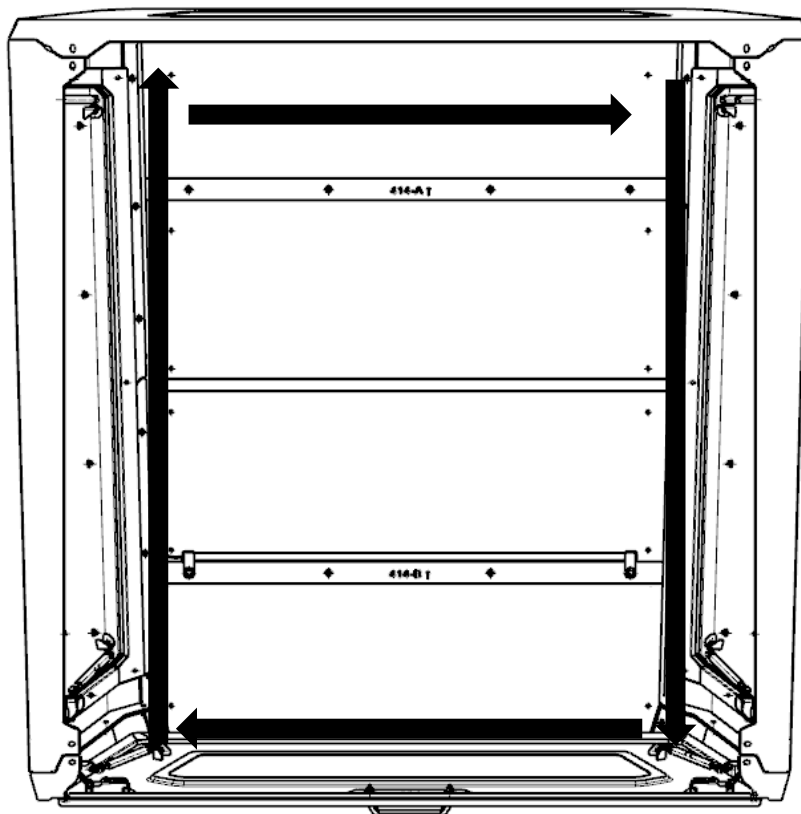



## STEP 8

Wipe and clean the bottom of the bed cap. Apply adhesive promoter evenly around the area where the Sealing strip needs to be applied, Apply the Sealing Strip to the bottom paying attention to the location and orientation of the stip. See below.



REAR FLANGE

**CORRECT D-RUBBER ORIENTATION**

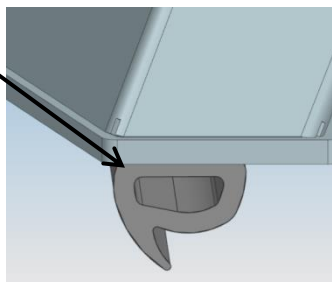

REAR FLANGE

**INCORRECT D-RUBBER ORIENTATION**

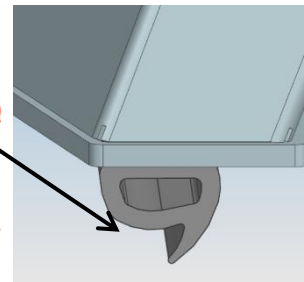



## STEP 9

Place the short pads along the inside of the sealing strip previously installed at the indicated locations. This is performed to give the bed cap a firm location to rest and protect the bed of the vehicle.

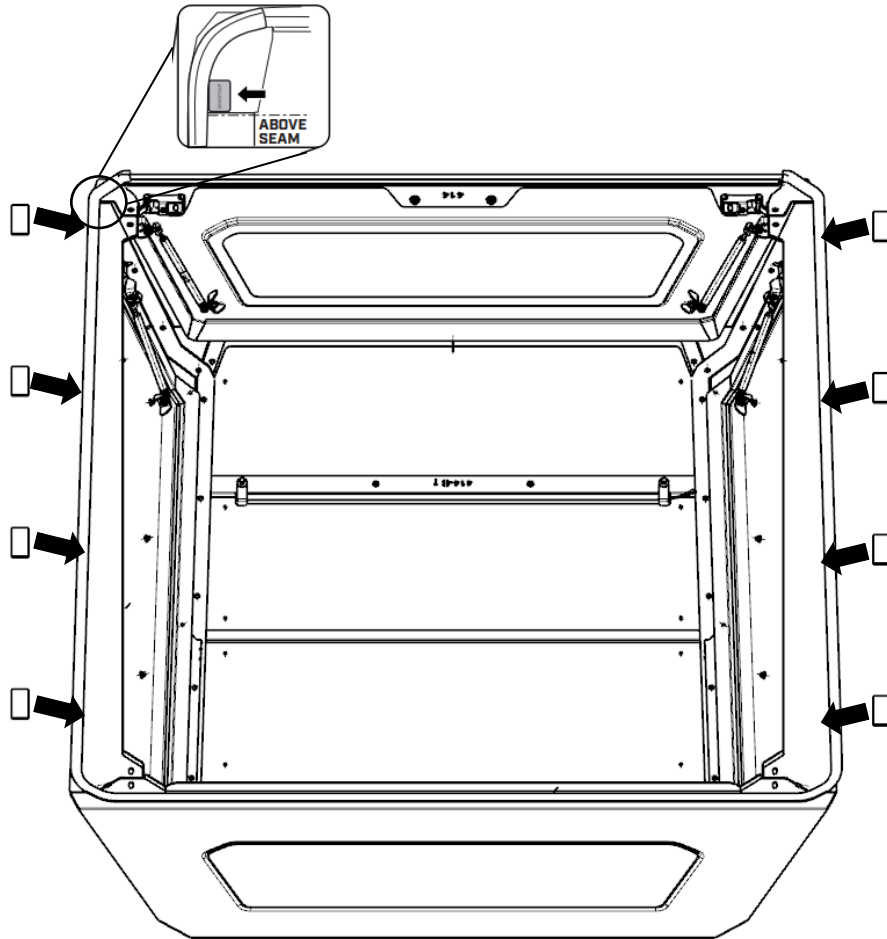

## STEP 10

Apply the Foam Seal Tape to the top of the bulkhead on the truck bed and trim any excess if needed.

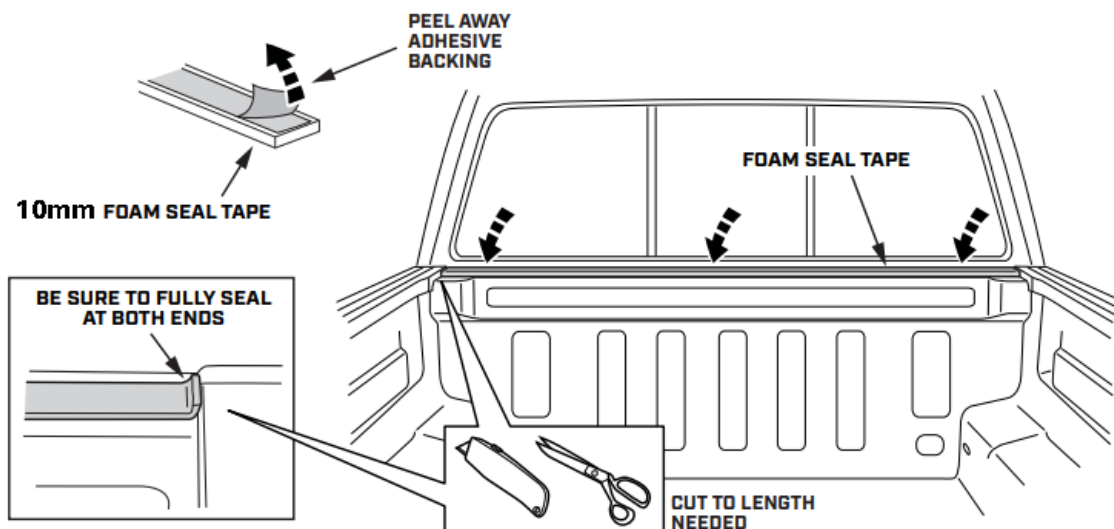

● **Mounting brackets and hardware**

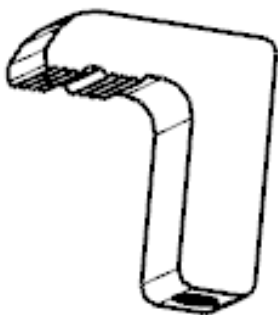

**Upper Brackets x8**

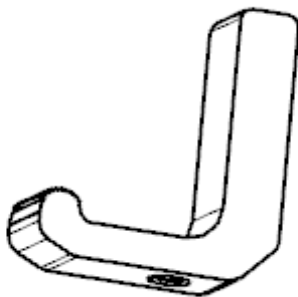

**Bottom Brackets (fit for utility rail equipped vehicle only) x8**

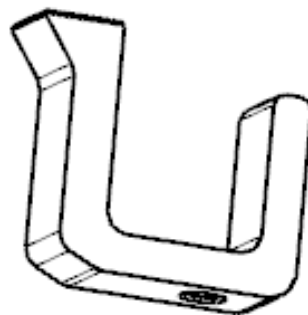

**Bottom Brackets (fit for non-utility rail equipped vehicle only) x6**



**10mm Flat Washers x8**

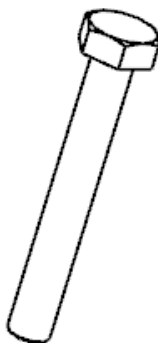

**10mmx70mm Hex Bolts x8**

● **Tools**



**Ratchet**



**13mm**



**13mm**



**S4**

## STEP 11

It is recommended to use four people to lift the assembled bed cap onto the bed of the vehicle. To avoid damaging the bottom sealing strip, do not slide the bed cap lid into position.

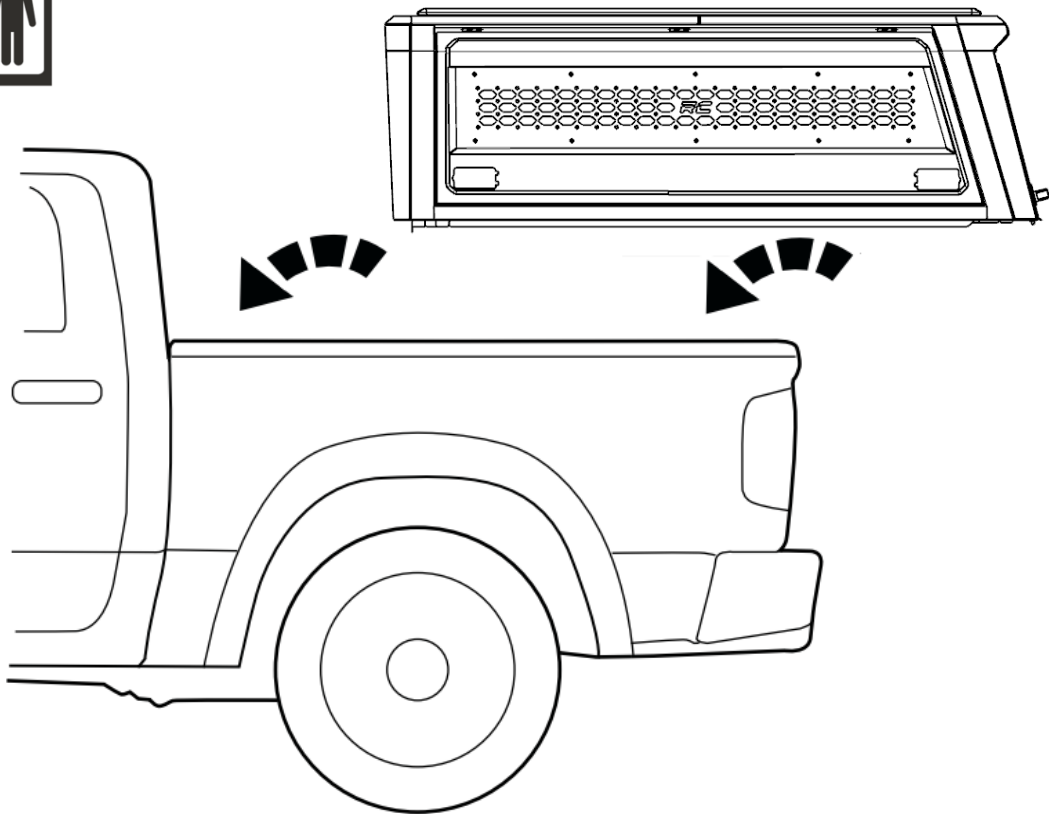

## STEP 12

Check the position of the bed cap with the vehicle and center if needed. Do NOT slide the bed cap as that could cause damage to the lower seal. Please note that there should be a gap of 20mm or more between the bed cap and the cab. Do NOT push the bed cap too close to the cab.

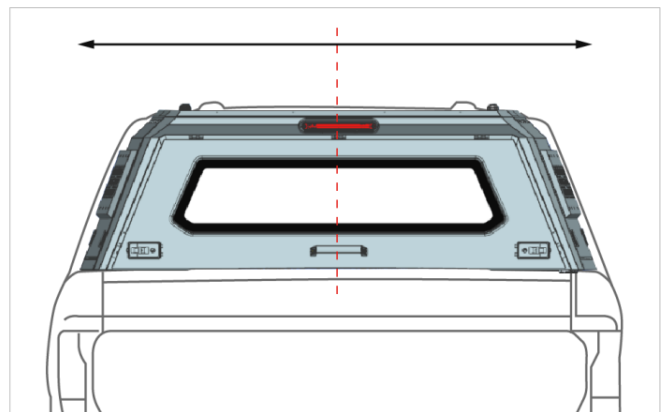
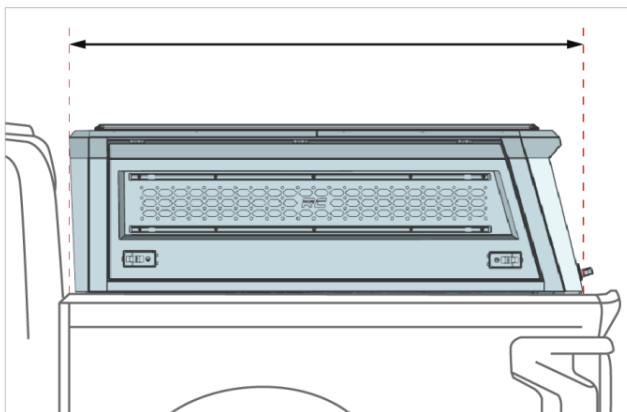

## STEP 13

Walk around the bed cap and bed to ensure that the bottom seal strip is installed correctly and the strip is properly inserted under the bed cap.

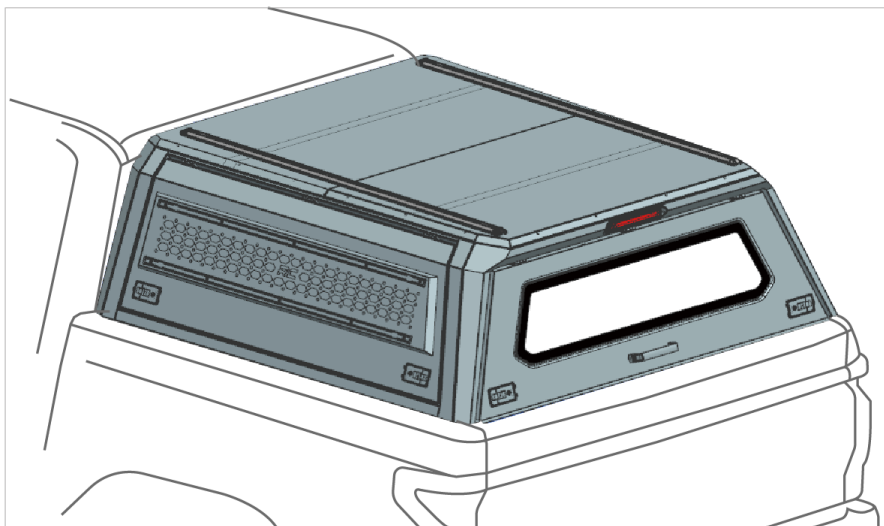

## STEP 14

For the vehicles equipped with the factory utility rail, there will be (8) Bottom Brackets (fit for utility rail equipped vehicle only) and (8) Upper Brackets required (Fig.1).

For the vehicles without the factory utility rail, there will be (6) Bottom Brackets (fit for non- utility rail equipped vehicle only) and (6) Upper Brackets required (Fig.2).

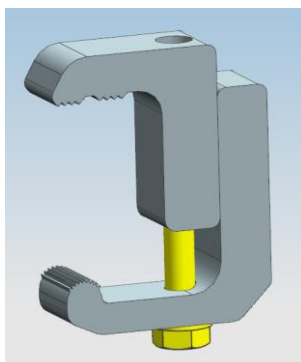

Fig.1

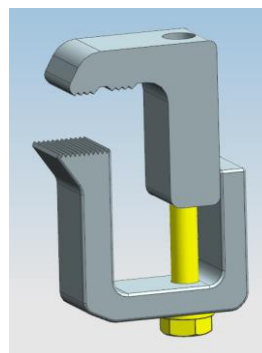
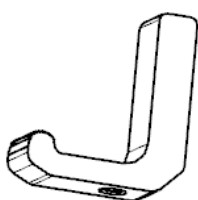

Fig.2

Installation Components: For the vehicles equipped with the factory utility rail.



Upper Brackets x8



Bottom Brackets (fit for utility rail equipped vehicle only) x8



10mm Flat Washers x8

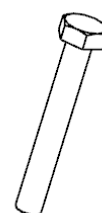

10mmx70mm Hex Bolts x8

# INSTALLATION INSTRUCTIONS

First, use hardware kits as shown in Fig. 3 to assemble the upper and bottom brackets, do not tighten the hardware. Then, as shown in Fig. 4, clamp the serrated part of the lower bracket into the factory utility rail, place the serrated part of the upper bracket on the bottom surface of the cap, and slightly tighten the bolts by hand to ensure that the bed cover clamps do not fall off. After that, use a tool to fully tighten the bolts until the bed cover clamps are stable and secure. Install two bed cover clamps on the front frame door, and three bed cover clamps on each of the two side doors.

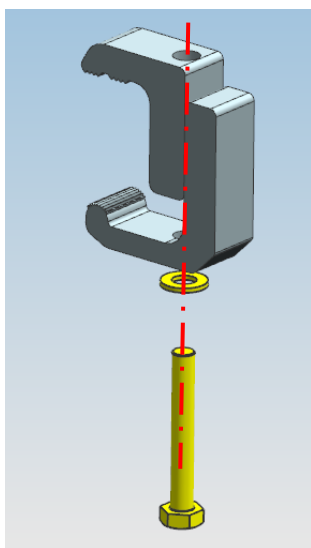

**Fig.3**

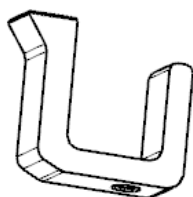

**Fig.4**

Installation Components: For the vehicles without the factory utility rail.



**Upper Brackets x8**



**Bottom Brackets (fit for non-utility rail equipped vehicle only) x6**



**10mm Flat Washers x6**

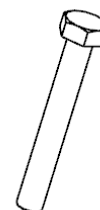

**10mmx70mm Hex Bolts x8**

First, use hardware kits as shown in Fig. 3 to assemble the upper and bottom brackets, do not tighten the hardware. Then, as shown in Fig. 4, clamp the serrated part of the lower bracket into the factory utility rail, place the serrated part of the upper bracket on the bottom surface of the cap, and slightly tighten the bolts by hand to ensure that the bed cover clamps do not fall off. After that, use a tool to fully tighten the bolts until the bed cover clamps are stable and secure. For the vehicles without the factory utility rail, only install three bed cover clamps on each of the two side doors, and no bed cover clamps are needed on the front frame door.

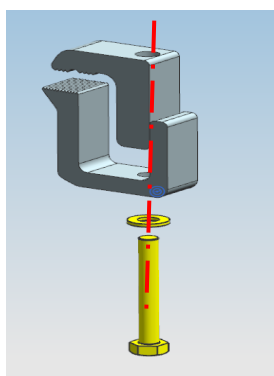

**Fig.5**

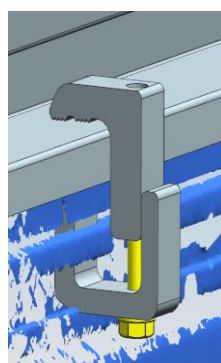
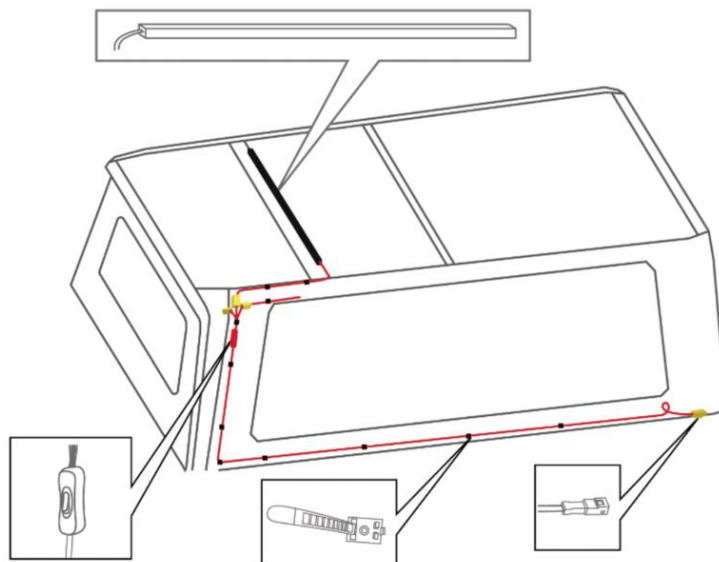
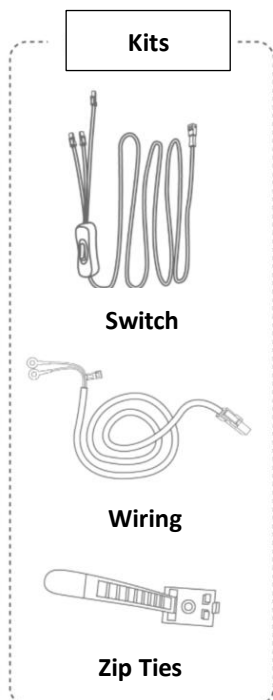

**Fig.6**



## STEP 15

Peel off the backing on the adhesive back of the switch and position the switch onto the bed cap panel. Using zip ties, secure the wire onto the bed cap.



## STEP 16

There are three plugs connected together on the switch. Connect the plug with the House label on the wire to the plug of the light strip. The other two plugs are for the optional side shelf unit and side storage unit with molle panel.

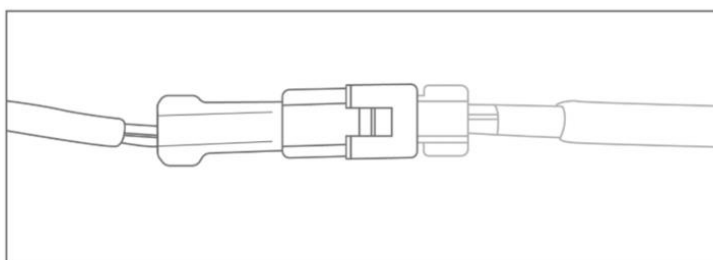
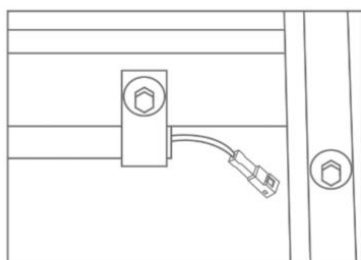

## STEP 17

Connect the plug on the wiring to the separate plug on the switch, then route the wiring from the rear of the vehicle along the bottom of the vehicle taking care to route away from excessive heat and moving components. Route to the battery position or other 12-volt source on the vehicle. Connect the positive and negative of the wiring to the positive and negative terminals of the battery or 12-volt source. (See Next Page)



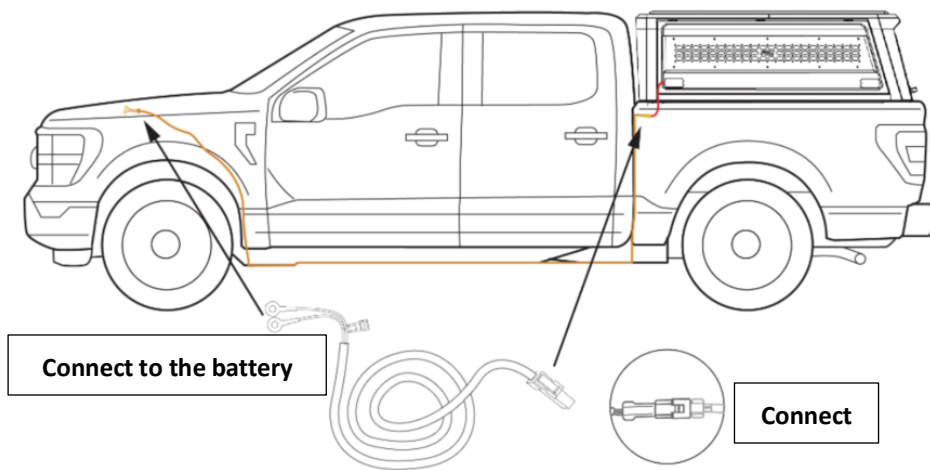

## STEP 18

Route the wiring down the side of the bed cap and into the hole in the bed as shown below to the middle of the bed near the tailgate. Route the harness through the cover as shown and into the tailgate.



Remove the plate on the tailgate and locate the brake light wiring harness. It will be a white wire with green stripe and a black wire.

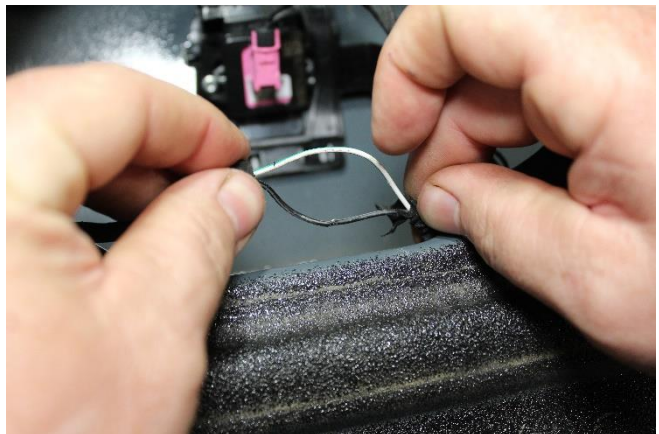

Splice the red wire from the bed cap light harness into the White/green wire and the black into the black wire using the supplied butt connectors. Tuck the harness back in the tailgate, reinstall the plate previously removed and position the cover back in place on the bed.



## INSTALLATION INSTRUCTIONS



By purchasing any item sold by Rough Country, LLC, the buyer expressly warrants that he/she is in compliance with all applicable, State, and Local laws and regulations regarding the purchase, ownership, and use of the item. It shall be the buyer's responsibility to comply with all Federal, State and Local laws governing the sales of any items listed, illustrated or sold. The buyer expressly agrees to indemnify and hold harmless Rough Country, LLC for all claims resulting directly or indirectly from the purchase, ownership, or use of the items.