

PRODUCT: TRANSMISSION SKID PLATE

APPLICATION: FORD F-150 (2014-2020, 2020-Present)
FORD F-150 TREMOR (2021-Present)

PART NO: 2333.1857.2.6

UP-TO-DATE
MANUAL



CAUTION!

To reduce the risk of serious injury or damage to property: Before you start installing and using this product, read the full instructions, pay special attention to the conditions of safe use and recommendations for installation! When installing or maintaining this product, it is necessary to use protective goggles. Check the integrity of the installed components and torque all hardware every 250 miles (400 kms). Discontinue use if there is any damage to the structure or fasteners!

NOTICE

Skid plates are supplemental protection. We cannot guarantee protection against all possible damage from impacts. When driving, be careful of objects and terrain that may damage sensitive parts of the vehicle.

TRANSMISSION SKID PLATE

RIVAL

Part number: 2333.1857.2.6

Suited to vehicle: FORD F-150 3.5 EcoBoost, 3.5 PowerBoost,
5.0; AT; 4WD (2014-2020, 2020-Present);
FORD F-150 TREMOR 5.0; AT; 4WD (2021-Present)



Material: Aluminum

SAFETY NOTICE

- * The RIVAL skid plate is designed to complement the use and design of the specified vehicle under conditions underlined by the vehicle manufacturer.
- * While driving the vehicle at any speed, collision with another vehicle, animal or object must always be avoided.
- * Following any collision with another vehicle, animal or object, the RIVAL skid plate and the vehicle must be inspected by a specialized or suitably qualified vehicle technician for possible damage to the components and assemblies in order to confirm suitability for further use of the vehicle.
- * It is strongly recommended that you do not operate a vehicle with a damaged skid plate or its components. In the case of damage, please contact the nearest RIVAL dealer. A damaged vehicle or skid plate is extremely dangerous and should be avoided at all cost.
- * If applicable, we recommend using a funnel when changing the oil to prevent spills and ensure a clean process.

INSTALLATION NOTICE

- * The RIVAL skid plate must be mounted to the vehicle according to this installation manual.
- * Personal safety during the installation process must be adhered to at all times.
- * Do not install this skid plate on vehicle models other than those listed in this manual.
- * We recommend using blue threadlocker on all hardware
- * Estimated time for installation: 1 hour.

REQUIRED TOOLS

- * Basic tool kit
- * Torque wrench

TORQUE SETTING

- * M10 - 47 N·m (34.7 lb/ft)

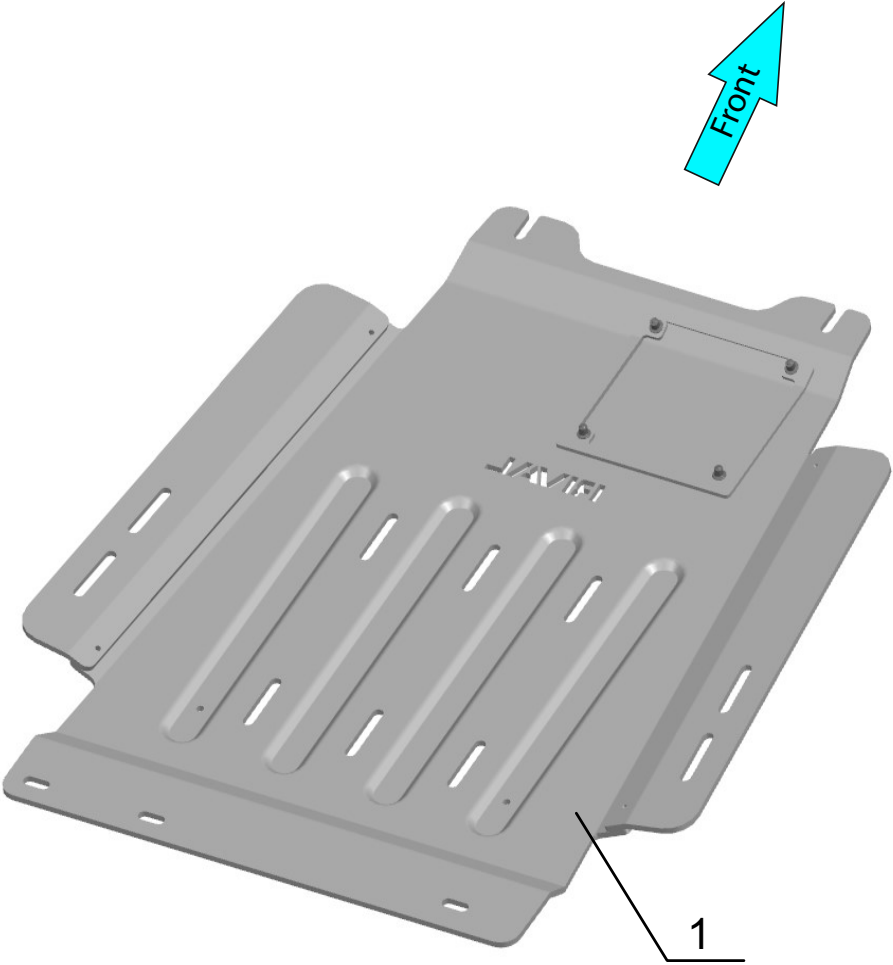

1. Skid plate.....Qty 1

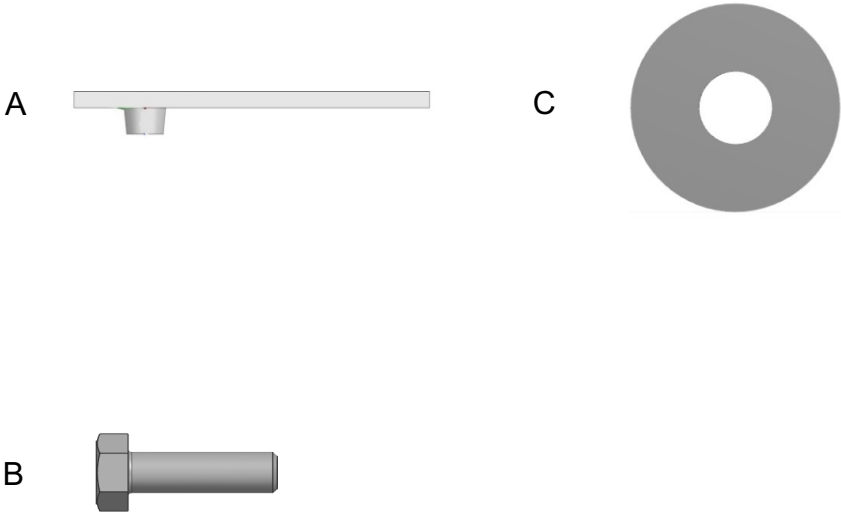

- A. Insert nut M10.....Qty 5
- B. Bolt M10x1.5x35.....Qty 5
- C. Flat washer M10.....Qty 5

SPARE PARTS

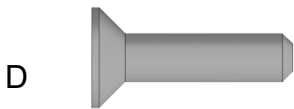

- D. Countersunk bolt M6x1x20.....Qty 4

INSTALLATION PROCEDURE

RIVAL

*If equipped, remove factory or any aftermarket skid plates that might interfere with installation.

If RIVAL engine skid plate is installed, skip steps 1 and 2.

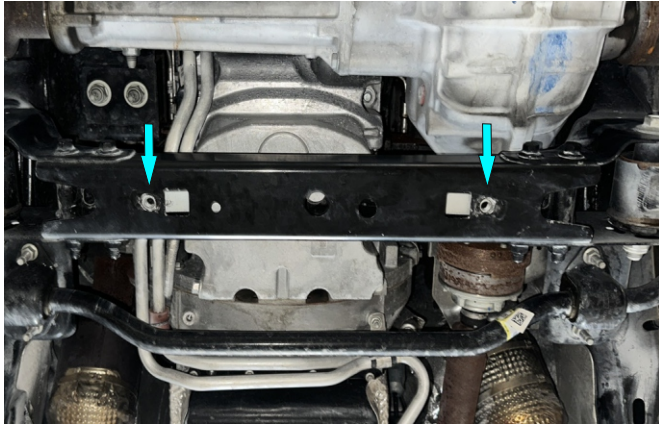

Fig. 1

1. Remove factory clip nuts and install M10 insert nuts (item A) as shown in fig.1.

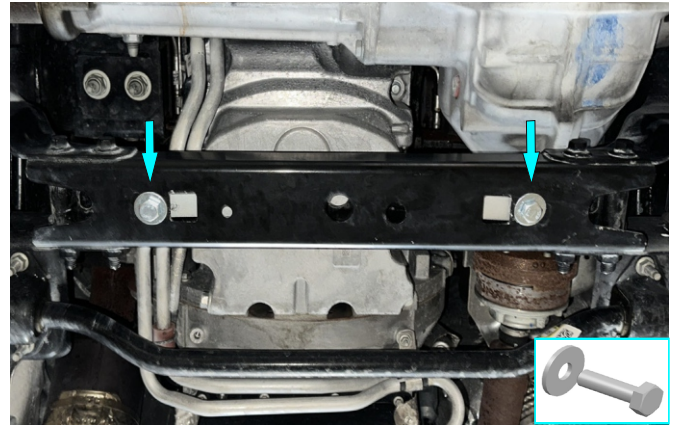

Fig. 2

2. Loosely install M10x35 bolts with M10 flat washers (item B, C) as shown in fig.2. At this point only thread bolt in 2-3 turns.

***Do not tighten yet.**

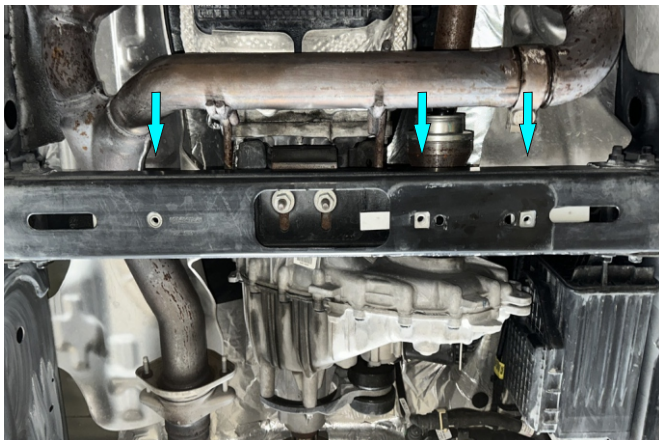

Fig. 3

3. Remove factory clip nuts and install M10 insert nuts (item A) as shown in fig.3.

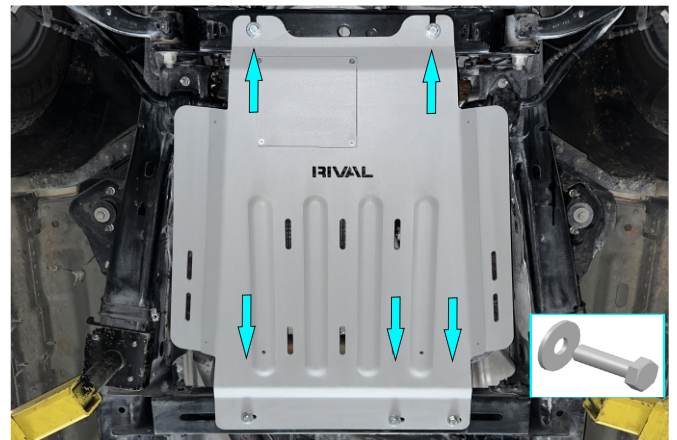

Fig. 4

4.1 If the RIVAL engine skid plate is installed: loosen the rear engine skid plate bolts, slide the transmission skid plate over it and secure the rear of the transmission skid plate using M10x35 bolts and M10 flat washers (item B, C) as shown in fig.4.

4.2 If not, slide the front of the skid plate (item 1) over hardware installed in step 2 and secure the rear of the skid plate using M10x35 bolts and M10 flat washers (item B, C) as shown in fig.4.

***Torque all hardware.**

Before operating a vehicle fitted with RIVAL Skid Plate:

- Make sure all fittings are properly torqued.
- Ensure the integrity of the structure and its components.

