

ROUGH COUNTRY

SUSPENSION SYSTEMS®

921430200



WARNING: This product contains a chemical known to the State of California to cause Cancer and Reproductive Harm. For more information, go to www.P65Warnings.ca.gov.

2019-UP MERCEDES SPRINTER VAN (VS30) REAR WHEEL WELL LINER

PLEASE READ INSTRUCTIONS CAREFULLY BEFORE STARTING THE INSTALLATION.

NOTE: FOR EASIER INSTALLATION, REMOVE THE TIRE.

INCLUDED IN HARDWARE KIT:

1.



Driver Side & Passenger
Side Liner
1 pr

2.



Pinch Clip "A"
4 pcs

3.



Pinch Clip "B"
4 pcs

4.



Truss Head Screw
4 pcs

5.



Bracket
2 pcs

6.



M6 Body Clip
2 pcs

7.



#12 Self-Tapping Screw
6 pcs

8.



M6 x 20 BHCS
2 pcs

9.



M6 Washer
2 pcs

TOOLS NEEDED:

T-25 Torx Bit
10mm Socket
Gloves
Phillips Screwdriver
Drill with Phillips Bit
Putty Knife or Scraper

Grease Pencil
Pry Tool
Pliers (optional)
Utility Knife
4mm Allen Wrench

PREPARATIONS:

Please clean the interior panels of the rear wheel well prior to installation.

If vehicle comes equipped with factory wheel well liners, these will need to be removed, along with any fasteners involved.

REAR WHEEL WELL LINER INSTALLATION



Using a T-25 Torx Bit, remove and retain 2 factory bolts holding mud flap to vehicle. The mud flap will be reinstalled.



Use a 10mm Socket to remove 1 bolt from underside of mud flap under vehicle. Retain this bolt.



Remove mud flap and use a utility knife to cut along marked dotted line. Discard the cut pieces and keep the mud flap for reinstallation later.



Slide the Rear Wheel Well Liner behind wheel. It is helpful to tilt the liner at a 45-degree angle at front of wheel and then straighten it out once it's behind the wheel.



Tuck Rear Wheel Well Liner under metal fender lip at all outward facing edges. Use a plastic pry tool to assist in tucking the wheel well liner in place if needed.

NOTE: Use gloves to protect your hands.



Using a grease pencil, mark 2 hole locations – make sure to mark through to the sheet metal geometry behind the wheel well liner.



2 hole locations. Once holes are marked, remove the Wheel Well Liner.

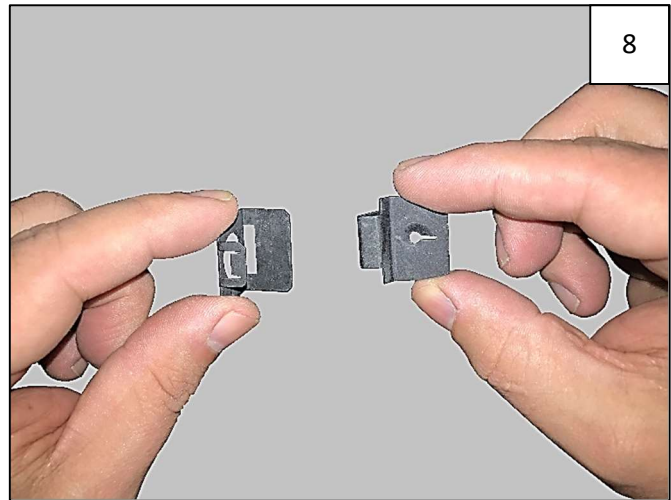

Assemble Pinch Clip "A" and Pinch Clip "B" as shown. Do NOT pinch down to engage clips at this time.

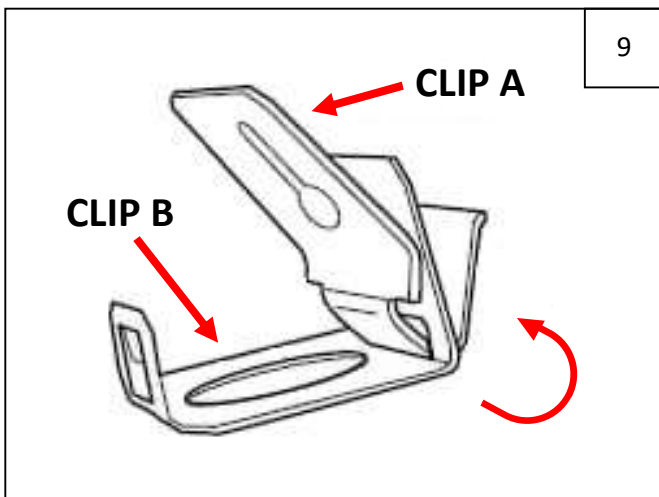

Pinch Clip assembly detail.



Carefully position a Pinch Clip combo over the lower forwardmost mark made in Step 6. Squeeze the 2 Pinch Clip pieces shut on metal seam until they snap together. Use a pair of pliers to snap the clips if needed.



For the topmost hole, orient the clip on the sheet metal seam as shown. Squeeze the Pinch Clip shut.



Use a putty knife or scraper to remove caulk from both outer faces of factory frame support located at back center of wheel well.



13

Install a supplied M6 Body Clip over each supplied Metal Bracket as shown.



14

Slide bracket over factory frame support.



15

Use a drill with a Phillips Bit to install 2 supplied #12 Self-Tapping Screws through bracket and into sheet metal as shown.



16

Reinstall Wheel Well Liner, tucking edges in once more.



17

Install a supplied Truss Head Screw through 2 holes in liner and into clips installed in Steps 10-11.



18

Slide a supplied M6 Washer onto a supplied M6 x 20 BCHS. Insert washer/bolt combo through hole at rear center of wheel well liner and into bracket clip installed in Step 13, using a 4mm Allen wrench to tighten.



19
Reposition mud flap modified in Step 3 and install 2 T-25 bolts through mud flap and Wheel Well Liner.



20
Reinstall 10mm bolt on underside of mud flap. Tighten all fasteners.

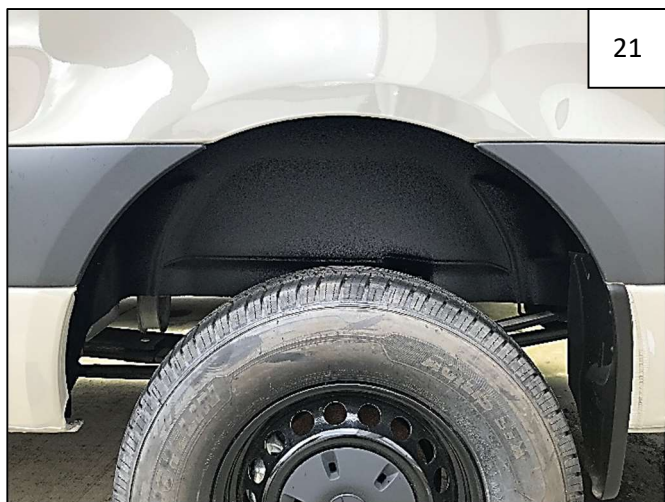

21
Installation is complete. Repeat for other side.