

ROUGH COUNTRY

SUSPENSION SYSTEMS®

921932020

Polaris Xpedition ADV-5-1000 Side Windows

Thank you for choosing Rough Country for all your vehicle needs.

Please read instructions before beginning installation. Check the kit hardware against the kit contents shown below. Be sure you have all needed parts and know where they go.

If question exist, please call us @1-800-222-7023. We will be happy to answer any questions concerning this product.

Check all fasteners for proper torque. Check to ensure for adequate clearance between all components.

Check and retighten wheels at 50 miles and again at 500 miles. Periodically check all hardware for tightness.

KIT CONTENTS:

Front:

- 1- FR DR LWR Bracket
- 1- FR DR UPR Bracket
- 1- RR DR LWR Bracket
- 1- RR DR UPR Bracket
- 1- FR DR Window
- 1-FR DR Window Brace
- 1- FR PASS LWR Bracket
- 1- FR PASS UPR Bracket
- 1- RR PASS LWR Bracket
- 1- RR PASS UPR Bracket
- 1- FR PASS Window
- 1-FR PASS Window Brace

Rear:

- 1- FR DR LWR Bracket
- 1- FR DR UPR Bracket
- 1- RR DR LWR Bracket
- 1- RR DR UPR Bracket
- 1- FR PASS LWR Bracket
- 1- FR PASS UPR Bracket
- 1- RR PASS LWR Bracket
- 1- RR PASS UPR Bracket
- 2- RR Window
- 2-RR Window Brace
- 2-93202 bag1
- 1-12' Rubber seal
- 1-13' Rubber seal

TOOLS NEEDED:

- 10mm Wrench or Socket
- 4mm Allen
- T15 Torx
- Flat Screwdriver
- 1/4 drill bit and motor

HARDWARE INCLUDED:

- 12- 6mm-1.0 x 20mm Button Head
- 36- 6mm Flat Washer
- 12- 6mm-1.0 x40mm Button Head
- 20- 6mm-1.0 Nylock Nut

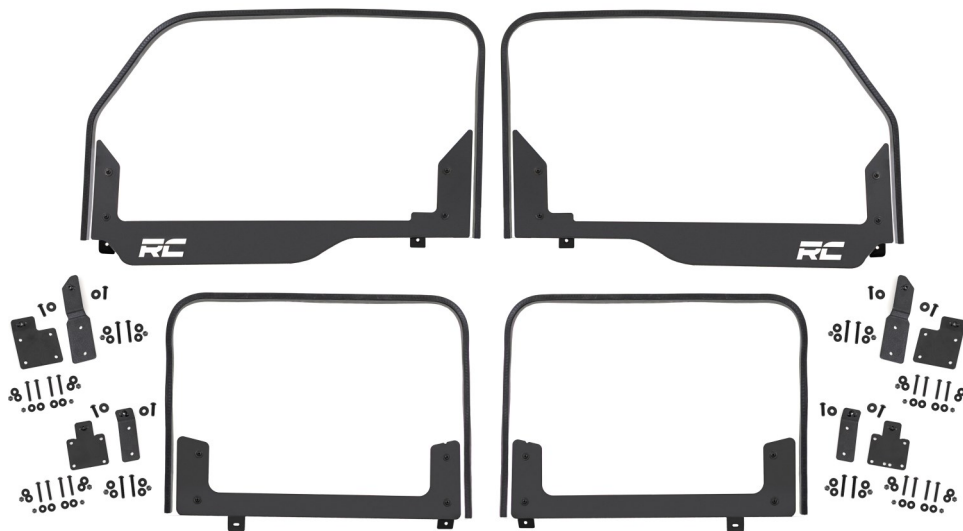

Torque Specs:

| Size | Grade 5 | Grade 8 | Size | Class 8.8 | Class 10.9 |
|-------|-----------|-----------|------|-----------|------------|
| 5/16" | 15 ft/lbs | 20ft/lbs | 6MM | 5ft/lbs | 9ft/lbs |
| 3/8" | 30 ft/lbs | 35ft/lbs | 8MM | 18ft/lbs | 23ft/lbs |
| 7/16" | 45 ft/lbs | 60ft/lbs | 10MM | 32ft/lbs | 45ft/lbs |
| 1/2" | 65 ft/lbs | 90ft/lbs | 12MM | 55ft/lbs | 75ft/lbs |
| 9/16" | 95 ft/lbs | 130ft/lbs | 14MM | 85ft/lbs | 120ft/lbs |
| 5/8" | 135ft/lbs | 175ft/lbs | 16MM | 130ft/lbs | 165ft/lbs |
| 3/4" | 185ft/lbs | 280ft/lbs | 18MM | 170ft/lbs | 240ft/lbs |



INSTALLATION INSTRUCTIONS

1. Pry out plastic push pins holding trim using a flat head screw driver and retain. See Photo 1.
2. Remove trim. See Photo 2.

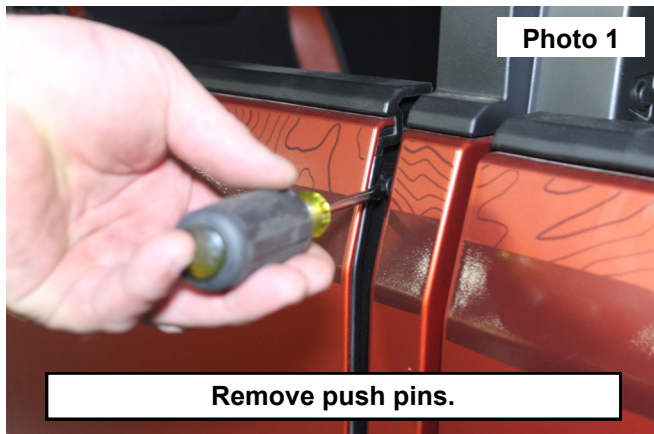

3. With 4mm allen wrench, remove bolts holding inner panel. See Photo 3.
4. Pry cap off door handle using flat head screwdriver. See Photo 4.

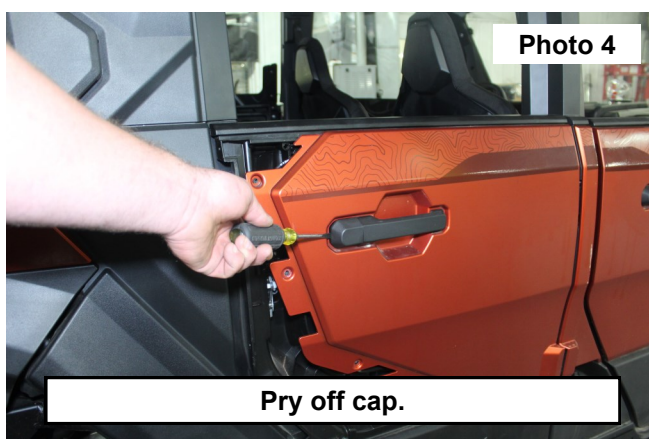

5. Using T-15 bit, remove door handle. See Photo 5.
6. Remove outer door panel. See Photo 6.

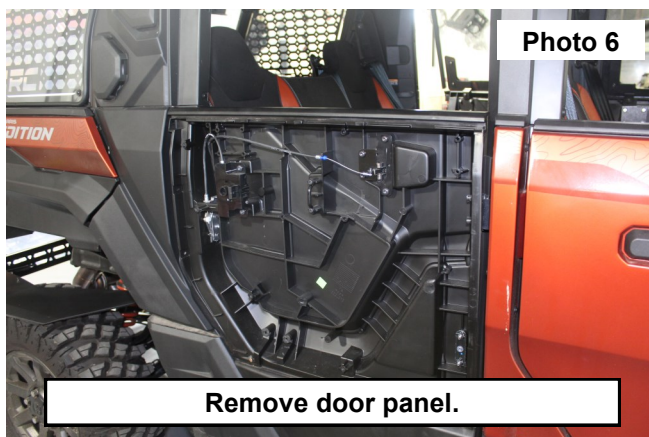

7. With 1/4 bit, drill 4 holes at the rear of panel. See Photo 7.
8. Continue drilling 2 holes at the front of panel. See Photo 8.

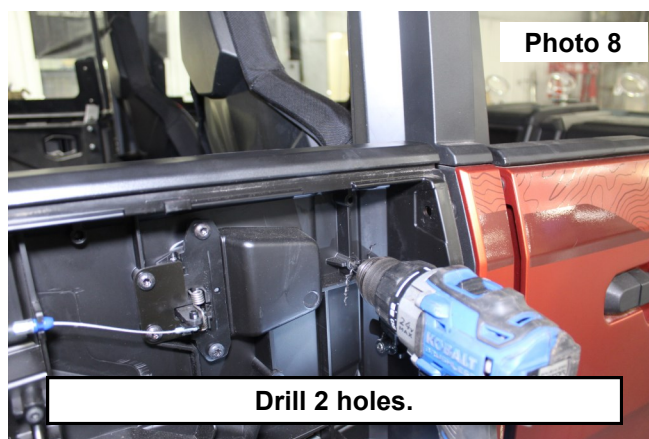
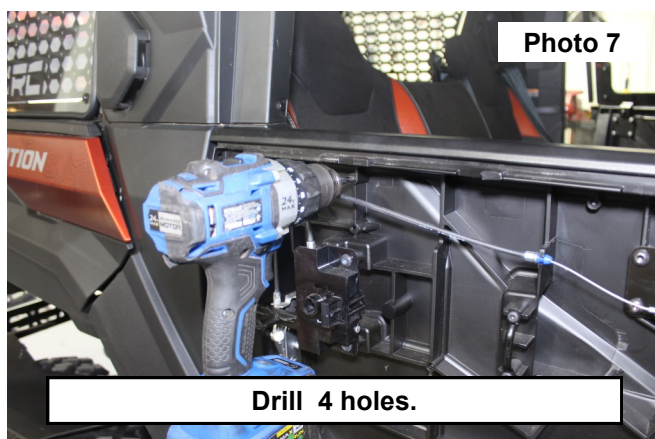

9. Using a 10mm socket, install 4 rear lower bracket. See Photo 9.
10. Install front lower bracket with 10mm socket. See Photo 10.

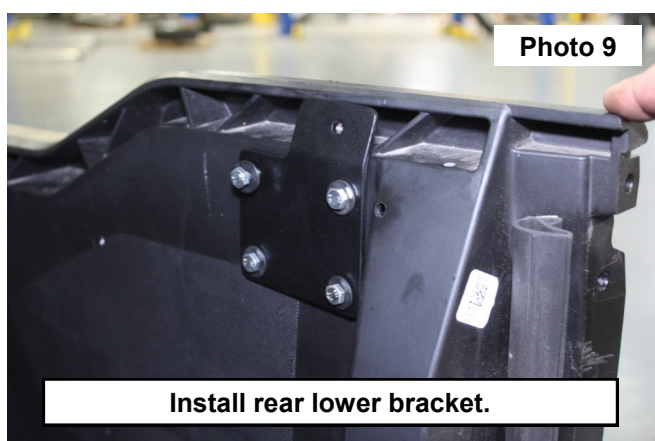

11. Install rubber seal around window, and loosely attach window brace. See Photo 11.
12. Flip window, and install and tighten rear upper bracket using a 4mm allen socket. See Photo 12.

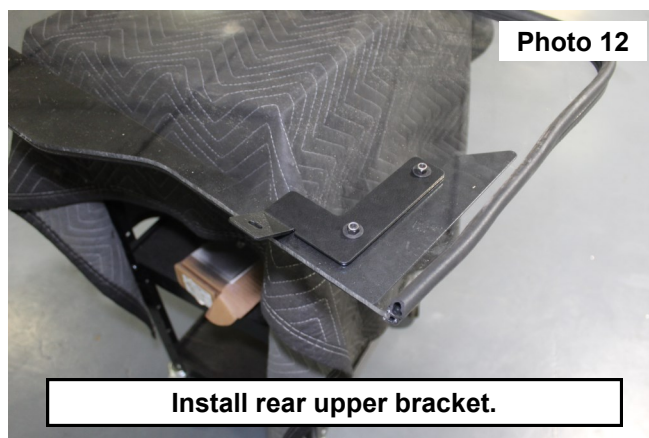

13. Install and tighten front upper bracket using a 4mm allen socket. See Photo 13.
14. Secure rear lower bracket to rear upper bracket using a 4mm allen wrench. See Photo 14.

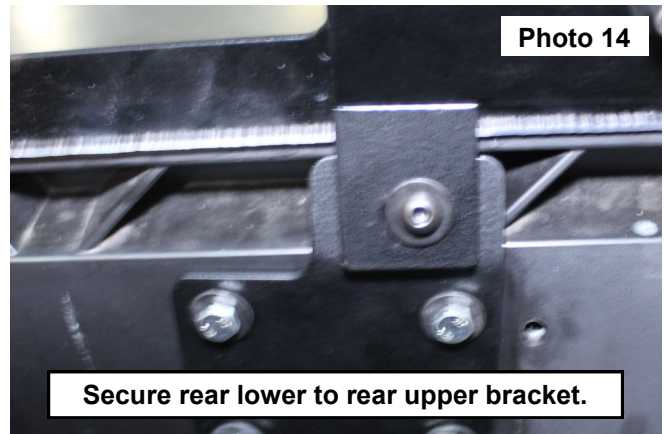
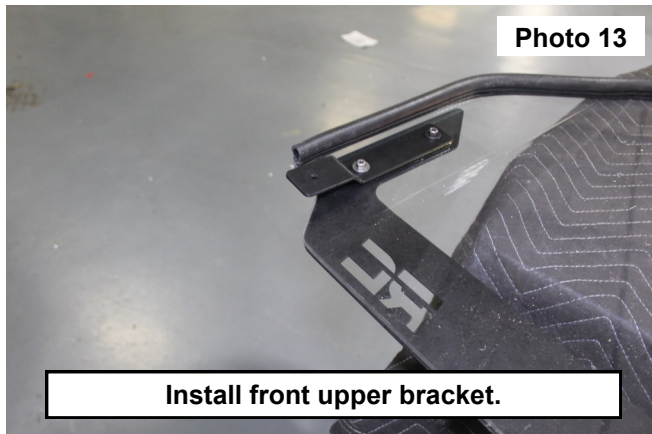

15. Secure front lower bracket to front upper bracket using a 4mm allen wrench. See Photo 15.
16. Reinstall outer door panel and trim, and repeat steps 1-15 for other doors. See Photo 16

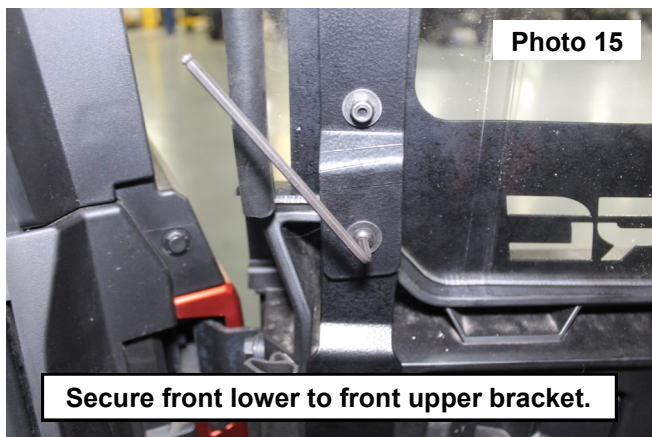

By purchasing any item sold by Rough Country, LLC, the buyer expressly warrants that he/she is in compliance with all applicable, State, and Local laws and regulations regarding the purchase, ownership, and use of the item. It shall be the buyers responsibility to comply with all Federal, State and Local laws governing the sales of any items listed, illustrated or sold. The buyer expressly agrees to indemnify and hold harmless Rough Country, LLC for all claims resulting directly or indirectly from the purchase, ownership, or use of the items.

