



2024 - Up Landcruiser Hidden Winch

Thank you for choosing Rough Country for all of your suspension needs.

Rough Country recommends that a certified technician install this system. In addition to these instructions, professional knowledge of disassemble/reassembly procedures as well as post installation checks must be known. Attempts to install this system without this knowledge and expertise may jeopardize the integrity and/or operating safety of the vehicle. Please read all the instructions before beginning the installation. Check the kit hardware against the "Kit Contents" list below. If question exist, please call us @1-800-222-7023. We will be happy to answer any questions concerning this product. Check all fasteners for proper torque. Check to ensure for adequate clearance between all components. Check and retighten wheels at 50 miles and again at 500 miles. Periodically check all hardware for tightness. Be sure you have all the needed parts and understand where they go. Also, please review the "Tools Needed" list to be certain you have the necessary tools to complete the installation.

NOTICE TO DEALER AND VEHICLE OWNER

⚠ WARNING Any vehicle equipped with any Rough country product must have the "Warning to Driver" decal installed on the sun visor or dash. The decal is to act as a constant reminder for whoever is operating the vehicle of its unique handling characteristics. INSTALLING DEALER—It is your responsibility to install the warning decal and to forward these installation instructions on too the vehicle owner for review and to be kept in the vehicle for its service life.



2024 - Up Landcruiser Hidden Winch

TOOLS NEEDED:

Jack
Safety Stands
Wheel Chocks
Cutting Tool
Sander
Marker
Wrench/Socket
10mm
12mm
17mm
18mm
19mm
3mm Hex Wrench
5mm Hex Wrench
10mm Hex Wrench

KIT CONTENTS:

Winch Tray
Driver Wing
Pass wing
Driver Light Mount
Pass Light Mount
Fairlead Mount
Lower Facia Mount
Fairlead Spacer (2)
Winch Control Extension
Landcruiser Facia

HARDWARE INCLUDED:

Zip Tie (20)
Phillips Screw (2)
12mm x 30mm Bolt (18)
12mm Flange Nut (22)
12mm Washer (18)
12mm x 45mm Socket Bolt (2)
12mm x 35mm Socket Bolt (4)
8mm Button Head Bolt (4)
8mm Washer (4)
8mm Clip Nut (4)
6mm Button Head Bolt (4)
6mm Washer (4)

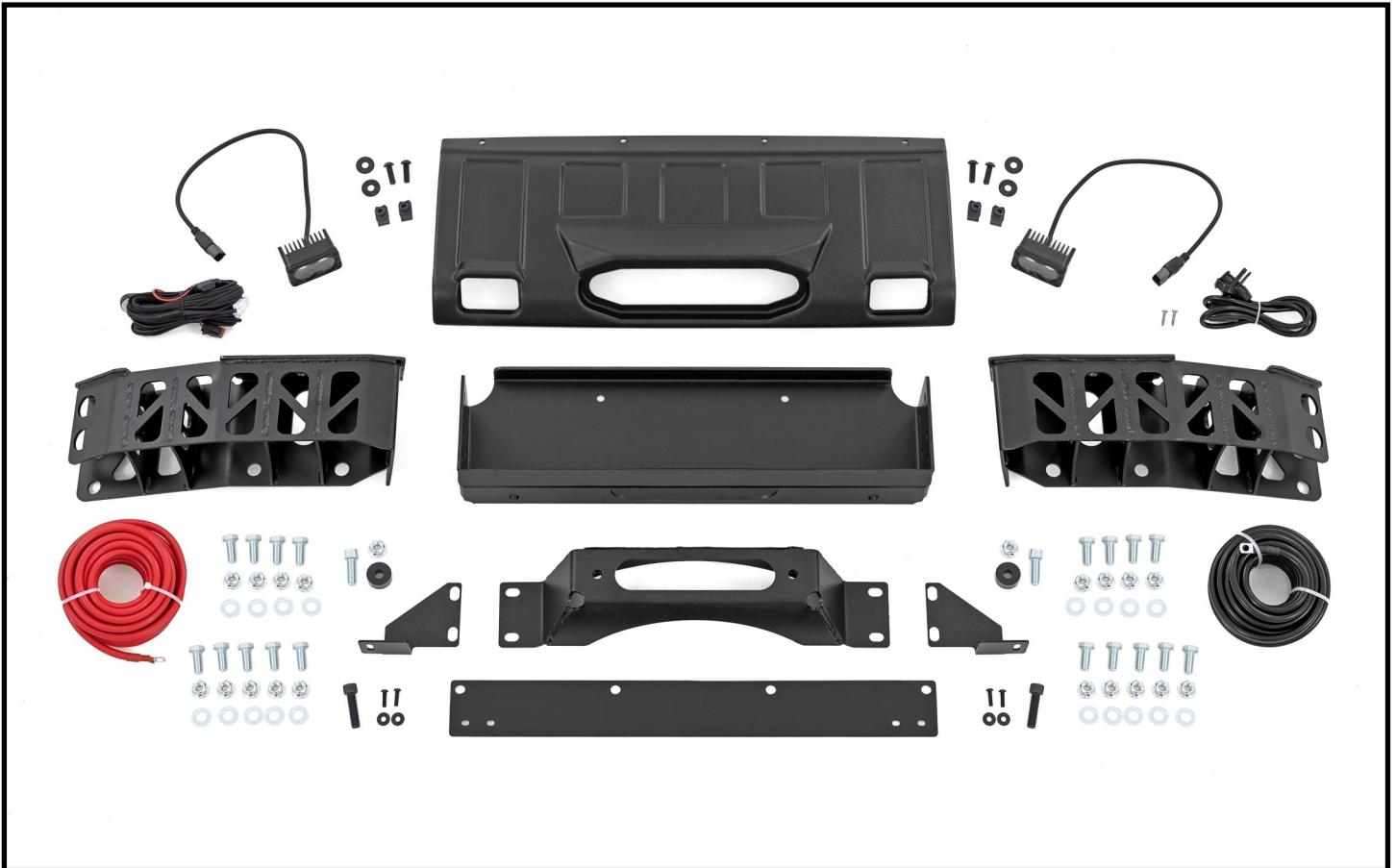

Hidden Winch Installation

1. Park your vehicle on a clean flat surface, engage the parking brake and block the rear tires.
2. **Save all hardware removed from the vehicle unless otherwise noted.**
3. This kit requires full removal and trimming of the front bumper cover. Read through the ENTIRE instruction booklet first to gain understanding of the disassembly and installation process first.
4. Open the hood and remove the upper core support cover by pressing the top of the plastic rivets in with your finger. Then remove the entire plastic rivet using a small pry tool. **Photo 1 / 2**

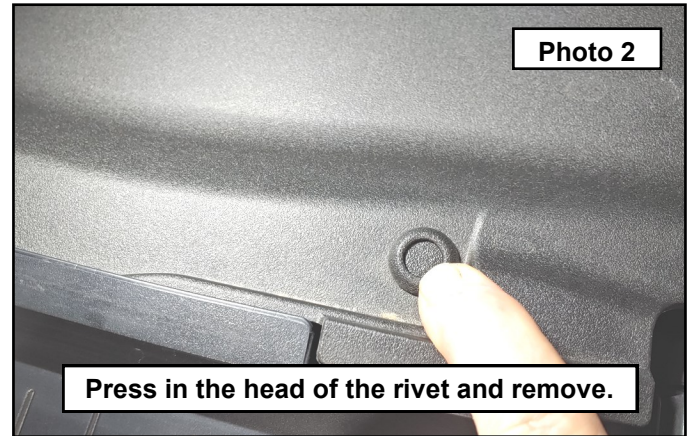

5. Reset the plastic rivet by pushing the center lock back up through the body. **Photo 3**
6. Remove core support cover and set aside. **Photo 4**

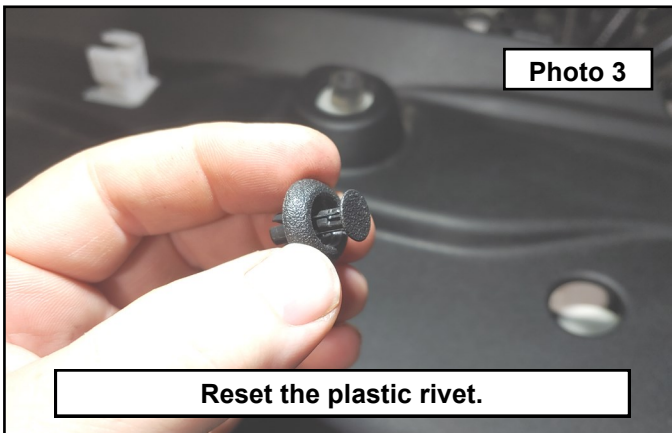

7. Remove the upper grill hardware using a 10mm socket. **Photo 5**
8. Remove the bumper extension using a 10mm socket and pry tool on the plastic rivets in the wheel well. **Photo 6**

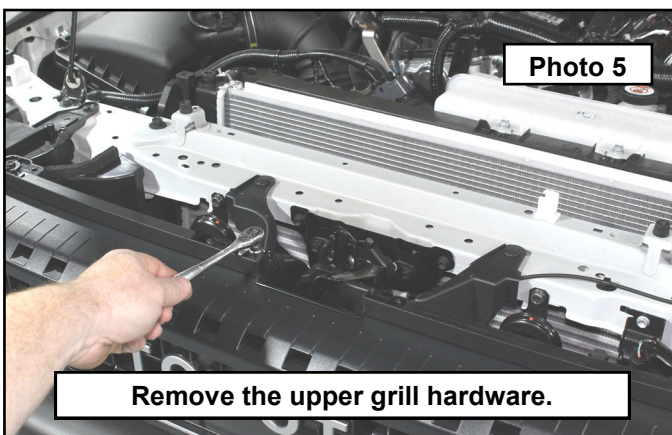

9. Remove the bumper cover to wheel well liner lower hardware using a 10mm socket. **Photo 7**
10. Remove the bumper cover plastic rivets from the skid plate filler panel. **Photo 8**

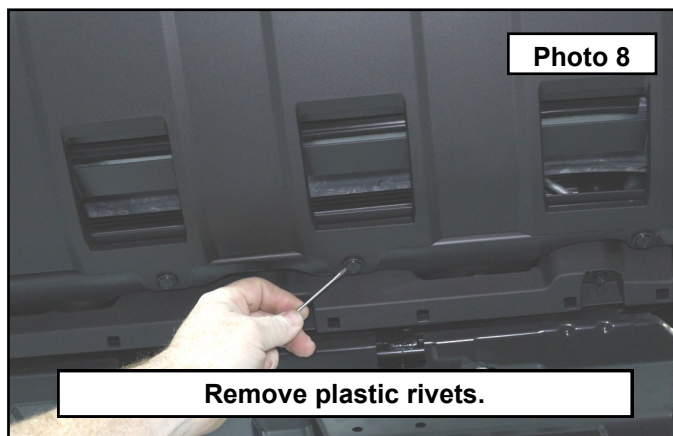

11. Remove the skid plate filler panel hardware using 10mm socket. Remove center plastic rivet. **Photo 9**
12. Remove and discard the plastic filler piece. **Photo 10**

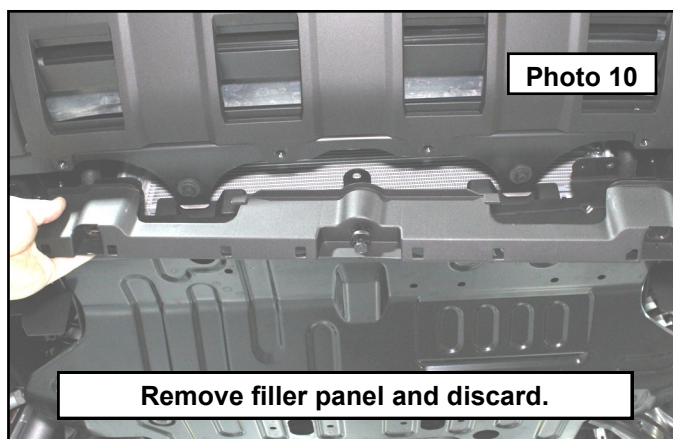
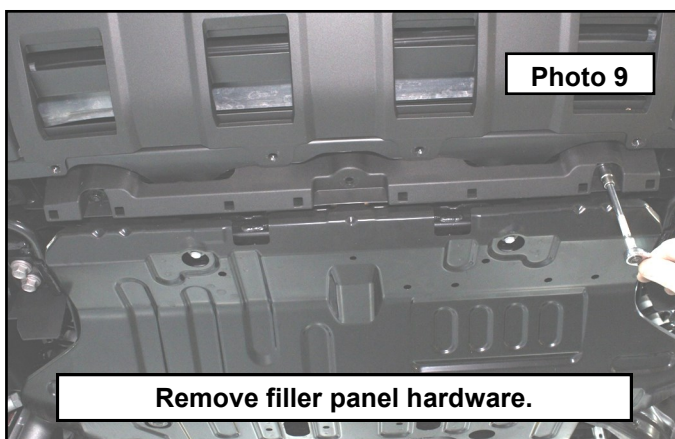

13. Remove lower bumper cover lower hardware using 10mm socket. **Photo 11**
14. Remove bumper cover plastic rivet in the wheel well. **Photo 12**

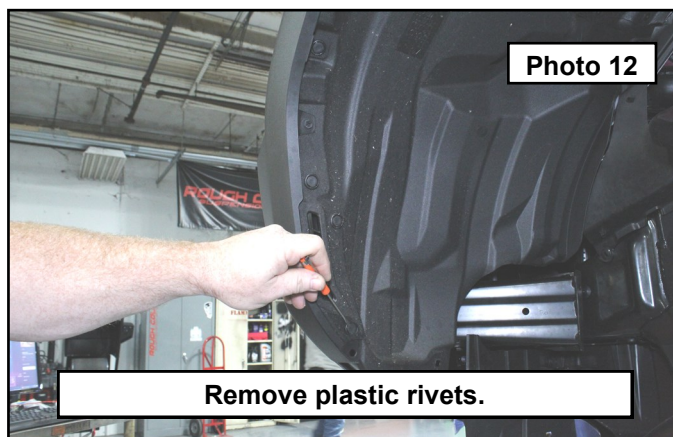
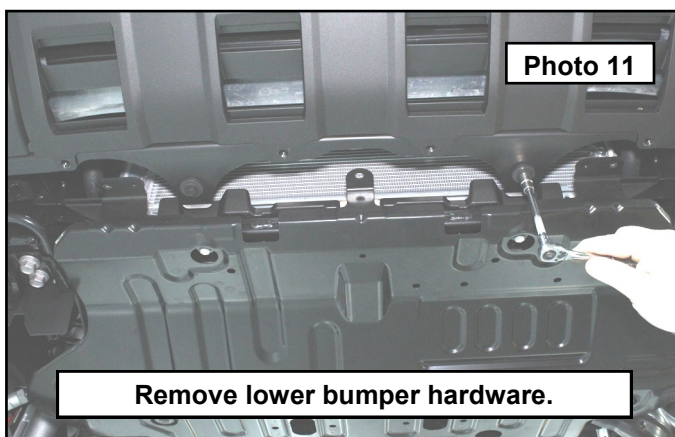

15. Remove bumper cover hardware in wheel well using 10mm socket. **Photo 13**

16. Gently pull out on the fender flare to “pop” the clips out of their mounts. Pull this out far enough to access the bumper cover hidden hardware. **Photo 14**

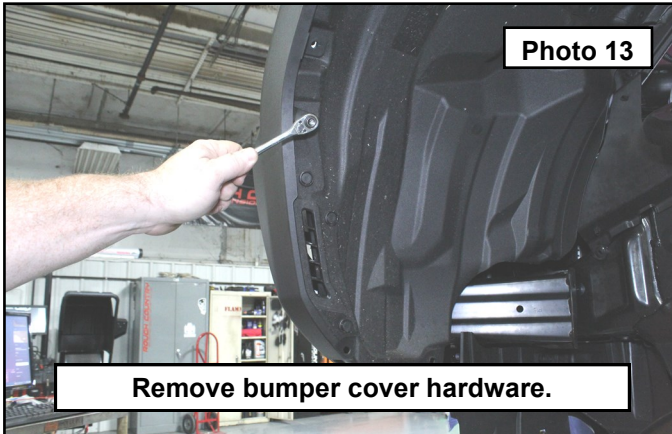

17. Remove the plastic rivet using a pry tool. **Photo 15**

18. Remove the bumper hardware using a 10mm socket. **Photo 16**

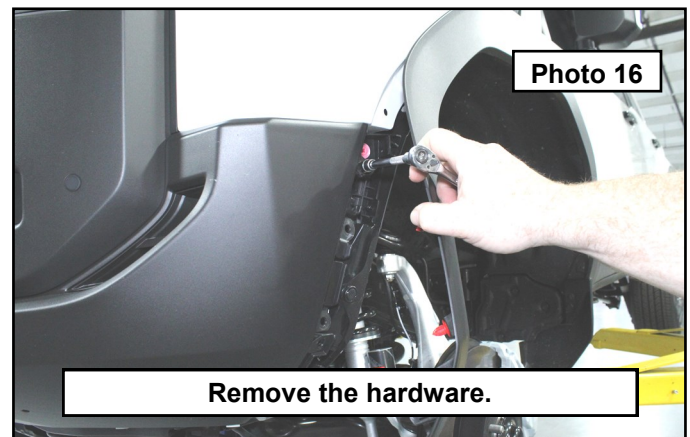
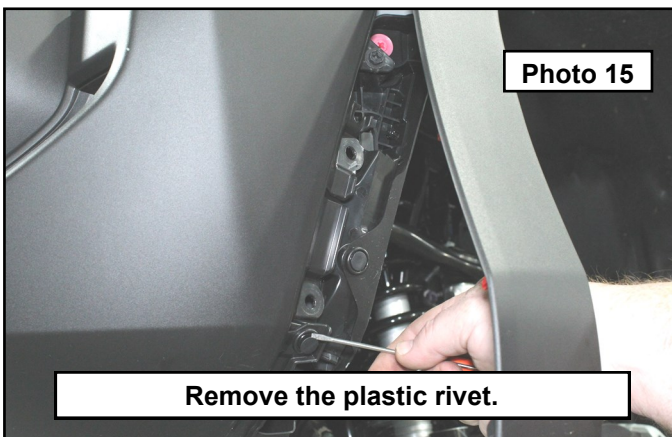

19. In the passenger wheel well, pull back the liner to access the wiring harness. **Photo 17**

20. Remove the connector from its clip and disconnect the harness. **Photo 18**

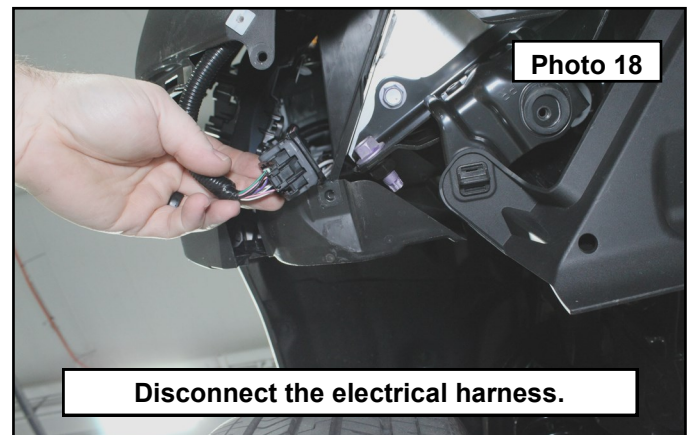

21. Pull out on the bumper cover to release the clips from under the headlights. Lift the grill tabs up and over their respective mounts and pull the entire front fascia away from the vehicle. **Photo 19**
22. Set the fascia aside onto a protected surface. **Photo 20**

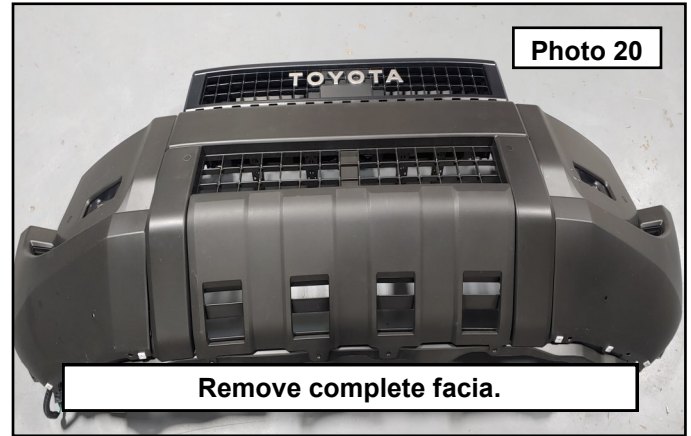

23. Remove the center fascia from the bumper cover following the next steps and discard. The kit comes with a molded replacement cover. **Photo 21**
24. Flip the bumper cover over and locate the screw holding the center section of the outer shell in place. Remove this using a Phillips head driver. **Photo 22**

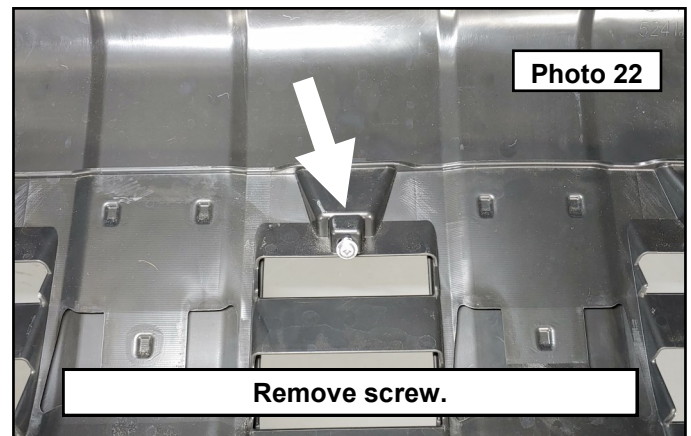
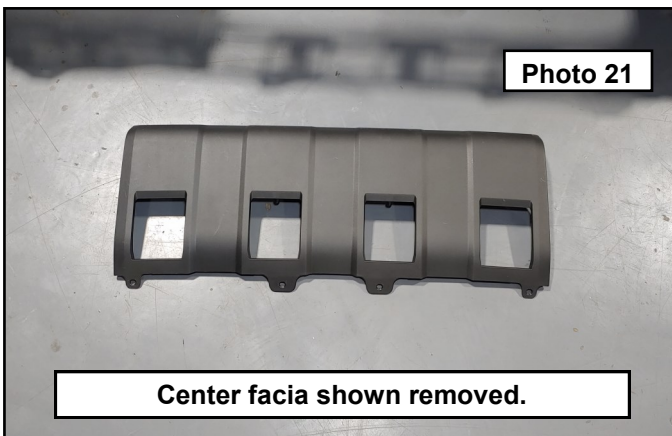

25. Locate the white plastic retainers on the ends of the center fascia and remove by pressing the locking feature in and pulling out from the slot. **Photo 23**
26. Locate the upper clips holding the top of the fascia onto the cover. Release these clips while pulling the center fascia away from the bumper cover. **Photo 24**

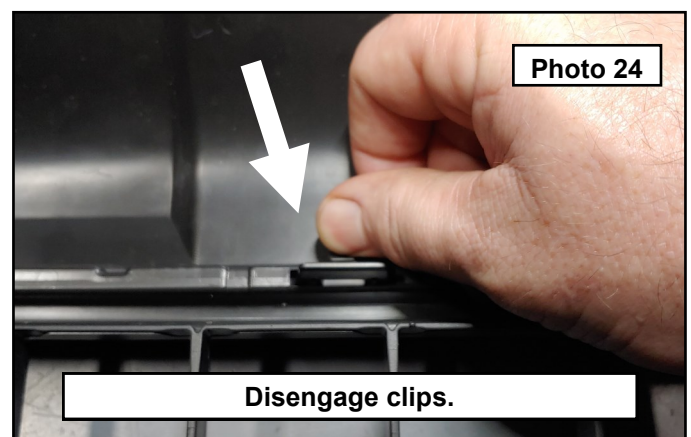
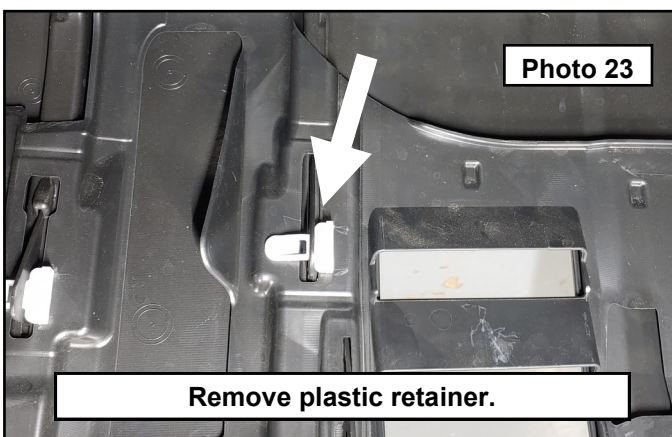

27. Flip the bumper cover back over and it should look as shown. **Photo 25**
28. Mark the bumper cover as shown. Follow the inner edge, making sure to leave the outer recess for the center cover to fit into. **Photo 26**

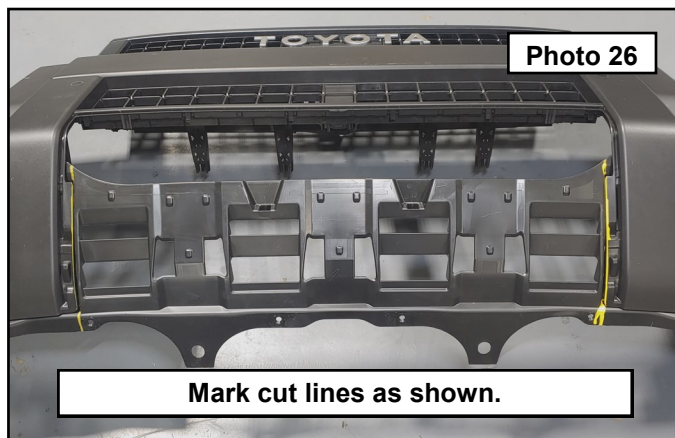
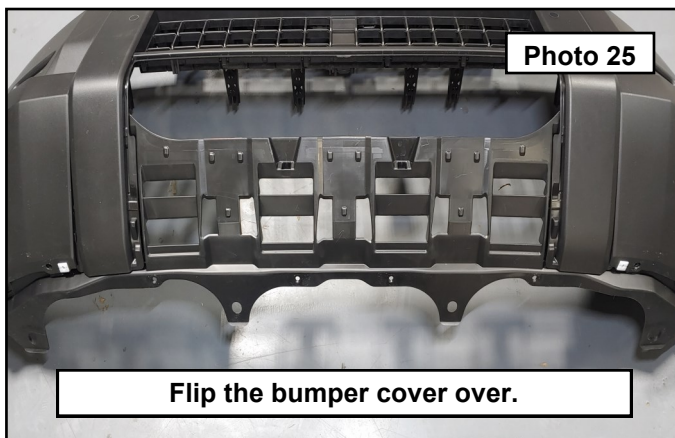

29. Use an appropriate cutting tool to cut along the previously made lines. **Photo 27**
30. Remove the inner structure and discard. Sand any burrs smooth. **Photo 28**

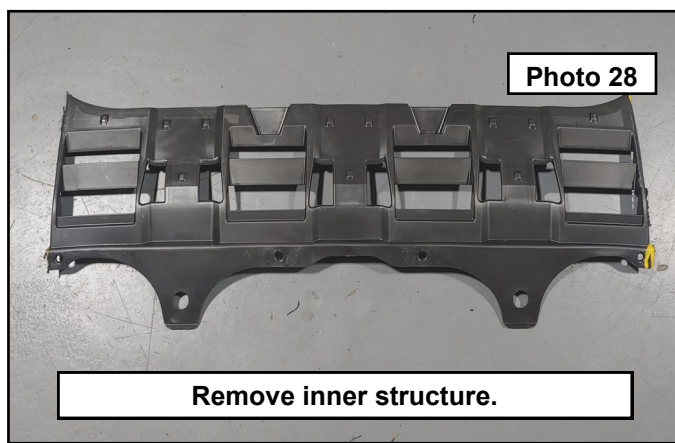
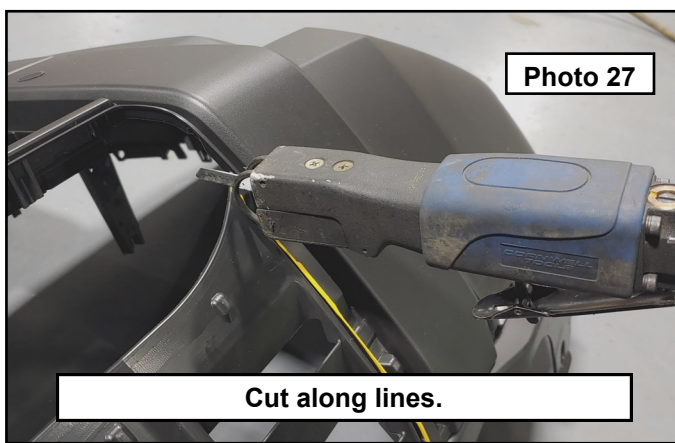

31. Install the RC molded fascia into the bumper cover latching the top clips. **Photo 29**
32. Flip the bumper over and install the white plastic retainers that were removed previously. **Photo 30**

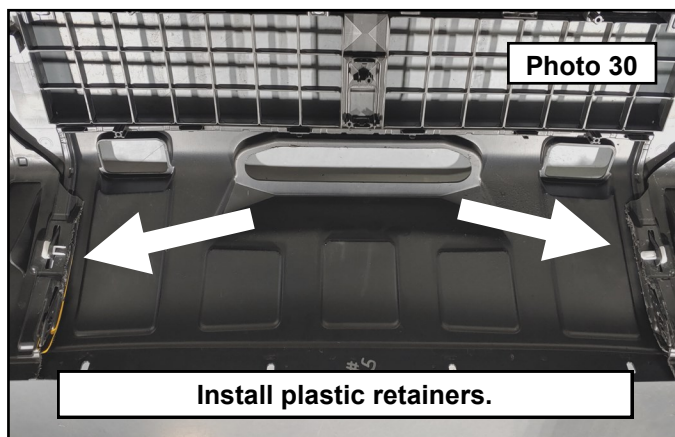
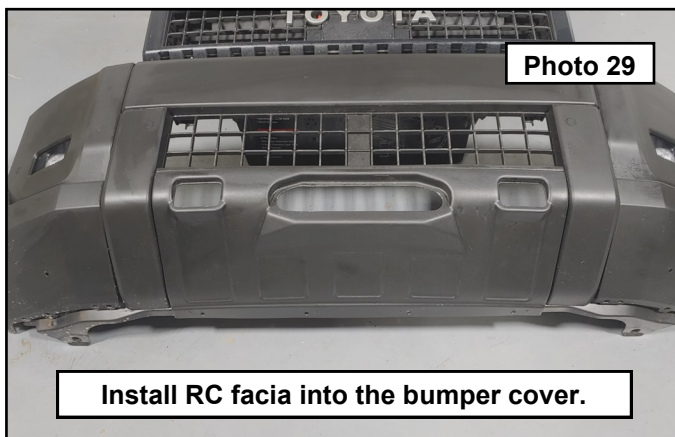

33. Remove the plastic rivets from the air diverter panels. These are located next to the outer / upper bumper hardware. **Photo 31**

34. Remove the plastic bumper structure from the aluminum bumper. **Photo 32**

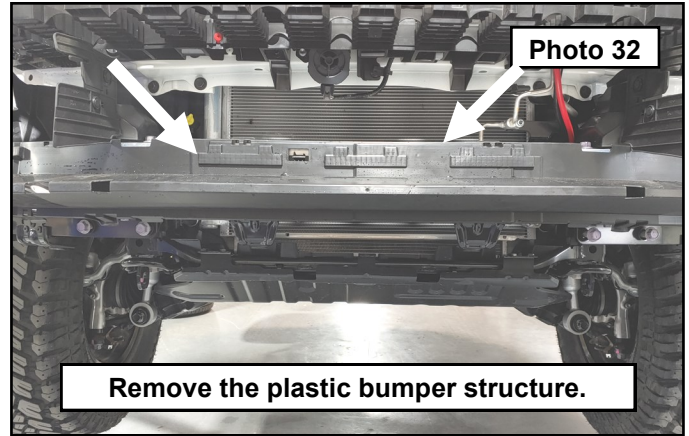
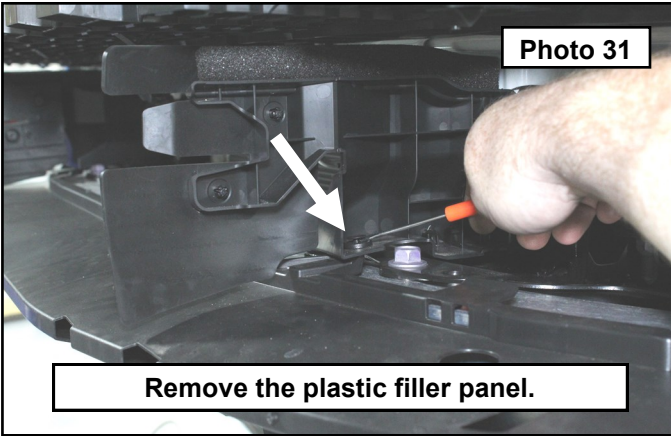

35. Press in the locking tabs while pulling the plastic bumper structure away from the aluminum bumper. **Photo 33**

36. Discard the plastic bumper structure. **Photo 34**

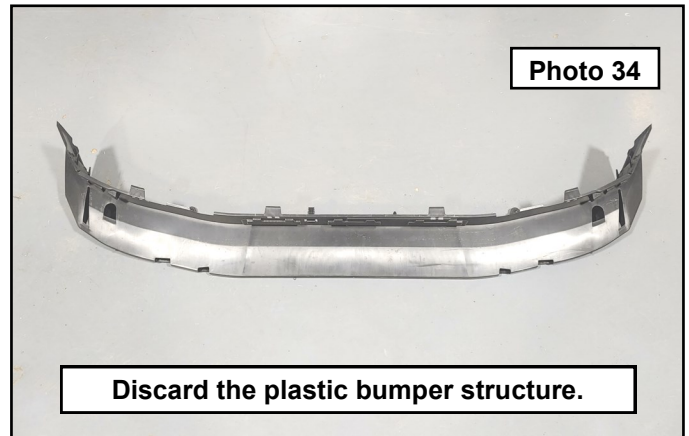
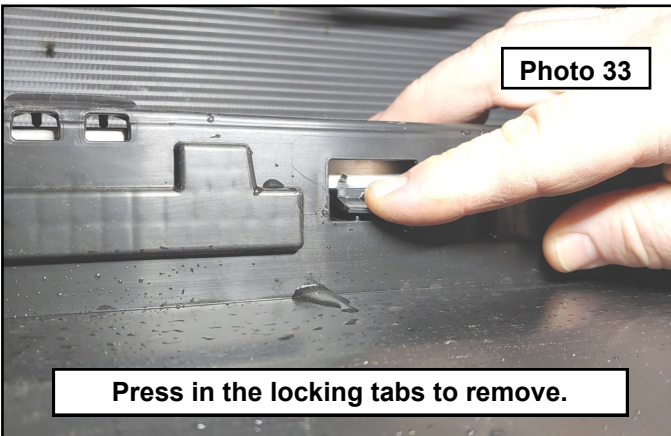

37. Remove the 3 bolts holding the intrusion bars from the ends of both sides of the aluminum bumper using a 17mm wrench. **Photo 35**

38. Remove the lower bumper hardware using a 17mm wrench. **Photo 36**

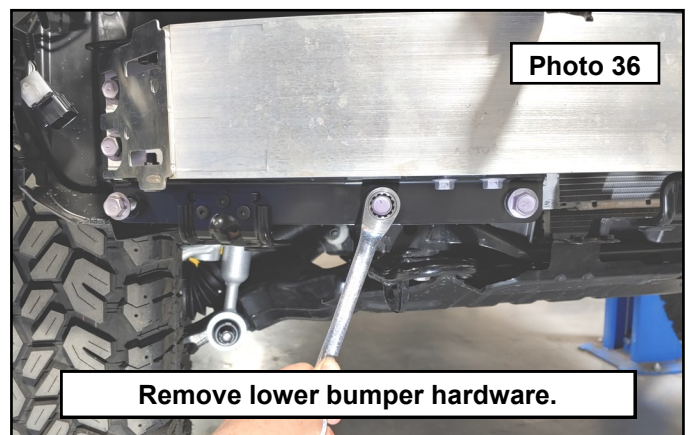
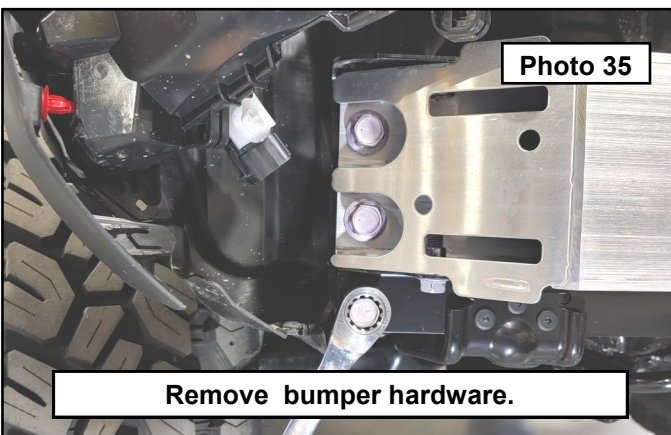

39. Remove the upper bumper hardware. **Photo 37**

40. Remove the aluminum bumper and intrusion bars from the vehicle. **Photo 38**

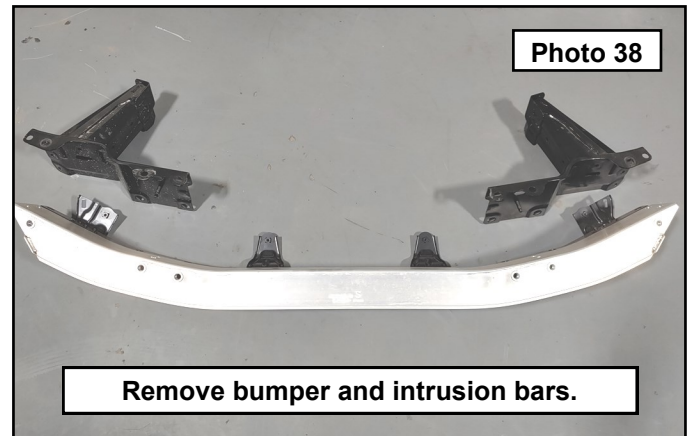

41. Locate the winch tray, driver wing, passenger wing, 12mm x 30mm bolts, 12mm washers, and 12mm flange nuts. **Photo 39**

42. The winch tray and wings fit multiple Toyota models and have dual bolt patterns. Install the bolts and washers into the winch tray as shown. Attach the wings using corresponding hole locations. When assembled, the winch tray will have the two forward holes empty, while the wings will have the rearmost holes empty. Snug the hardware but do not fully tighten. **Photo 40**

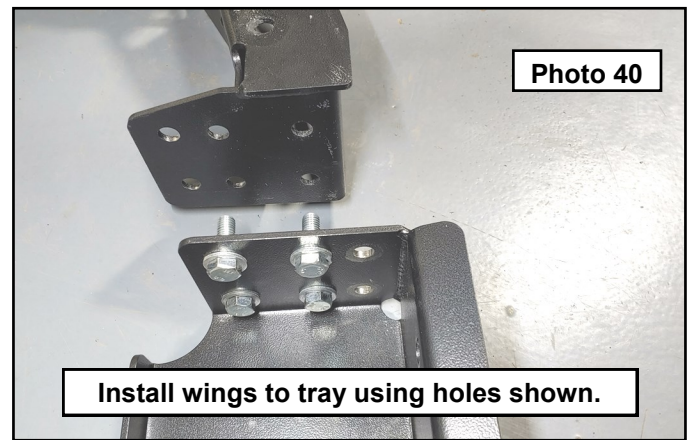
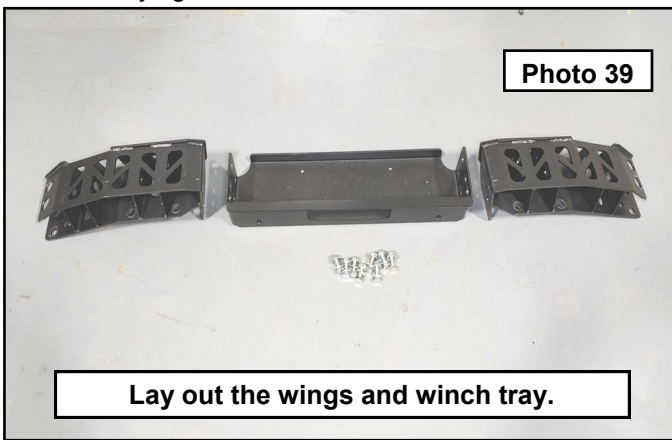

43. With the wings snugged into place but still able to be adjusted, locate the driver and passenger light bar mounts, silver 12mm x 35mm Socket Head bolts, and 12mm flange nuts. **Photo 41**

44. Install the light bar mounts to the open hole locations on the winch tray. These mounts are slotted for final adjustment later. Start by snugging the socket head bolts down with the light mounts at the top of their slots. Once in place tighten the hardware. Push the wings up against the socket heads and torque to 65 ft/lbs. **Photo 42**

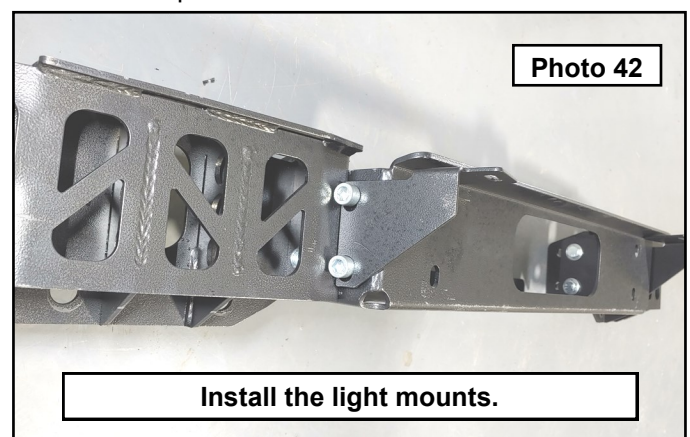
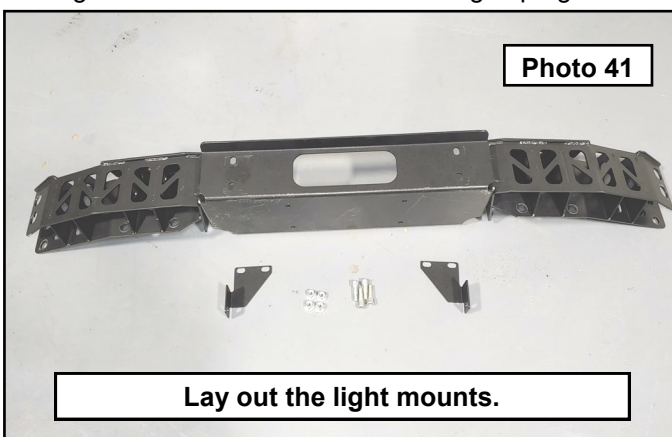

45. Locate the fairlead mount, 12mm x 30mm bolts, 12mm washers, and 12mm flange nuts. **Photo 43**
46. Install the fairlead mount to the winch tray with the head of the bolt and washer to the inside facing out with the flange nuts on the outside. Center the fairlead and snug the hardware. This may need adjustment later. **Photo 44**

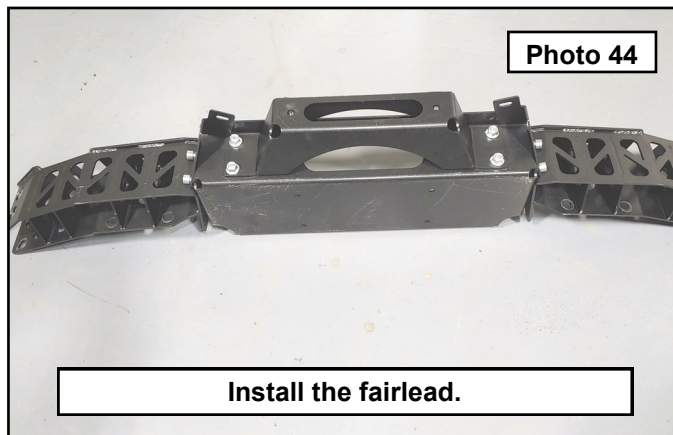
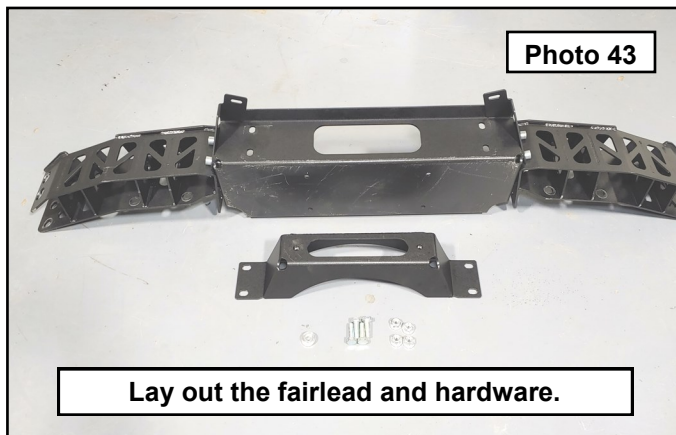

47. You will need to replace the battery cable leads on the winch to reach the 12 volt battery in the back of the vehicle. Pull back the protective boot on the control box for the positive cable. Remove the nut with a 13mm wrench. **Photo 45**
48. Install the protective boot onto the new power cable and install to the positive terminal. **Photo 46**

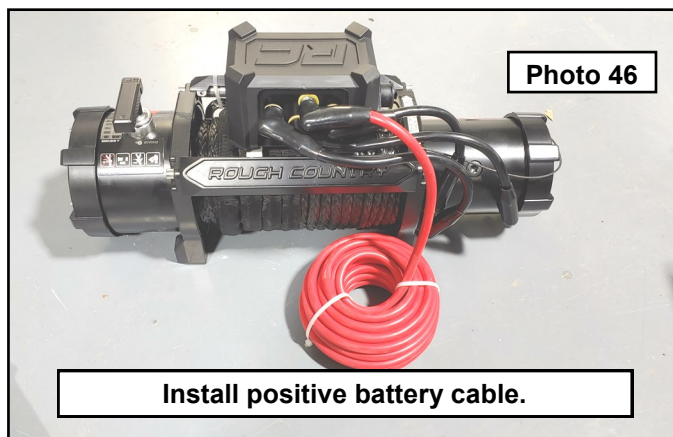
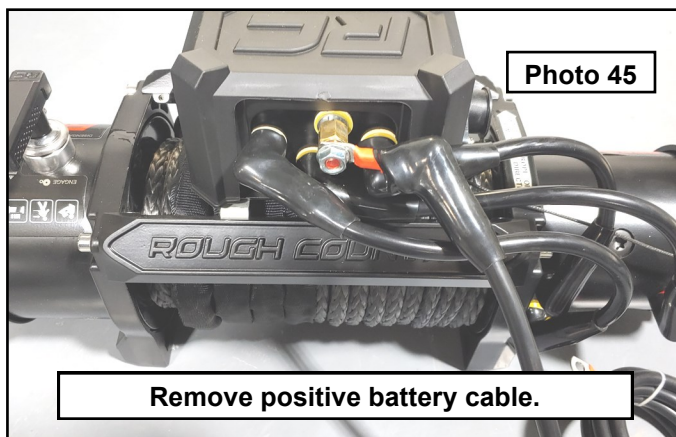

49. Turn the winch upside down, install the provided square nuts into the feet of the winch. Remove the negative terminal nut and install the longer negative cable. **Photo 47**
50. With the winch upside down, install the assembled winch tray using the provided hardware from the winch kit. **Photo 48**

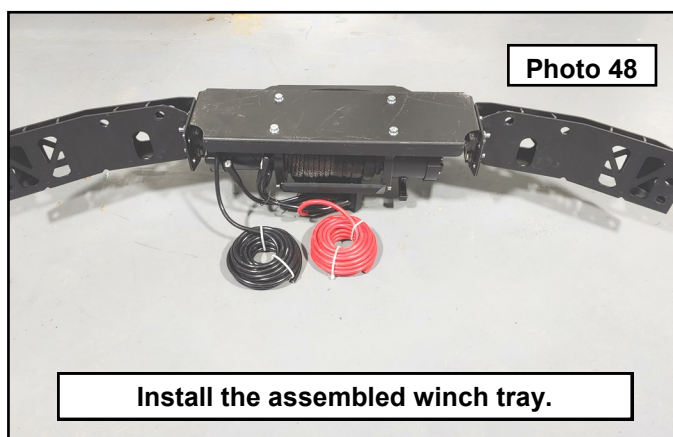
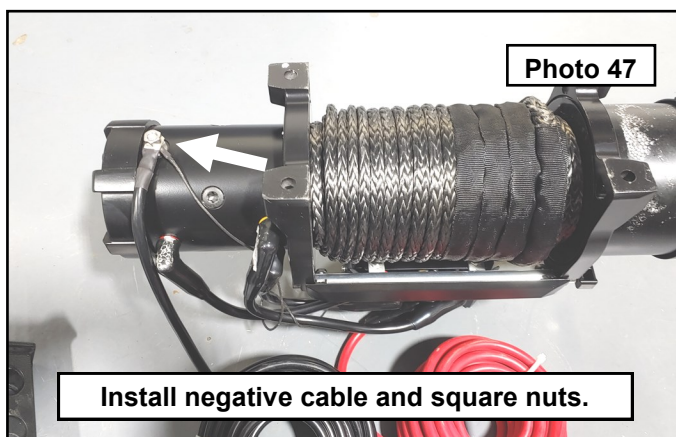

51. Shown out of sequence for clarity: You will need to slide the control box on the winch over to the driver side as far as can be to clear the front mounted hybrid speaker. The control box will slide on its rails most of the time with slight pressure. In the event that yours is not sliding over easily, you can remove the cross bar covers and then slide the control box over. Reinstall the cross bar cover. **Photo 49**
52. Use a jack to raise the winch assembly into place. **Photo 50**

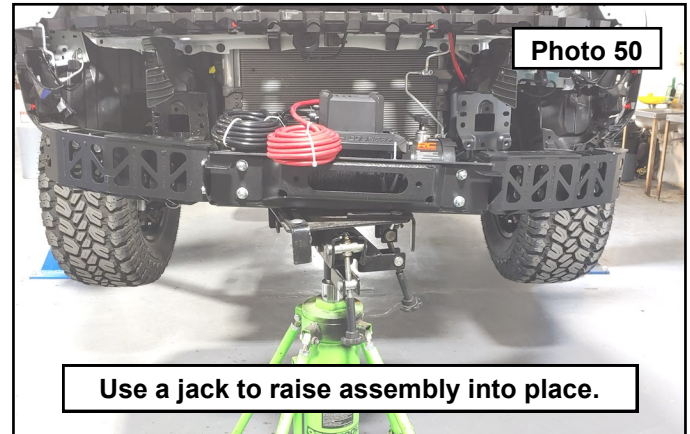
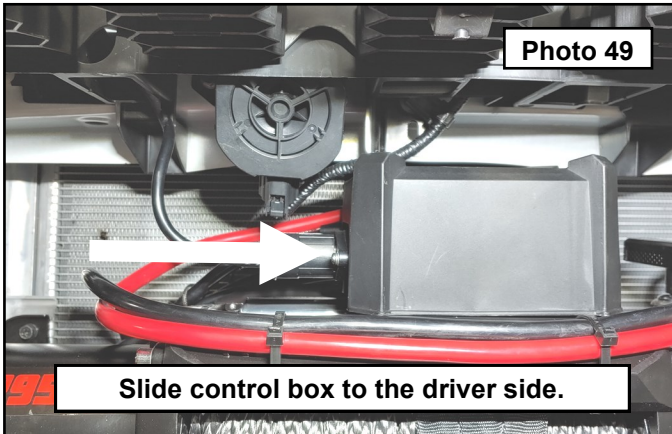

53. Install the factory intrusion bars to the wings using the provided 12mm x 30mm bolts, washers and flange nuts into the second hole from the end. Leave loose. **Photo 51**
54. Install the intrusion bars to the wings using the factory hardware. Leave loose. **Photo 52**

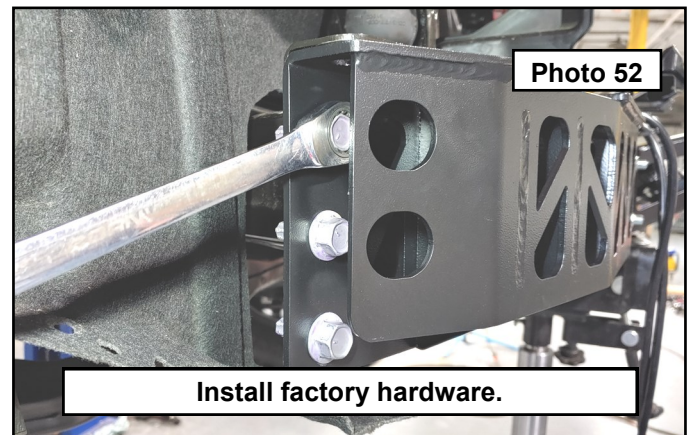
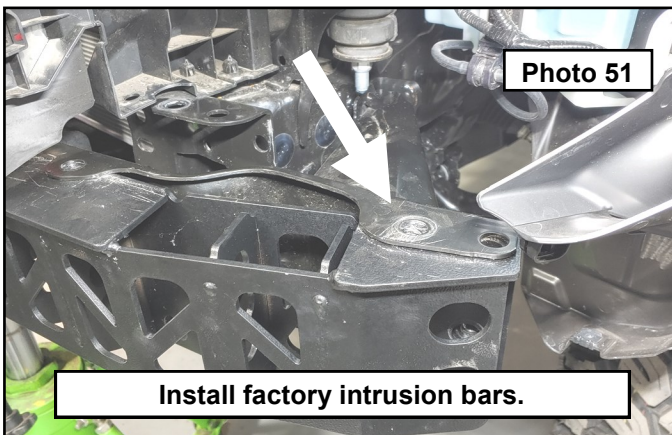

55. Install the winch assembly to the frame rails using the provided 12mm x 30 mm bolts, washers and flange nuts. The easiest way to do this is to run the bolt with washer from the bottom of the wing and through the frame rail using a 19mm shallow socket on a 6" extension. Leave loose. **Photo 53**
56. Install the lower wing to the frame using the factory hardware. Once all hardware is installed, center the winch tray assembly in the frame. Torque all hardware to 65 ft/lbs at this time. **Photo 54**

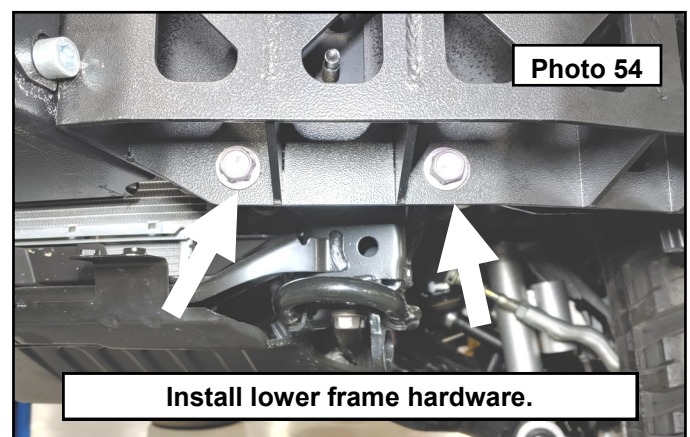
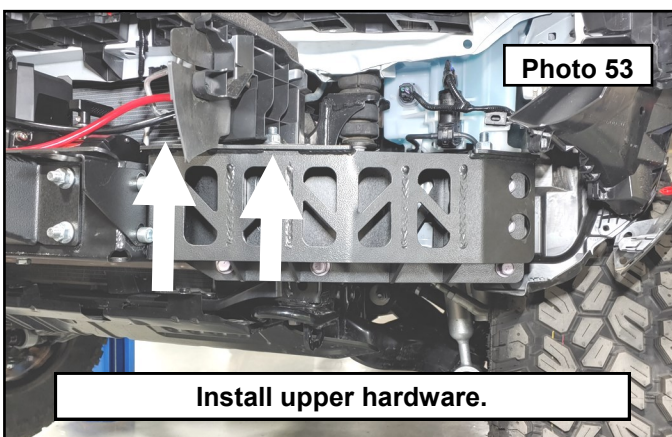

57. Install the lights to the mounts using the hardware from the light kit. Snug the hardware down but do not fully tighten to allow for adjustment. Now is the time to run the wires and switch to the preferred locations. **Photo 55**
58. Locate the winch control extension cable and remove the cover from the supplied winch control cable and set aside. **Photo 56**

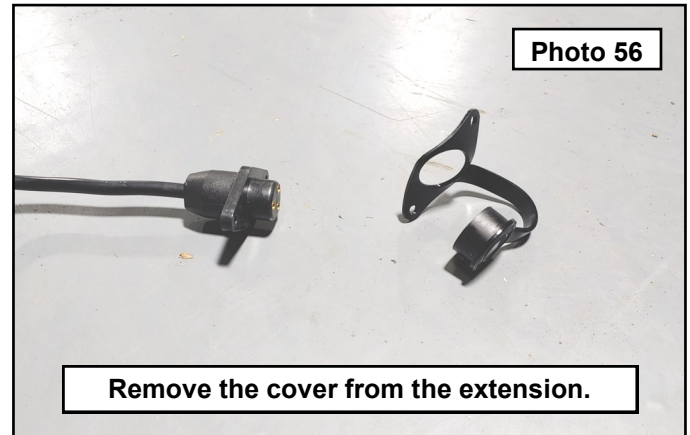
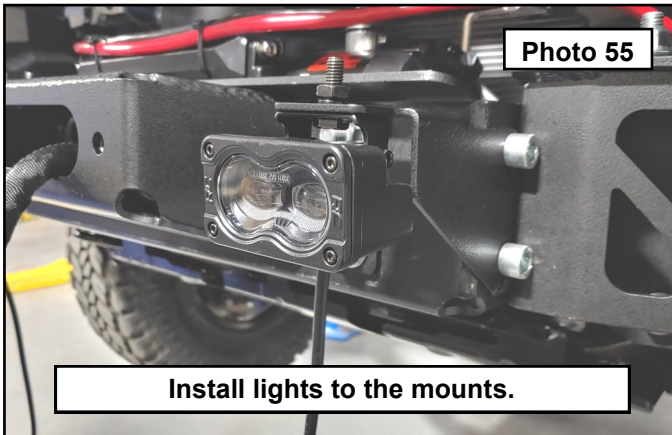

59. Plug in control box extension lead into the winch and route the other end up into the engine bay. **Photo 57**
60. Route the battery cables around the front of the winch and to the driver frame rail. Zip tie the cables to the front cross bar cover. Run the battery cables down the length of the frame rail zip tying as you go along. Avoid any moving parts and exhaust. **Photo 58**

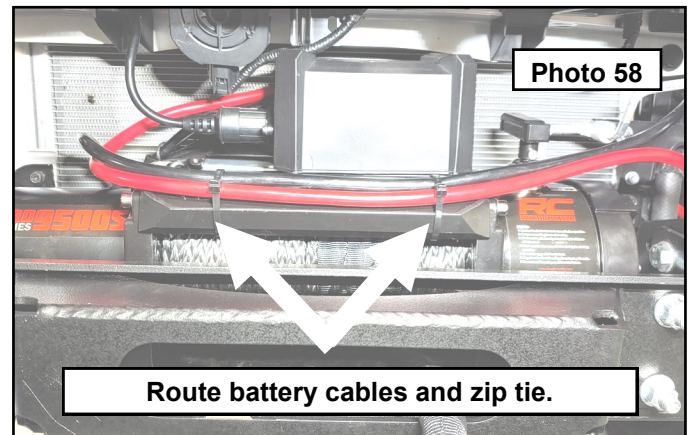
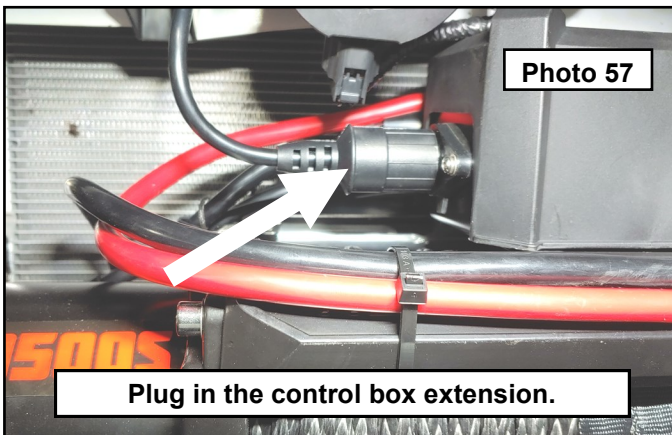

61. Open the rear cargo door to access the battery compartment. Lift up and out on the cover to expose the battery. **Photo 59**
62. Use a pry tool to pop the driver side tail light filler panel clips and remove. **Photo 60**

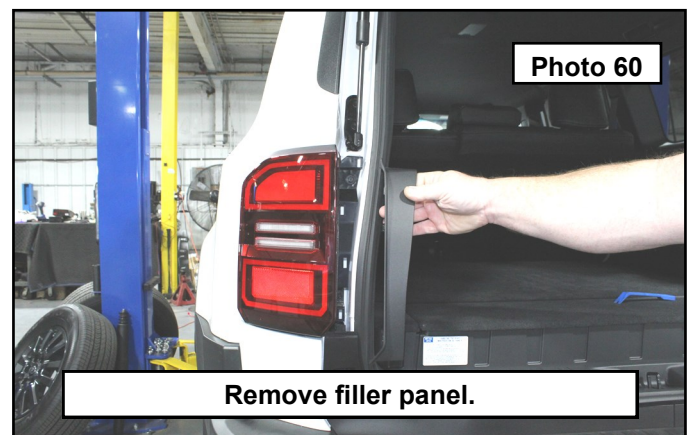

63. Remove the driver side tail light hardware using a 10mm socket. **Photo 61**

64. Remove the driver side tail light by pulling out and away from the vehicle body. **Photo 62**



65. Disconnect the tail light electrical connector and set aside. **Photo 63**

66. Use a pry tool to pop the filler panel clips. **Photo 64**

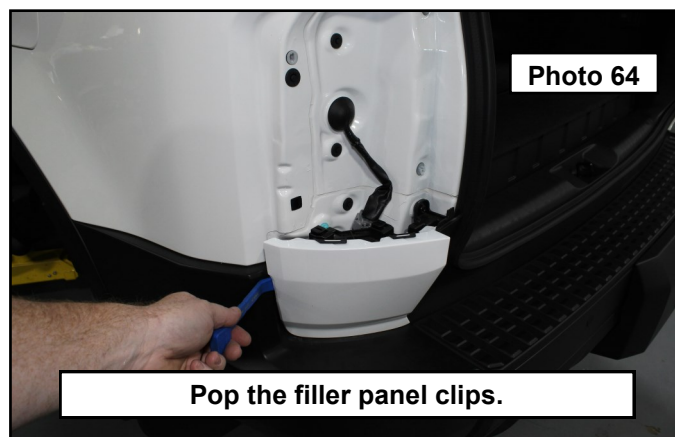
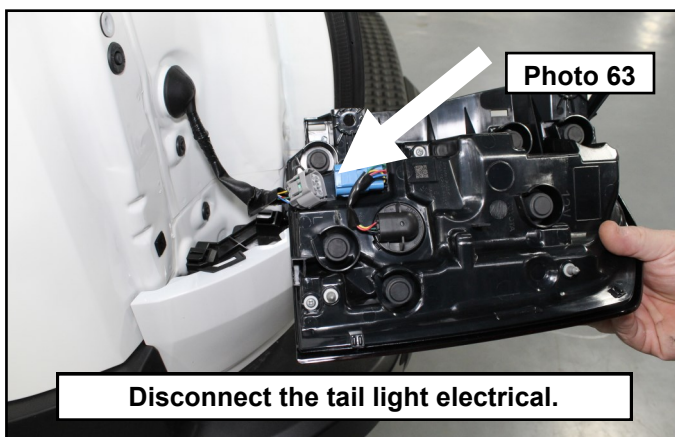

67. Pull the filler panel out and away from the body. **Photo 65**

68. Remove the filler panel. **Photo 66**

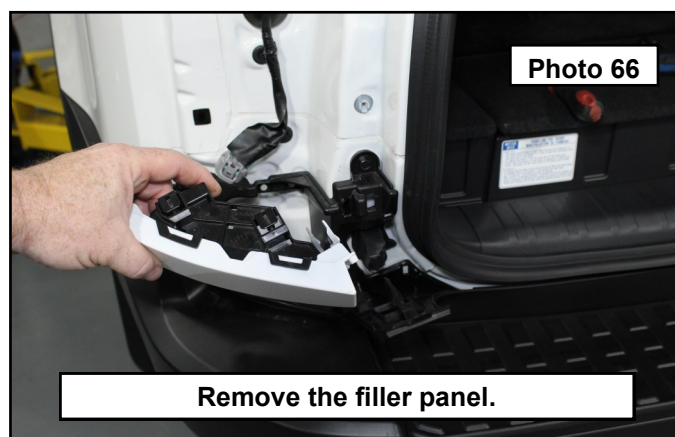
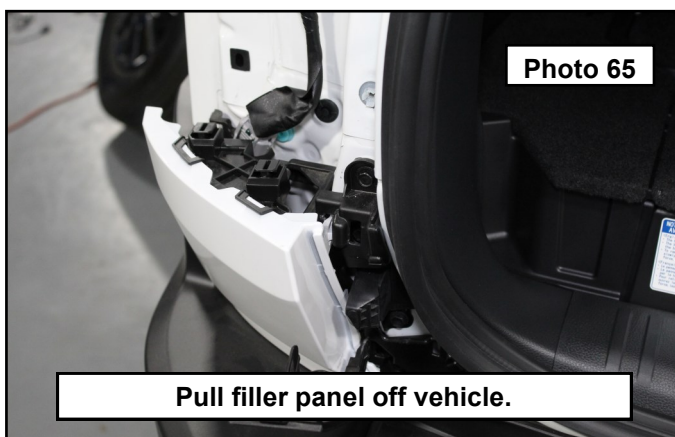

69. With the tail light and monitor removed, route the battery cables up from the frame rail up into the space behind the tail light. **Photo 67 / 68**

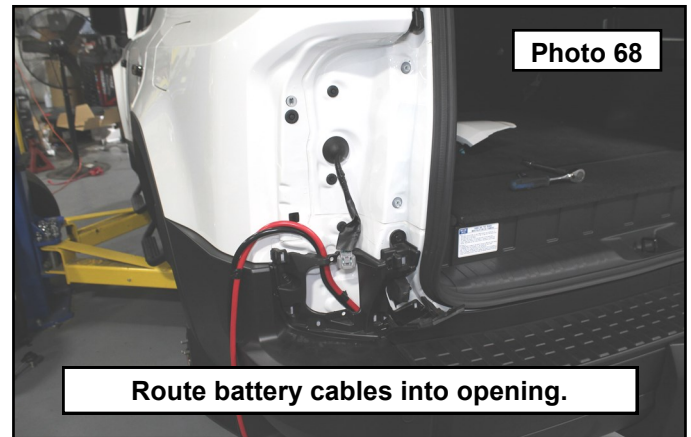
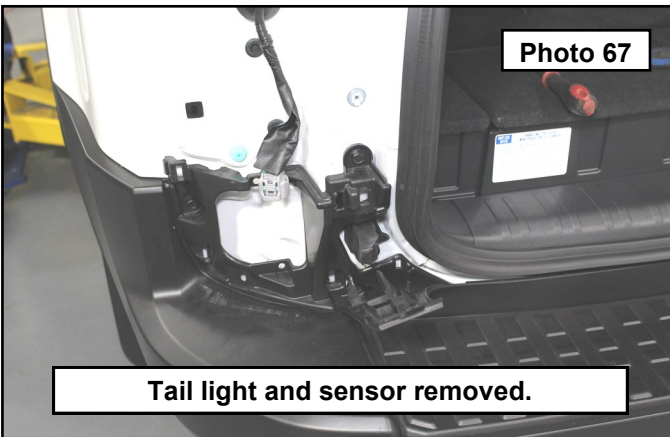

70. Use a razor blade to cut a small slit in the under side of the rubber grommet for the factory electrical harness. **Photo 69**

71. Route the battery cables through the slit and into the battery compartment. Use silicone gasket maker around the battery cables to seal the hole you just created. **Photo 70**

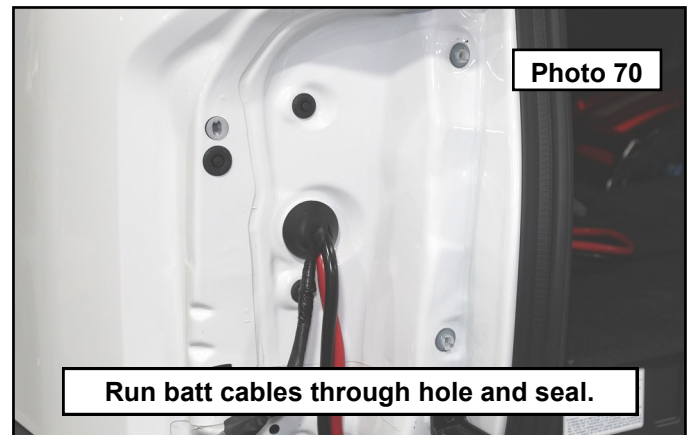

72. With the battery cables routed into the battery compartment, connect the cables to their appropriate posts on the battery. Test the winch by connecting the controller to the extension lead and cycling the rope in and out before moving on. **Photo 71**

73. Reinstall the battery cover, blind spot monitor and taillight pieces in the reverse order of the disassembly. **Photo 72**

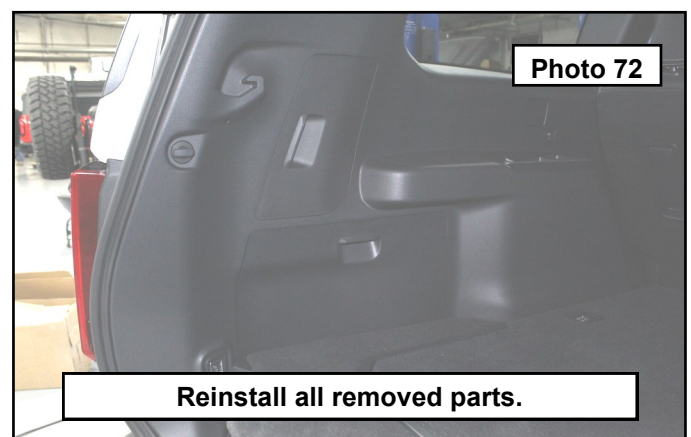
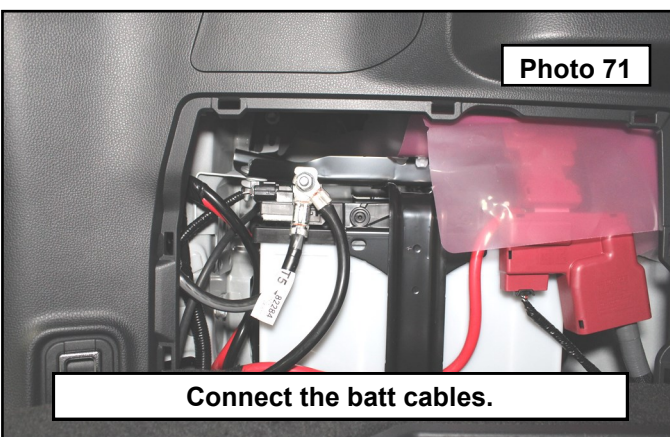

74. Hang the assembled facia back onto the vehicle. **Photo 73**

75. As you are making everything fit, you may need to adjust the fairlead and the lights to fit into their respective holes. You can adjust the lights side to side by going through the grill opening, but if you need to raise or lower them, you will need to remove the facia and adjust as necessary. This also applies to the fairlead. This may take a few tries to get everything lined up 100%. Once all is determined to be correct, reinstall the facia in the reverse order of disassembly. **Photo 74**

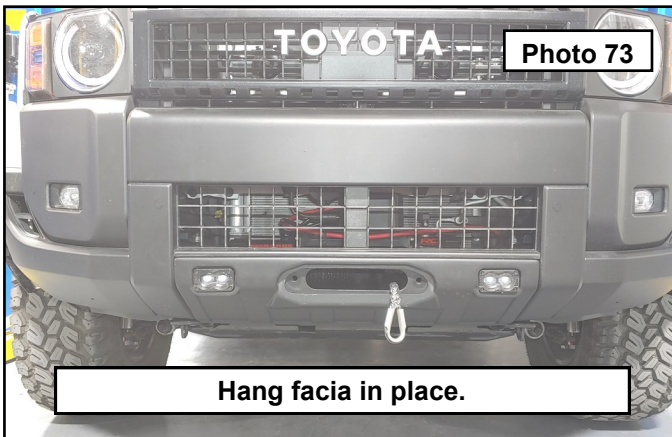

76. Locate the fairlead that came with the winch kit and the spacers and 12mm x 45mm socket head bolts. **Photo 75**

77. Install the fairlead with the socket head bolts and spacer to the fairlead mount and 10mm hex wrench. **Photo 76**

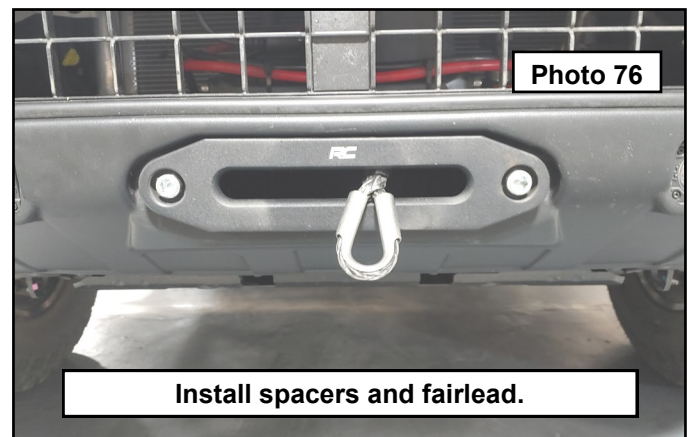
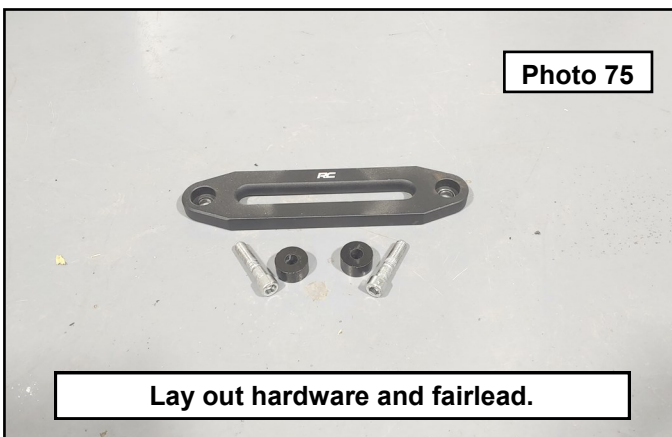

78. Install the included rubber isolator to the winch rope. **Photo 77**

79. Install the included hook to the winch rope. The winch rope is not ready to use at this point. You need to stretch the rope after the final installation otherwise you can damage the rope. There are videos on how to do this online if you are unsure. It will take two people or a slight hill and a stationary anchor. The rope will need to be pulled all the way out of the drum minus the very last wrap. Tie the rope to the anchor and then have the vehicle in neutral while pressing on the brakes to tighten the rope weave. Once stretched tight, let off on the brakes enough to allow the vehicle to roll forward and cycle the rope back onto the drum making sure to spool it neatly. **Photo 78**

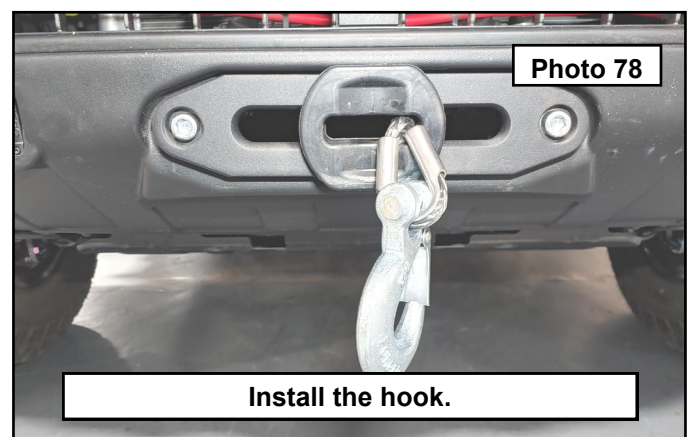
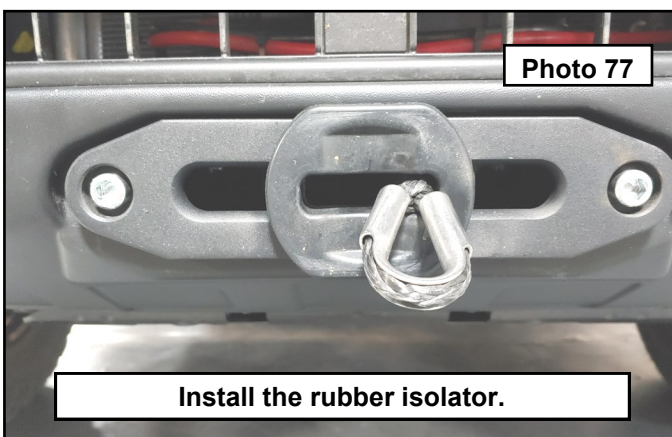

80. Locate the lower fascia mount, 6mm bolts, washers, 8mm bolts, washers, and clip nuts. Install the clip nuts to the 4 locations on the mount as shown with the nut side of the clip nut on the upward side of the bend. **Photo 79**
81. Install the mount to the 4 locations on the factory skid plate using the 6mm bolts and washers and then to the 4 locations of the fascia to the mount using the 8mm bolts and washers. **Photo 80**

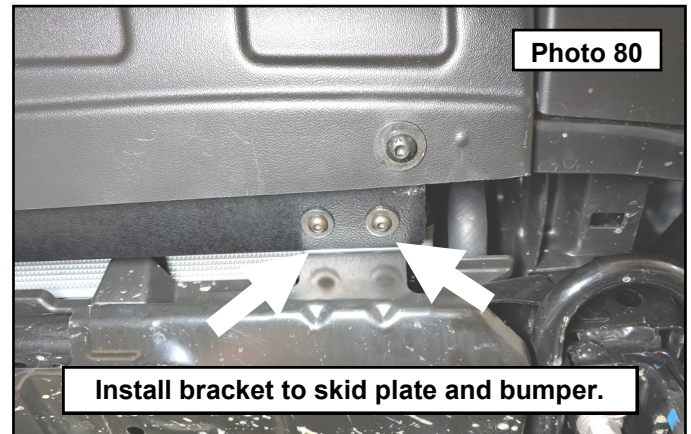
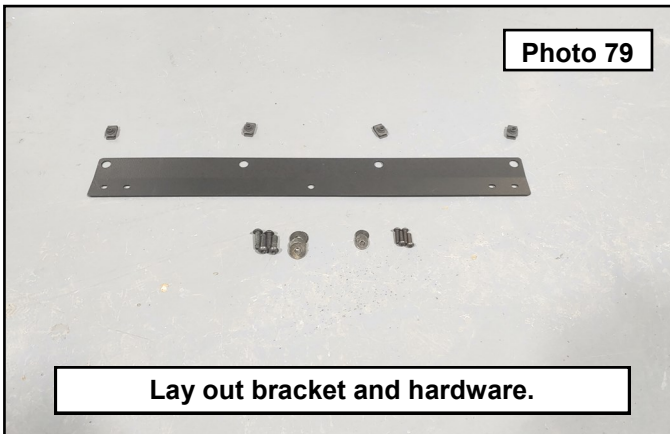

82. To mount the winch controller extension, locate the holes on wither side of the core support cover. Use the previously removed cover to mark the location for drilling. **Photo 81**
83. Use a cutting tool like a carbide bit to open up the center hole so the extension fits through. Drill out the two mounting holes using a 1/8" drill bit. **Photo 82**

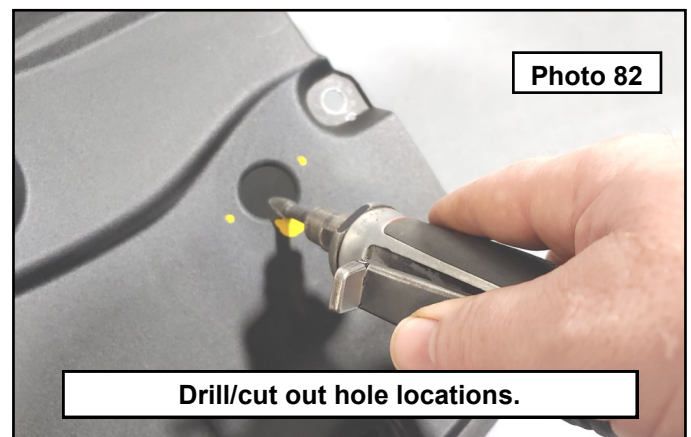
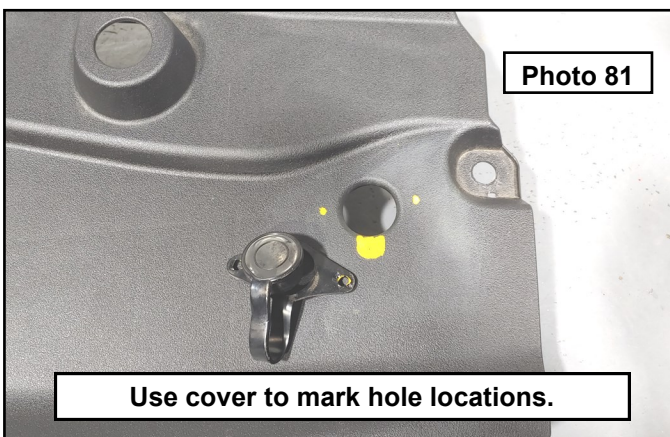

84. Clean any burrs, pass the end of the cover through the hole created and sandwich the cover between the extension and core support cover. Attach using the provided self threading Phillips screws. **Photo 83**



By purchasing any item sold by Rough Country, LLC, the buyer expressly warrants that he/she is in compliance with all applicable , State, and Local laws and regulations regarding the purchase, ownership, and use of the item. It shall be the buyers responsibility to comply with all Federal, State and Local laws governing the sales of any items listed, illustrated or sold. The buyer expressly agrees to indemnify and hold harmless Rough Country, LLC for all claims resulting directly or indirectly from the purchase, ownership, or use of the items.