

## RAM 2019-Up 1500 Crew Cab Bluetooth Step

Thank you for choosing Rough Country for all your vehicle needs.

Please read instructions before beginning installation. Check the kit hardware against the kit contents shown below. Be sure you have all needed parts and know where they go.

If question exist, please call us @1-800-222-7023. We will be happy to answer any questions concerning this product.

Check all fasteners for proper torque. Check to ensure for adequate clearance between all components.

Periodically check all hardware for tightness.

### Kit Contents:

Driver Side Module Step Mount x1  
Step Mounts x5  
Step Boards x2  
Control Module x1  
Power Wiring Harness x1  
LED Light Harness x2  
Entry lights x4

### Tools Needed:

10mm Wrench or Socket  
13mm Wrench or Socket  
Drill Motor  
3/8 Bit

### Hardware Included:

8mm Flat Washer x18  
8mm Lock Nuts x18  
6mm Flange Nut x24  
6mm X 20mm T-Bolt x20  
6mm x 20mm Hex Bolt x4  
6mm Flat Washer x4  
Door Magnets x4  
Cable Ties x15

See separate sheet for Bluetooth App Instructions



### Torque Specs:

Size	Grade 5	Grade 8	Size	Class 8.8	Class 10.9
5/16"	15 ft/lbs	20ft/lbs	6MM	5ft/lbs	9ft/lbs
3/8"	30 ft/lbs	35ft/lbs	8MM	18ft/lbs	23ft/lbs
7/16"	45 ft/lbs	60ft/lbs	10MM	32ft/lbs	45ft/lbs
1/2"	65 ft/lbs	90ft/lbs	12MM	55ft/lbs	75ft/lbs
9/16"	95 ft/lbs	130ft/lbs	14MM	85ft/lbs	120ft/lbs
5/8"	135ft/lbs	175ft/lbs	16MM	130ft/lbs	165ft/lbs
3/4"	185ft/lbs	280ft/lbs	18MM	170ft/lbs	240ft/lbs



## INSTALLATION INSTRUCTIONS

1. Locate the step brackets and wiring harness. **See Photo 1.**
2. Install the module on to the step bracket using (4) of the supplied bolts and (4) nuts. **See Photo 2.**

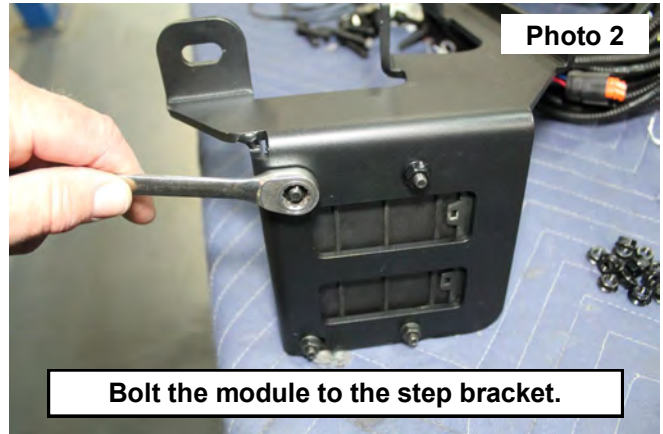

3. Install the (Drivers side shown) first step bracket using (3) of the supplied 8mm Lock Nuts and flat washers. Hand tighten loosely. **See Photo 3.**
4. Install the step bracket with the module mount in the second position of the vehicle using (3) of the supplied 8mm lock nuts and flat washers. Hand tighten loosely. **See Photo 4.**

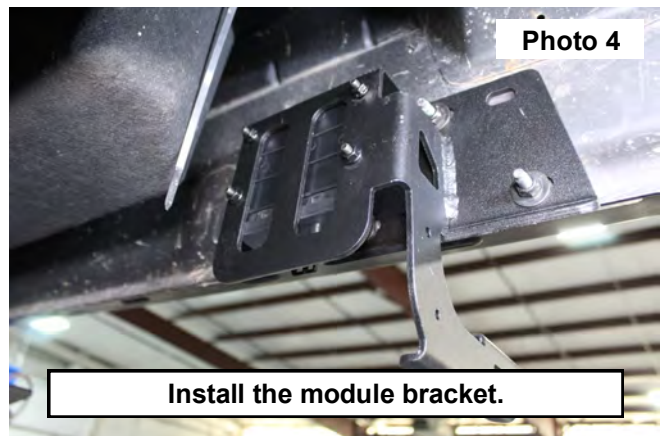
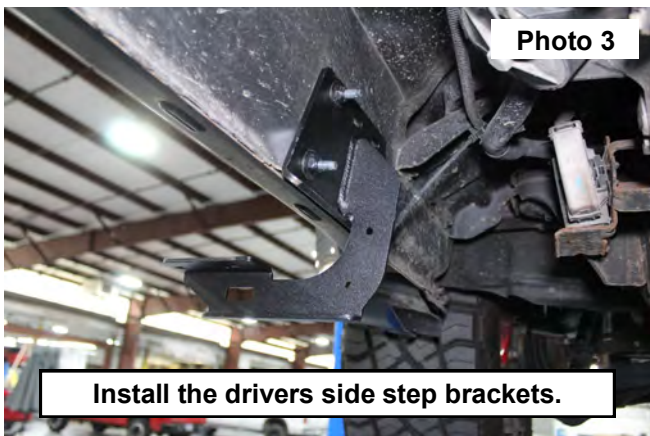

5. Install the rear step bracket using (3) of the supplied 8mm lock nuts and flat washers. Hand tighten loosely. **See Photo 5.**
6. Install the T-Bolts into the step. (7) bolts will be installed into the track on the body side of the step. (3) bolts will be installed on the outer side of the step. **See Photo 6.**





7. Place the (2) entry lights onto (2) of the bolts and secure using (2) of the flange nuts. The (2) entry lights will need to be in-between the front and center step mount and the in-between center and rear step mount and pointed in the outward position. **See Photo 7.**
8. Place the step onto the mounting brackets. Placing the hardware into the slotted holes. Secure the step using the supplied flange nuts on each of the mounting brackets. **See Photo 8.**

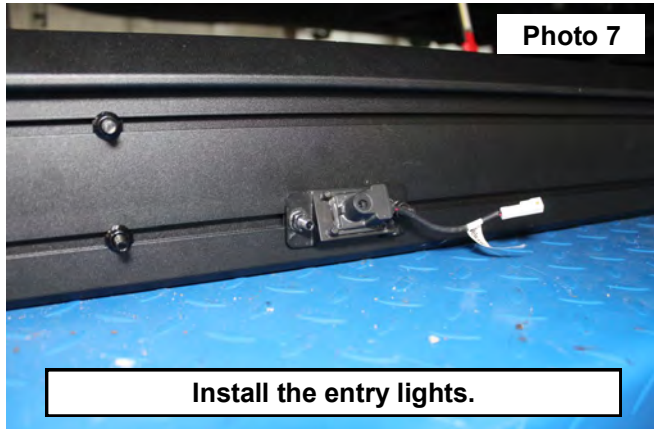

9. Center the step to the body of the vehicle and tighten all step hardware. **See Photo 9.**
10. Install the opposite side step mounting brackets to the body and the step.
11. Connect the light wiring harness to the module. Connect the power wires to the battery. **See Photo 10.**

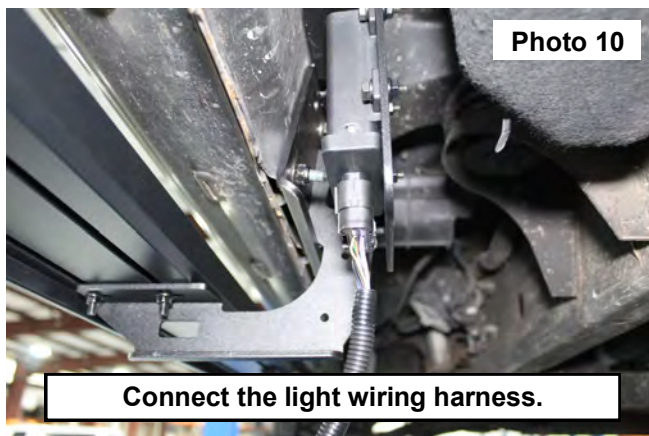
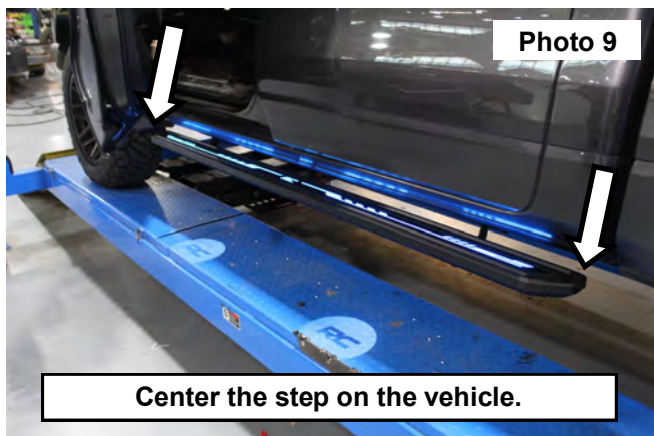

12. Plug the harness to the (4) entry light lights on each side of the vehicle. **See Photo 11.**
13. Route the harness to the (top step plate light) located at the front of the step connector. **See Photo 12.**

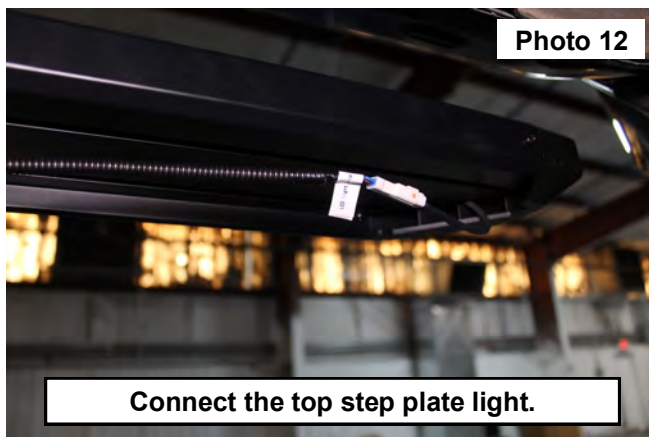
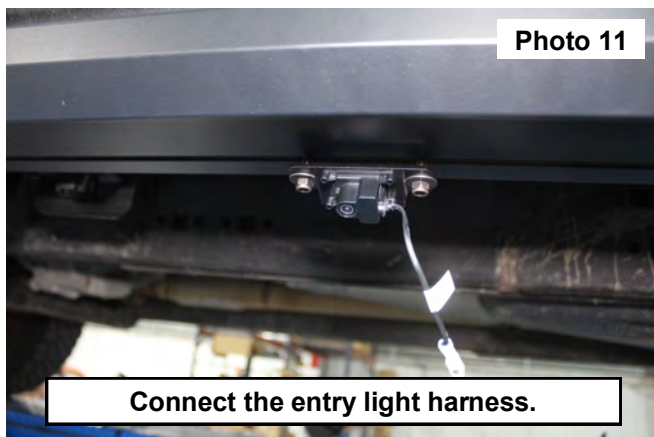

14. Secure the routing of the wires to the step brackets using the supplied cable ties. **See Photo 13.**  
15. Remove the front scuff plate from the interior of the vehicle. **See Photo 14.** Repeat on passengers side.

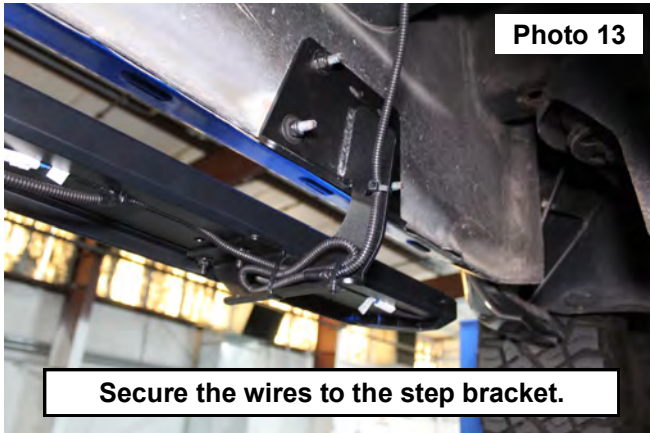

16. Lift the push pin securing the carpet to expose the floor of the cab. Drill a 3/8" hole into the plug (Plug Shown From The Underside of the Vehicle) for an access hole for the light wiring harness plugs. **See Photos 15 and 16.** Repeat on passengers side.

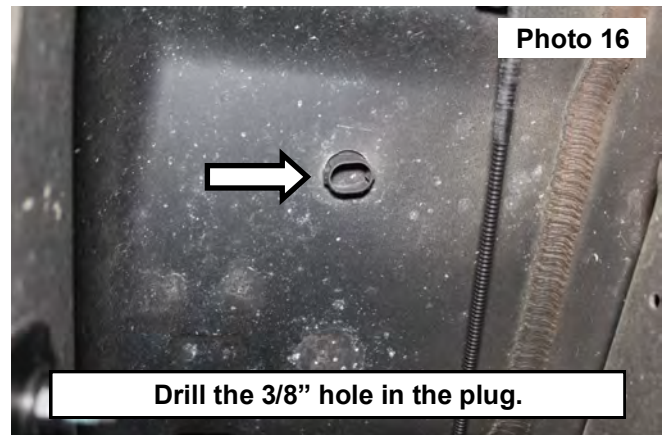

17. Place the harness through the hole drilled in the plug. **See Photo 17.** Repeat on passengers side.  
18. Select a location by the latch on the front door and place the sensor. Use the double sided tape on the back of the sensor to apply to the cab of the vehicle. **See Photo 18.** Repeat on passengers side.

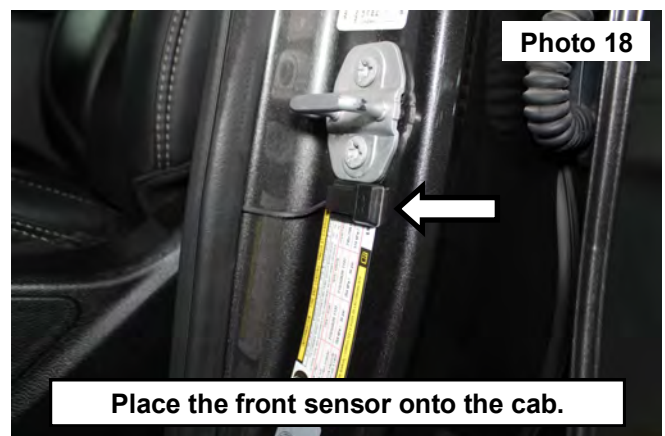
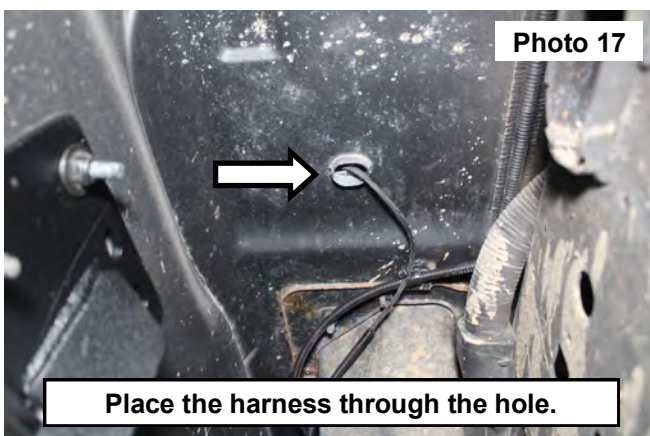



19. Align the door magnet with the sensor applied by the latch. **Notes:** The magnet can be taped onto the door to set the correct placement before the double sided tape is applied. Place the magnet onto the door using the double sided tape on the back of the magnet. **See Photo 19.** Repeat on passengers side.
20. Select a location for the rear door sensor under the door check stop limiter and place the sensor to the cab of the vehicle. Use the double sided tape on the back of the sensor to apply to the cab of the vehicle. **See Photo 20.** Repeat on passengers side.

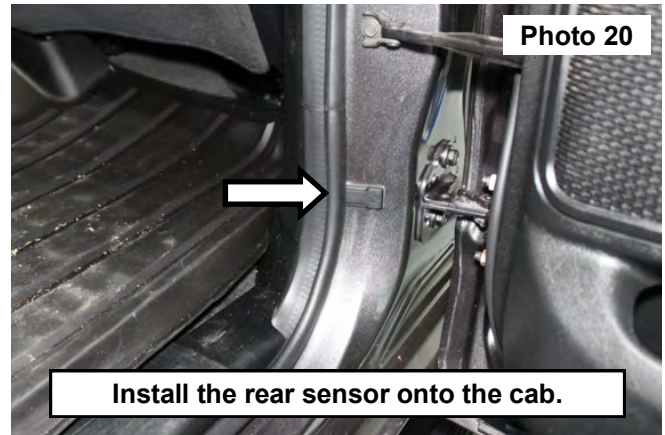
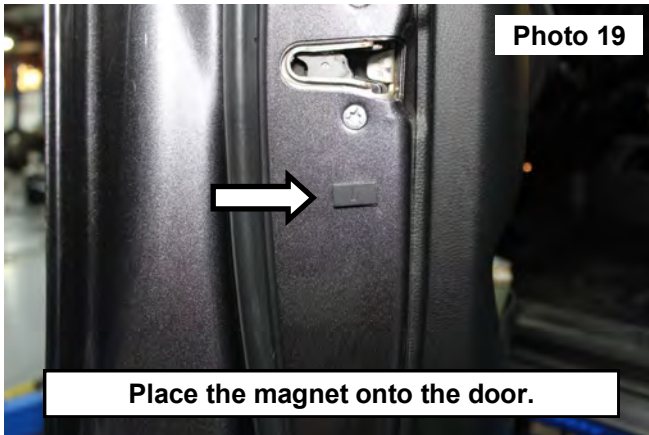

21. Align the door magnet with the rear sensor. **Notes:** The magnet can be taped onto the door to set the correct placement before the double sided tape is applied. Place the magnet onto the door using the double sided tape on the back of the magnet. **See Photo 21.** Repeat on passengers side.
22. Replace the interior scuff plate. **See Photo 22.** Repeat on passengers side.

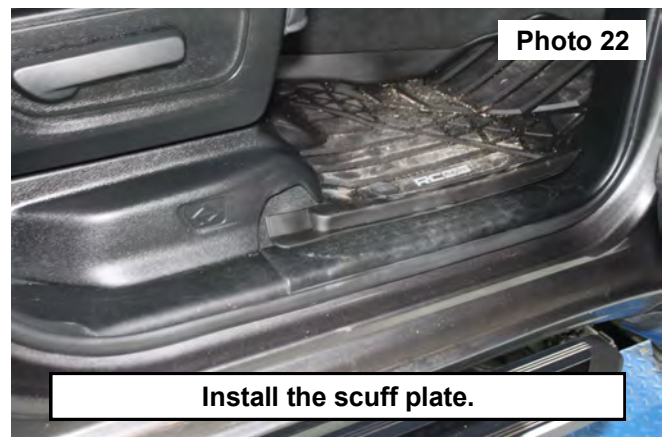
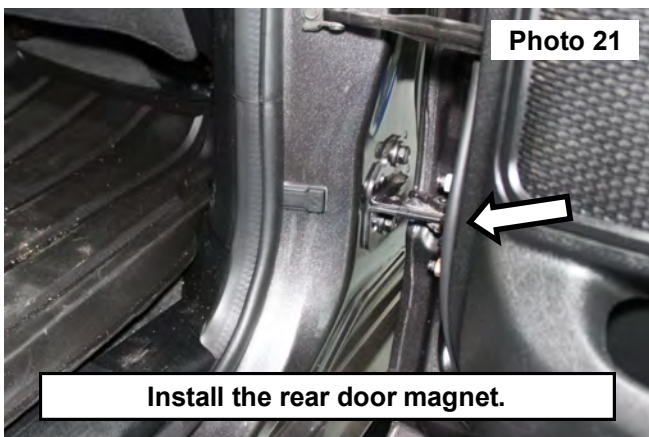

By purchasing any item sold by Rough Country, LLC, the buyer expressly warrants that he/she is in compliance with all applicable, State, and Local laws and regulations regarding the purchase, ownership, and use of the item. It shall be the buyers responsibility to comply with all Federal, State and Local laws governing the sales of any items listed, illustrated or sold. The buyer expressly agrees to indemnify and hold harmless Rough Country, LLC for all claims resulting directly or indirectly from the purchase, ownership, or use of the items.



