

## Ram 1500 (19-24) Tubular Front Bumper Winch Tray Installation

**Thank you for choosing Rough Country for all your vehicle needs.**

Please read instructions before beginning installation. Check the kit hardware against the kit contents shown below. Be sure you have all needed parts and know where they go.

If question exist, please call us @ 1-800-222-7023. We will be happy to answer any questions concerning this product. Check all fasteners for proper torque. Check to ensure for adequate clearance between all components. Periodically check all hardware for tightness.

### PARTS LIST:

Qty	Item Description	Qty	Item Description
1	Winch Tray	2	12mm Single Bolt Plate
1	Fairlead bracket	8	12mm Hex Nuts
4	Self-Tapping Screws	8	12mm Lock washers
2	15.5mm x 25mm OD x 2mm Foam Washers	8	12mm x 32mm OD x 3mm Flat washers
2	20mm x 10mm Foam Spacers	2	8-1.25mm x 25mm Button Head Allen Bolts
2	Sensor Hole Plugs	2	8mm Hex Lock Nuts
2	Sensor Retainer Caps	4	8mmx24mmx2mm Flat Washers
2	12mm Double Bolt Plate	1	Allen Wrench S=5

Fairlead Plate

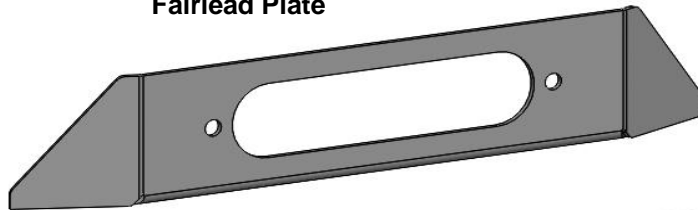

Winch Tray

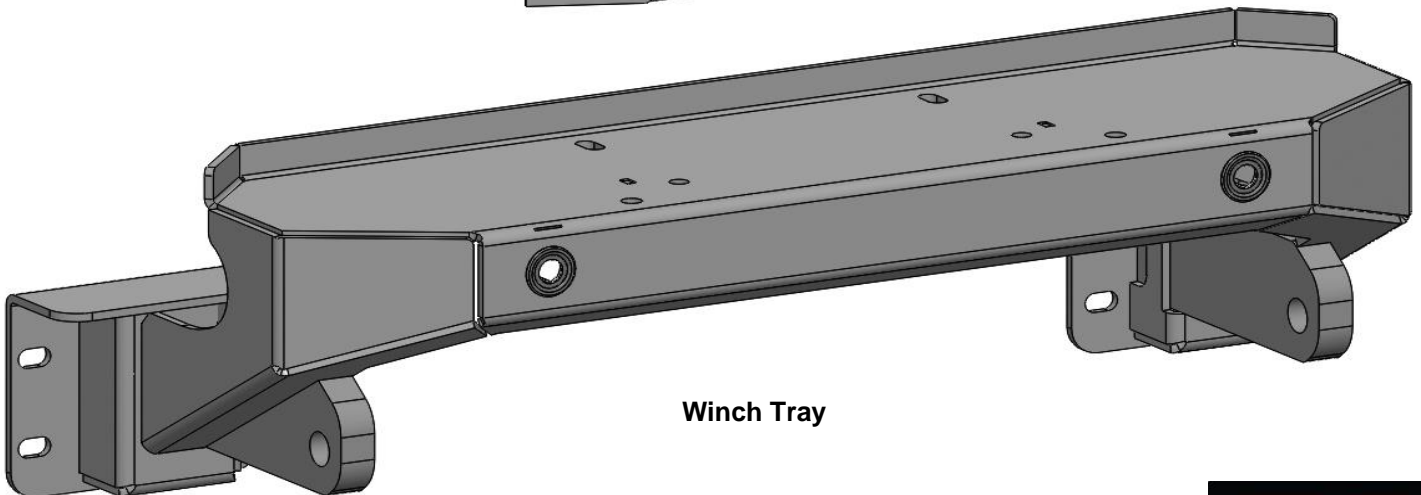

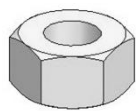

Hex Nut



Lock Washer



Flat Washer

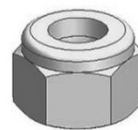

Nylon Lock Nut

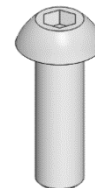

Button Head Bolt

### TOOLS REQUIRED



Ratchet



Socket



Extensions



Wrench

1

Follow (Fig 1 – 3) to remove Shackle Mounts to prepare Bumper for winch tray installation.

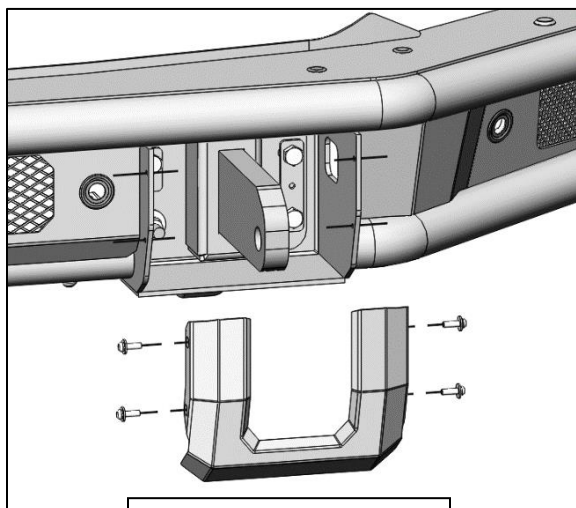

(Fig 1) Detach U-Cover

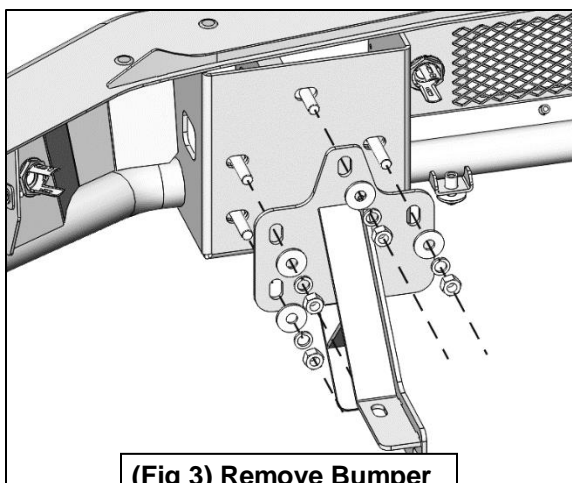

(Fig 3) Remove Bumper from Mounting Bracket

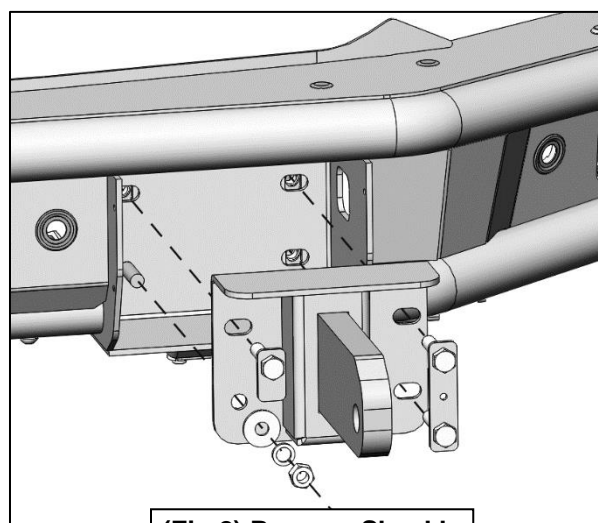

(Fig 2) Remove Shackle Mount from Bumper



2

Follow (Fig 4 – 8) to assemble and attach Fairlead Plate, then connect Winch Tray to Bumper.

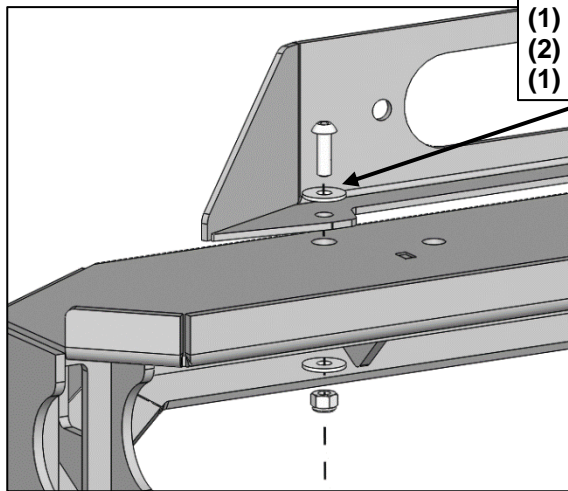

- (1) 8x25mm Button Head Bolt
- (2) 8mm Flat Washer
- (1) 8mm Lock Nut

(Fig 4) Attach Fairlead Plate to Winch Tray

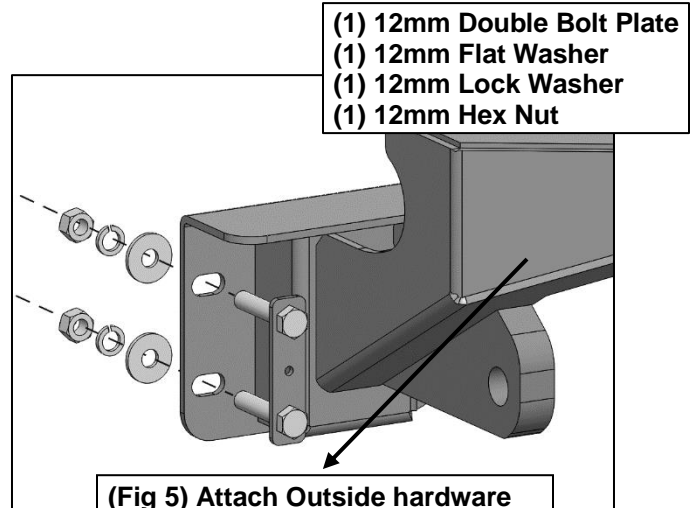

- (1) 12mm Double Bolt Plate
- (1) 12mm Flat Washer
- (1) 12mm Lock Washer
- (1) 12mm Hex Nut

(Fig 5) Attach Outside hardware to connect Winch Tray to Bumper

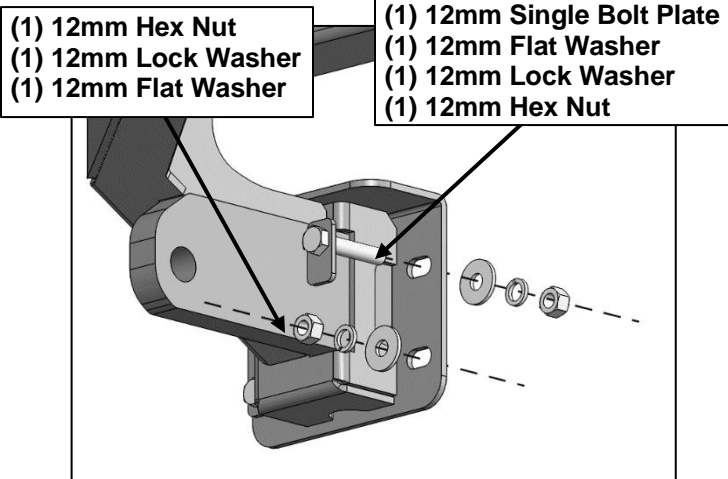

- (1) 12mm Hex Nut
- (1) 12mm Lock Washer
- (1) 12mm Flat Washer

- (1) 12mm Single Bolt Plate
- (1) 12mm Flat Washer
- (1) 12mm Lock Washer
- (1) 12mm Hex Nut

(Fig 6) Attach Inside hardware to connect Winch Tray to Bumper



(Fig 7) Attached Winch Tray

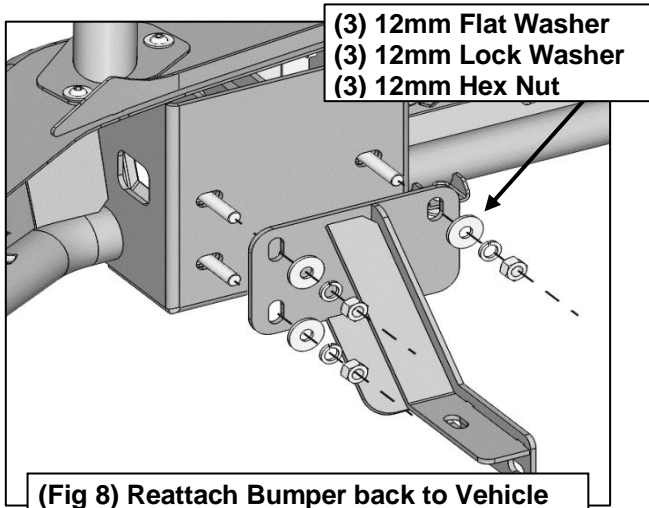

- (3) 12mm Flat Washer
- (3) 12mm Lock Washer
- (3) 12mm Hex Nut

(Fig 8) Reattach Bumper back to Vehicle

**3**

Follow (Fig 9 – 10) to reattach bumper to Support Brackets, then reattach U-Covers.

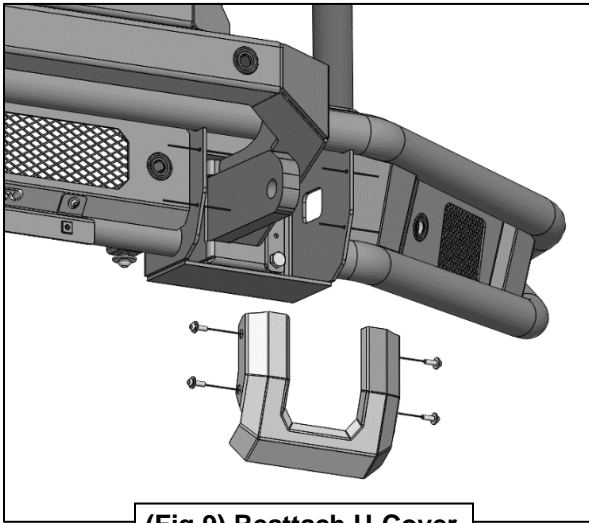

(Fig 9) Reattach U-Cover

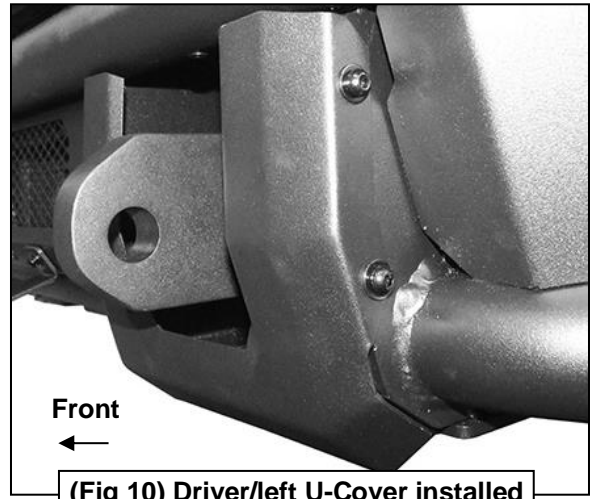

(Fig 10) Driver/left U-Cover installed



4

Ensure Bumper is level and all fasteners are tightened at this point. Installation is complete. Do periodic inspections to the installation to make sure that all hardware is secure and tight.



By purchasing any item sold by Rough Country, LLC, the buyer expressly warrants that he/she is in compliance with all applicable, State, and Local laws and regulations regarding the purchase, ownership, and use of the item. It shall be the buyers responsibility to comply with all Federal, State and Local laws governing the sales of any items listed, illustrated or sold. The buyer expressly agrees to indemnify and hold harmless Rough Country, LLC for all claims resulting directly or indirectly from the purchase, ownership, or use of the items.