



## INSTALLATION INSTRUCTIONS

**MAKE:** Mini  
**MODEL:** Cooper S / JCW  
**YEAR:** 2015-2024  
**ENGINE:** L4-2.0L (t)

### Cat-Back Exhaust

49-36354-B

49-36354-P

49-36354-C

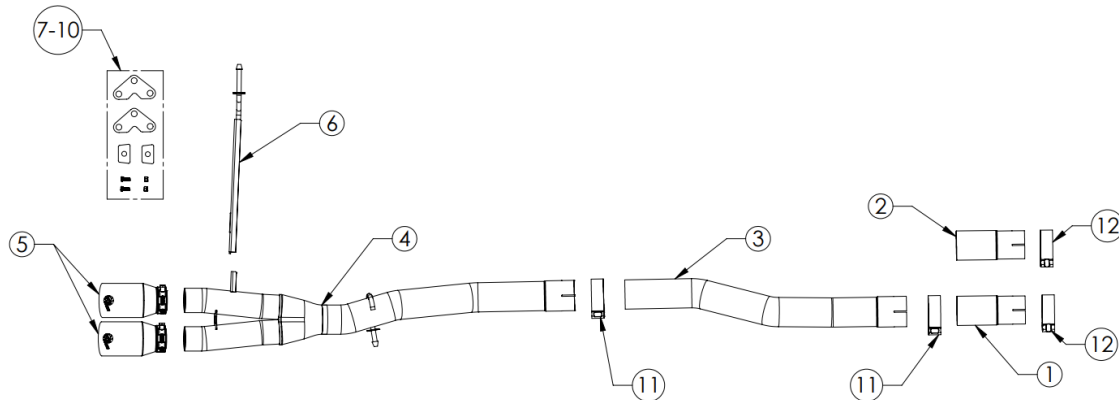

Item	Description	Part Number	Quantity
1.	S/A Tube, Adapter (JCW) 2.75 I.D.	05-244555	1
2.	S/A Tube, Adapter (S) 2.375 I.D.	05-244554	1
3.	S/A Tube, Front Pipe	05-244556	1
4.	S/A Tail pipe Assembly	05-244553	1
5.	EXH Tip 2-1/2 In x 3-1/2 Out x 7L Bolt-On Blk	49T25354-B07	2
5.	EXH Tip 2-1/2 In x 3-1/2 Out x 7L Bolt-On Pol	49T25354-P07	2
5.	EXH Tip 2-1/2 In x 3-1/2 Out x 7L Bolt-On CF	49T25354-C07	2
6.	S/A Bracket, Bracket Assembly	05-46573	1
7.	Screw, Serr Hex Flg: 1/4-20 x 3/4	03-50100	2
8.	Nut, Nylon Insert Lock: 1/4-20	03-50073	2
9.	Spacer, Crossmember F56/57 Front	05-46574	2
10.	Spacer, Crossmember F56/57 Rear	05-46575	2
11.	Clamp, Band: 3"	05-41055	2
12.	Clamp, Band: 2-3/4" SS	05-41160	2

**aFe POWER recommends professional installation on this product.** Thoroughly inspect the aFe POWER exhaust system to make sure there is no damage from shipping (if damage is noted, immediately contact aFe POWER customer service). Allow time for your vehicle to cool down prior to installation. When working on your vehicle proceed with caution. Wear protective safety equipment; eye goggles and gloves to ensure a safe installation.

Install band clamps to proper torque specifications of 40-45 ft-lb.





## INSTALLATION INSTRUCTIONS

**MAKE:** Mini  
**MODEL:** Cooper S / JCW  
**YEAR:** 2015-2024  
**ENGINE:** L4-2.0L (t)

### Cat-Back Exhaust

49-36354-B

49-36354-P

49-36354-C

1. **(Read Instructions prior to installation)** Secure vehicle on jack stands (Refer to your manual for specified jack stand positions).
2. Secure vehicle on jack stands (refer to your manual for specified jack stand positions).
3. For faster installation, spread out the parts of the exhaust alongside your vehicle as shown in the diagram above.
4. Secure the stock exhaust with jack/stands. When installed leave clamps slightly loose for adjustment.
5. Remove the center cross braces secured under the stock exhaust system.
6. Loosen the band clamp in front of the flex pipe securing the OE exhaust to the Down pipe
7. Remove the OE exhaust off the rubber hangers.
8. Remove the stock exhaust system.
9. Using visible ink, measure and mark a line 7" from the rear weld of the resonator **(As shown in figure A)** Then using a saw cut the OE Exhaust.
10. Install the cut OE front pipe (Cat and resonator section) back onto the rubber hangers and down pipe using the original band clamp.
11. Install a 2.75" provided band clamp onto the OE front pipe assembly and then install adapter (JCW 2.75"-3" or S 2.375"-3" model) onto the OE front pipe (When installing, leave clamps slightly loose for adjustment).
12. Install new front pipe assembly onto the Adapter.
13. Install a 3" band clamp onto the tailpipe assembly and then install the provided hanger bracket onto the tailpipe assembly, then install tailpipe.
14. Now re-install both cross braces with provided spacers rear brace 2 spacers with OE bolts, front brace 2 spacers and 6 new M8 bolts.
15. Ensure that all the components of the aFe POWER exhaust system are aligned and are at a safe clearance from all wires, hoses, brake lines, body parts, and tires.
16. Start from the front of the aFe exhaust system and evenly tighten all clamps and fasteners.
17. Start the vehicle and check for any leaks. If any leaks are found, determine the cause and repair as necessary.
18. Remove vehicle from jacks stands.
19. It is recommended to re-tighten all clamps and hardware after 50-100 miles.

